

THE ROAD TO WHYNOT

---

A collection of old records by William  
B. Booker, Anne Holberg Booker and Mrs.  
Jere Gunn.

---

BOOK 1-A-----THE BOOKERS OF WHYNOT  
BOOK 1-B-----THE BOOKERS OF CONEUCH/MONROE  
BOOK 2-----THE RAWSONS AND THE WHITES  
BOOK 3-----THE ALLENS OF WHYNOT  
BOOK 4-----THE BROWNS OF WHYNOT  
BOOK 5-----THE BASKINS  
BOOK 6-----THE HORTONS  
BOOK 7-----THE PAINEPS  
BOOK 8-----THE HOLBERGS, THE HERMANS, THE  
                  COVINGTONS  
BOOK 9-----THE ALLENS, THE FAUGHTONS, THE  
                  GUNNS, THE GREENS

PREFACE

This is a collection of old records by William B. Booker, Anne H. Booker and Mrs. Jere Gunn. This particular book is but a part of the collection which is divided into ten different smaller books and divided by families. Every effort has been made to attain the highest possible degree of accuracy; but since the attainment of perfection in an undertaking of this sort is difficult, if not impossible, we shall not deceive ourselves by believing that we have achieved it here. Instead, we humbly beg your tolerance for any errors that may appear.

The American Heritage Dictionary of the English Language defines "genealogy" as the study or investigation of ancestry and family histories and it defines "collection" as a group of objects or works to be seen, studied or kept together, an accumulation. After looking at both of these definitions, we decided to call this a "collection" instead of a "genealogy".

Information herein was taken from many sources.....a few of which have been acknowledged below:

Choctaw County Public Library  
Choctaw County Courthouse  
Sumter County Courthouse  
Lauderdale County Courthouse  
Meridian Public Library  
Virginia Ponds Kobler  
James T. Dawson

William B. Booker  
Anne Holberg Booker  
Mrs. Jere Gunn  
P.O. Box 72  
Linden, Alabama 36748

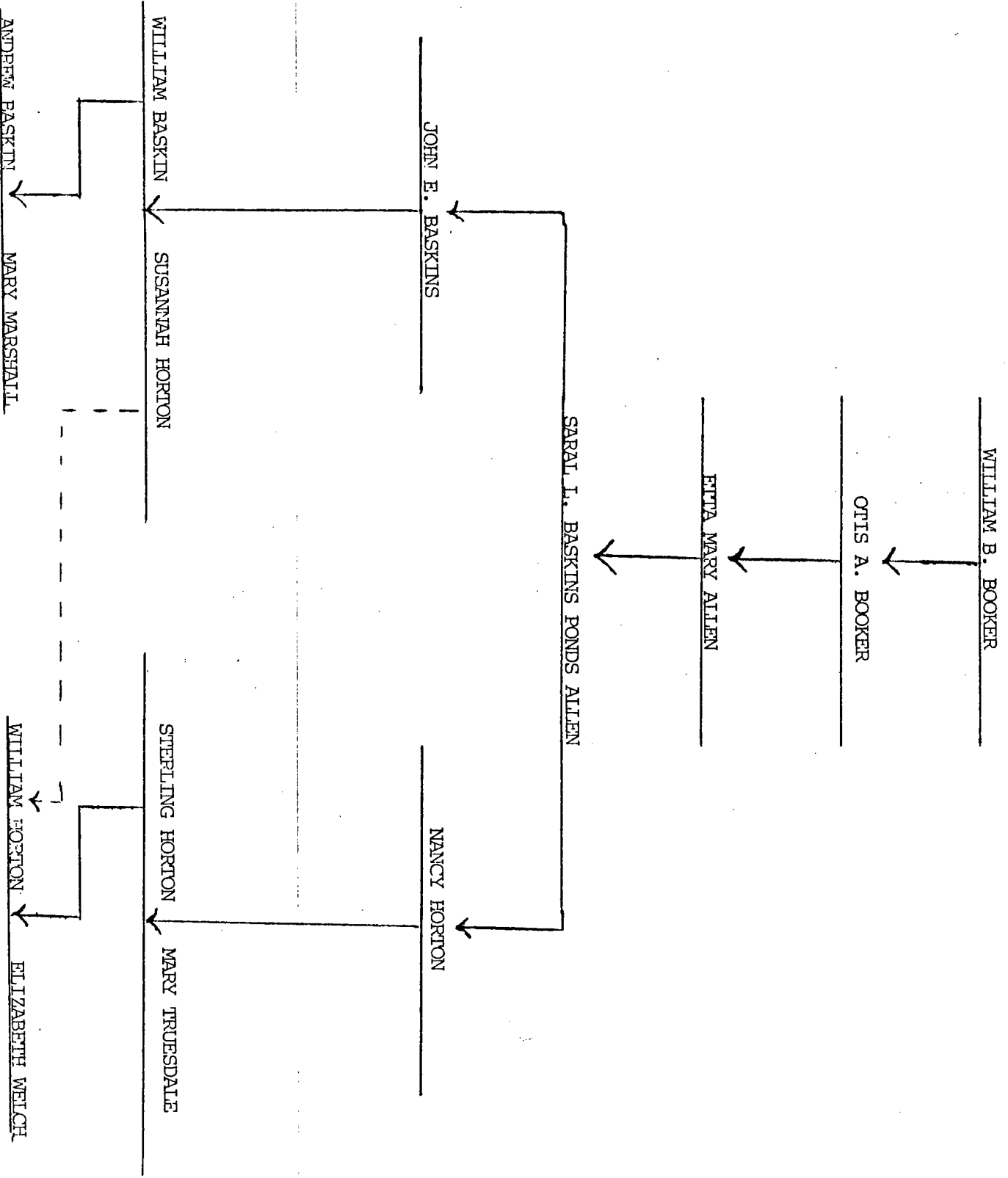

SUSANNAH HORTON WHO MARRIED WILLIAM BASKIN AND STERLING HORTON WHO MARRIED MARY TRUESDALE WERE BROTHER AND SISTER AND CHILDREN OF WILLIAM HORTON AND ELIZABETH WELCH. THE HORTONS ARE EXTENDED A FEW MORE GENERATIONS ON ANOTHER SHEET.

L TO R: MARVIN ALLEN/EDD ALLEN/  
MAG ALLEN/ANNIE ALLEN WELCH/  
ETTA ALLEN  
MARY PONDS/JOE PONDS/SARAH ALLEN/  
PRESTON PONDS/HASSIE PONDS





U: U & MINDI, MISS,

CHILDREN

MOTHER: NANCY HORTON (ID=17)

IDAU. (NO ID)

BENJAMIN FRANKLIN PONDS (ID=4)

B: 21 SEP 1859 @ CROCKETT CO., AL

M: 04 FEB 1884 TO MARTHA PENELOPE WELCH (ID=5) @ LAUDERDALE CO., MS

SEX: M

D: 13 MAY 1926 @ LAUDERDALE CO., MS

8 CHILDREN

FATHER: MILES WASHINGTON POND (ID=8)

MARTHA (NO ID)

JAMES WASHINGTON (NO ID)

PEARL L. HISSINGBOTHAM (NO ID)

LYDIA ANN (NO ID)

JESSE MILES (NO ID)

SARAH ESTELLE WOOD (NO ID)

WILLIAM EDWARD PONDS (ID=2)

B: 5 Dec 1849 @ Mechan, MS

~~1853-1854~~

M: 15 APR 1936 TO MARGOLIA SERENA DRYDEN (ID=3) @ CARLSBAD, NM

SEX: M

LIVING @ FLORENCE AL 35630

3 CHILDREN

MOTHER: MARTHA PENELOPE WELCH (ID=5)

ID9. MARTHA VIRGINIA PONDS (ID=1)

B: 08 OCT 1937 @ CARLSBAD, NEW MEXICO

2 MARRIAGES

M: 01 JUN 1957 TO BOBBY SANDLIN WOODRUFF (NO ID) @ FLORENCE, AL  
DIVORCED

R#1: 18 AUG 1974 TO JULIAN S. KOBLER (NO ID) @ HUNTSVILLE, AL

SEX: F

LIVING @ HUNTSVILLE AL

2 CHILDREN

MOTHER: MARGOLIA SERENA DRYDEN (ID=3)

GEORGE PONDS KOBLER (NO ID)

JONATHAN PONDS KOBLER (NO ID)

WILLIAM BURTON PONDS (ID=39)

B: 20 OCT 1940 @ CARLSBAD, NEW MEXICO

M: 03 JUN 1967 TO NANCY TONG (ID=41) @ GREENVILLE, SC

SEX: M

LIVING @ LANGLEY AFB VA 22665

2 CHILDREN

MOTHER: MARGOLIA SERENA DRYDEN (ID=3)

INEELY SUZANNE (NO ID)

MICHELLE LOUISE (NO ID)

SHARON LINDS PONDS (ID=40)

B: 14 AUG 1946 @ FLORENCE, AL

M: 1972 TO SPADOLINA UNDERWOOD (NO ID) @ FLORENCE, AL

WILLIAM ROXIE JONES (NO ID)

JOHN H. (NO ID)

JOSEPH W. (NO ID)

*Fonds*

WILLIAM R. (NO ID)

NANCY MAROLA DRYSEN (NO ID)

EDD E. (NO ID)

ANNIE WELCH (NO ID)

MINNIE (NO ID)

LETTA BOOKER (NO ID)

MARVIN (JACK) (NO ID)

MARY S. (NO ID)

ELIZABETH J. (NO ID)

NANCY E. (NO ID)

HENRIETTA C. (NO ID)

WILLIAM S. (NO ID)

MARGARET MISSOURI (NO ID)

JOHN W. (NO ID)

ANNA E. (NO ID)

SUSAN (NO ID)

SARAH (NO ID)

MISSOURI (NO ID)

MARGARET (NO ID)

ANDREW J. (NO ID)

MARGARET (NO ID)

Name of Your Husband (or Wife):  
Anne Holberg  
Date Born: Jan. 30, 1939  
Where Born: Meridian, MS

Name of Your Husband (or Wife):  
William Burr Booker  
Date Born: June 11, 1937  
Where Born: Meridian, MS  
Date Married: Dec. 29, 1957  
Where Married: Meridian, MS

Your Name: "Buddy"

Your Mother's Name:  
Lola Mae Rawson  
Date Born: .....  
Where Born: .....  
Date Died: .....  
Where Died: .....

Your Father's Name:  
Otis A. Booker  
Date Born: Nov. 4, 1897  
Where Born: Wymot, MS  
Date Married: Dec. 13, 1924  
Date Died: Aug. 29, 1965  
Where Died: Meridian, MS

Name of Your Mother's Mother:  
Eyle Mae White  
Date Born: .....  
Where Born: .....  
Date Married: .....  
Where Married: .....  
Date Died: .....  
Where Died: .....

Name of Your Mother's Father:  
Samuel Henderson Rawson  
Date Born: .....  
Where Born: .....  
Date Married: .....  
Where Married: .....  
Date Died: .....  
Where Died: .....

Name of Your Father's Mother:  
Amanda A. Carr  
Date Born: .....  
Where Born: .....  
Date Married: .....  
Where Married: .....  
Date Died: .....  
Where Died: .....

Name of Your Father's Father:  
George W. Rawson  
Date Born: .....  
Where Born: .....  
Date Married: .....  
Where Married: .....  
Date Died: .....  
Where Died: .....

Name of Your Great Grandmother:  
Sarah Lucasan Baskin  
Date Born: Jan. 21, 1836  
Where Born: Choctaw Co., AL  
Date Married: Apr. 15, 1926  
Date Died: .....

Name of Your Great Grandfather:  
Robert Ishiah Allen  
Date Born: 1834  
Where Born: Sumter Co., AL  
Date Married: 1865  
Date Died: .....

Name of Your Great Grandmother:  
Frances Brown  
Date Born: .....  
Where Born: .....  
Date Married: .....  
Where Married: .....  
Date Died: 1902

Name of Your Great Grandfather:  
Mark Henry (Jack) Booker  
Date Born: 1844  
Where Born: Monroe Co., AL  
Date Married: Mar. 29, 1866  
Date Died: .....

Name of Your Great Grandmother:  
Elizabeth Satcher  
Date Born: .....  
Where Born: .....  
Date Married: .....  
Where Married: .....  
Date Died: .....



1st marriage to Miles Washington Ponds..... he was killed in the war  
 Name of Your Husband (or Wife): Robert Isiah Allen  
 Date Born: 1834  
 Where Born: Sumter Co., AL

1. Sarah L. Baskin  
 Date Born: Jan. 21, 1836  
 Where Born: Lancaster Co., S.C.  
 Date Married: Jan. 1, 1855 (1)  
 Where Married: Choctaw Co., AL

2. John Baskin  
 Your Father's Name:  
 Date Born: Jan. 20, 1813  
 Where Born: Lancaster Co., S.C.  
 Date Married:  
 Date Died: Jan. 28, 1901  
 Where Died: Choctaw Co., AL

3. Nancy Horton  
 Your Mother's Name:  
 Date Born: Mar. 26, 1813  
 Where Born: Lancaster Co., S.C.  
 Date Died: Apr. 18, 1873  
 Where Died: Choctaw Co., AL

8. Andrew Baskin Date Born: 1730 Where Born: Ireland Date Married: 1752 Date Died: 1810 Name of Your Great Grandmother: Augusta Co., VA	9. Mary Marshall Date Born: 1830 Where Born: Lancaster Co., S.C. Date Married: Date Died: 1830 Name of Your Great Grandmother:	10. William Horton Date Born: 1755 Where Born: Lancaster Co., S.C. Date Married: Date Died: 1834 Name of Your Great Grandmother: Elizabeth Welsh	11. Elizabeth Welsh Date Born: 1866 Where Born: Lancaster Co., S.C. Date Died: Feb. 21, 1866 Where Died: Lancaster Co., S.C.	12. William Horton Date Born: 1755 Where Born: Lancaster Co., S.C. Date Married: Date Died: Jul. 18, 1834 Name of Your Great Grandmother: Elizabeth Welsh	13. Elizabeth Welsh Date Born: 1836 Where Born: Lancaster Co., S.C. Date Married: Sep. 29, 1836 Where Died: Crawford, GA	14. Name of Your Great Grandfather: Date Born: Where Born: Date Married: Date Died:	15. Name of Your Great Grandmother: Date Born: Where Born: Date Married: Date Died:
8. Andrew Baskin Date Born: 1730 Where Born: Ireland Date Married: 1752 Date Died: 1810 Name of Your Great Grandmother: Augusta Co., VA	9. Mary Marshall Date Born: 1830 Where Born: Lancaster Co., S.C. Date Married: Date Died: 1830 Name of Your Great Grandmother:	10. William Horton Date Born: 1755 Where Born: Lancaster Co., S.C. Date Married: Date Died: Jul. 18, 1834 Name of Your Great Grandmother: Elizabeth Welsh	11. Elizabeth Welsh Date Born: 1866 Where Born: Lancaster Co., S.C. Date Died: Feb. 21, 1866 Where Died: Lancaster Co., S.C.	12. William Horton Date Born: 1755 Where Born: Lancaster Co., S.C. Date Married: Date Died: Jul. 18, 1834 Name of Your Great Grandmother: Elizabeth Welsh	13. Elizabeth Welsh Date Born: 1836 Where Born: Lancaster Co., S.C. Date Married: Sep. 29, 1836 Where Died: Crawford, GA	14. Name of Your Great Grandfather: Date Born: Where Born: Date Married: Date Died:	15. Name of Your Great Grandmother: Date Born: Where Born: Date Married: Date Died:
4. William Baskin Name of Your Father's Father: Date Born: 1772 Where Born: Lancaster Co., S.C.	5. Susannah Horton Name of Your Father's Mother: Date Born: Where Born: Lancaster Co., S.C.	6. Sterling Horton Name of Your Mother's Father: Date Born: 1755 Where Born: Lancaster Co., S.C.	7. Mary Truesdale Name of Your Mother's Mother: Date Born: Where Born:	7. Mary Truesdale Name of Your Mother's Mother: Date Born: Where Born:	7. Mary Truesdale Name of Your Mother's Mother: Date Born: Where Born:	7. Mary Truesdale Name of Your Mother's Mother: Date Born: Where Born:	7. Mary Truesdale Name of Your Mother's Mother: Date Born: Where Born:

Name of Your Husband (or Wife):  
 Date Born: \_\_\_\_\_  
 Where Born: \_\_\_\_\_

Date Born: 1755  
 Where Born: Lancaster Co., S.C.  
 Date Married: \_\_\_\_\_  
 Where Married: Lancaster Co., S.C.

1 William Horton

Your Name:

Date Born: \_\_\_\_\_  
 Where Born: \_\_\_\_\_  
 Date Died: \_\_\_\_\_  
 Where Died: \_\_\_\_\_

3 Sarah Hull  
 Your Mother's Name:

Date Born: \_\_\_\_\_  
 Where Born: \_\_\_\_\_  
 Date Married: \_\_\_\_\_  
 Where Married: \_\_\_\_\_  
 Date Died: \_\_\_\_\_  
 Where Died: \_\_\_\_\_

Date Born: \_\_\_\_\_  
 Where Born: \_\_\_\_\_  
 Date Married: \_\_\_\_\_  
 Where Married: \_\_\_\_\_  
 Date Died: \_\_\_\_\_  
 Where Died: \_\_\_\_\_

Date Born: \_\_\_\_\_  
 Where Born: \_\_\_\_\_  
 Date Married: \_\_\_\_\_  
 Where Married: \_\_\_\_\_  
 Date Died: \_\_\_\_\_  
 Where Died: \_\_\_\_\_

5 Name of Your Father's Mother:  
 Date Born: \_\_\_\_\_  
 Where Born: \_\_\_\_\_  
 Date Married: \_\_\_\_\_  
 Where Married: \_\_\_\_\_  
 Date Died: \_\_\_\_\_  
 Where Died: \_\_\_\_\_

2 Joshua Horton  
 Your Father's Name:

Date Born: \_\_\_\_\_  
 Where Born: \_\_\_\_\_  
 Date Married: \_\_\_\_\_  
 Where Married: \_\_\_\_\_  
 Date Died: \_\_\_\_\_  
 Where Died: \_\_\_\_\_

Date Born: \_\_\_\_\_  
 Where Born: \_\_\_\_\_  
 Date Married: \_\_\_\_\_  
 Where Married: \_\_\_\_\_  
 Date Died: \_\_\_\_\_  
 Where Died: \_\_\_\_\_

4 Name of Your Father's Father:  
 Date Born: \_\_\_\_\_  
 Where Born: \_\_\_\_\_  
 Date Married: \_\_\_\_\_  
 Where Married: \_\_\_\_\_  
 Date Died: \_\_\_\_\_  
 Where Died: \_\_\_\_\_

15 Name of Your Great Grandmother:  
 Date Born: \_\_\_\_\_  
 Where Born: \_\_\_\_\_  
 Date Died: \_\_\_\_\_  
 Where Died: \_\_\_\_\_

7 Name of Your Mother's Mother:  
 Date Born: \_\_\_\_\_  
 Where Born: \_\_\_\_\_  
 Date Married: \_\_\_\_\_  
 Where Married: \_\_\_\_\_  
 Date Died: \_\_\_\_\_  
 Where Died: \_\_\_\_\_

14 Name of Your Great Grandfather:  
 Date Born: \_\_\_\_\_  
 Where Born: \_\_\_\_\_  
 Date Died: \_\_\_\_\_  
 Where Died: \_\_\_\_\_

13 Name of Your Great Grandmother:  
 Date Born: \_\_\_\_\_  
 Where Born: \_\_\_\_\_  
 Date Died: \_\_\_\_\_  
 Where Died: \_\_\_\_\_

6 Name of Your Mother's Father:  
 Date Born: \_\_\_\_\_  
 Where Born: \_\_\_\_\_  
 Date Married: \_\_\_\_\_  
 Where Married: \_\_\_\_\_  
 Date Died: \_\_\_\_\_  
 Where Died: \_\_\_\_\_

12 Name of Your Great Grandfather:  
 Date Born: \_\_\_\_\_  
 Where Born: \_\_\_\_\_  
 Date Died: \_\_\_\_\_  
 Where Died: \_\_\_\_\_

11 Name of Your Great Grandmother:  
 Date Born: \_\_\_\_\_  
 Where Born: \_\_\_\_\_  
 Date Married: \_\_\_\_\_  
 Where Married: \_\_\_\_\_  
 Date Died: \_\_\_\_\_  
 Where Died: \_\_\_\_\_

10 Name of Your Great Grandfather:  
 Date Born: \_\_\_\_\_  
 Where Born: \_\_\_\_\_  
 Date Married: \_\_\_\_\_  
 Where Married: \_\_\_\_\_  
 Date Died: \_\_\_\_\_  
 Where Died: \_\_\_\_\_

9 Name of Your Great Grandmother:  
 Date Born: \_\_\_\_\_  
 Where Born: \_\_\_\_\_  
 Date Married: \_\_\_\_\_  
 Where Married: \_\_\_\_\_  
 Date Died: \_\_\_\_\_  
 Where Died: \_\_\_\_\_

8 Name of Your Great Grandfather:  
 Date Born: \_\_\_\_\_  
 Where Born: \_\_\_\_\_  
 Date Married: \_\_\_\_\_  
 Where Married: \_\_\_\_\_  
 Date Died: \_\_\_\_\_  
 Where Died: \_\_\_\_\_

8 Name of Your Father's Father:  
 Date Born: \_\_\_\_\_  
 Where Born: \_\_\_\_\_  
 Date Married: \_\_\_\_\_  
 Where Married: \_\_\_\_\_  
 Date Died: \_\_\_\_\_  
 Where Died: \_\_\_\_\_

8 Name of Your Great Grandfather:  
 Date Born: \_\_\_\_\_  
 Where Born: \_\_\_\_\_  
 Date Married: \_\_\_\_\_  
 Where Married: \_\_\_\_\_  
 Date Died: \_\_\_\_\_  
 Where Died: \_\_\_\_\_

Your Name:

1. Joshua Ensign Horton  
Date Born: ..... 1669  
Where Born: Southold, N.Y.  
Date Married: ..... D. 1744  
Where Married: Southold, N.Y.

Name of Your Husband (or Wife):

Elizabeth Grover  
Date Born: .....  
Where Born: .....

Your Father's Name:

2. Joshua Horton  
Date Born: ..... 1643  
Where Born: Southold, N.Y.  
Date Married: ..... 1667  
Date Died: ..... June 17, 1729  
Where Died: Southold, N.Y.

Your Mother's Name:

3. Mary Tuthill  
Date Born: ..... 1649  
Where Born: .....  
Date Died: ..... June 25, 1729  
Where Died: .....

Name of Your Father's Father:

4. Barnabas Horton  
Date Born: ..... July 13, 1600  
Where Born: Mowsley, England  
Date Married: .....  
Date Died: ..... July 13, 1680  
Where Died: Southold, N.Y.

Name of Your Father's Mother:

5. Mary Langston  
Date Born: .....  
Where Born: .....  
Date Died: .....  
Where Died: .....

Name of Your Mother's Father:

6. Henry Tuthill  
Date Born: ..... June 28, 1612  
Where Born: Norfolk, England  
Date Married: .....  
Date Died: ..... 1650  
Where Died: Southold, N.Y.

Name of Your Mother's Mother:

7. Bridget  
Date Born: .....  
Where Born: .....  
Date Died: .....  
Where Died: .....

Name of Your Great Grandfather:

8. ....  
Date Born: .....  
Where Born: .....  
Date Married: .....  
Date Died: .....

Name of Your Great Grandmother:

9. ....  
Date Born: .....  
Where Born: .....  
Date Died: .....

Name of Your Great Grandfather:

10. ....  
Date Born: .....  
Where Born: .....  
Date Married: .....  
Date Died: .....

Name of Your Great Grandmother:

11. ....  
Date Born: .....  
Where Born: .....  
Date Died: .....

Name of Your Great Grandfather:

12. Henry Tuthill  
Date Born: ..... 1580  
Where Born: Hingham, England  
Date Married: .....  
Date Died: .....

Name of Your Great Grandmother:

13. Alice Cooch  
Date Born: .....  
Where Born: .....  
Date Died: .....

Name of Your Great Grandfather:

14. ....  
Date Born: .....  
Where Born: .....  
Date Married: .....  
Date Died: .....

Name of Your Great Grandmother:

15. ....  
Date Born: .....  
Where Born: .....  
Date Died: .....

Form 84 Copyright by the Everton Publishing, Inc., P.O. Box 500, St. Utah 84321, publishers of THE GENEALOGICAL HELPER. Send for a free catalogue with lists and full descriptions of many genealogical aids.

Address \_\_\_\_\_ Person No. \_\_\_\_\_ on this part is the same  
 City, State \_\_\_\_\_ person as No. \_\_\_\_\_ on chart No. \_\_\_\_\_ Chart No. 1

Date \_\_\_\_\_

a. Date of Birth  
 p.b. Place of Birth  
 m. Date of Marriage  
 p.m. Place of Marriage  
 d. Date of Death  
 p.d. Place of Death

4 Benjamin Franklin Fords  
 b. 21 September 1858 (Father of No. 2)  
 p.b. Choctaw Co., Alabama  
 m. 4 February 1884  
 p.m. Lauderdale Co., Miss.  
 d. 13 May 1926  
 p.d. Neehan, Mississippi

8 Miles W. Fond  
 b. 14 Sept. 1924 (Father of No. 4, 11)  
 p.b. North Carolina  
 m. (1850-1858), 1 Jan. 1855  
 p.m. Choctaw Co., Alabama  
 d. Close of Civil War  
 p.d. Unknown (Rechtree, Ala. cemetery)  
 9 Sarah Baskin  
 b. 21 January 1836 (Mother of No. 4, 12)  
 p.b. Lancaster Co., S. C.  
 d. 15 April 1926  
 p.d. Whynot, Miss.

2 William Edd Fords  
 b. 5 December 1899 (Father of No. 11)  
 p.b. Neehan, Mississippi  
 m. 15 April 1936  
 p.m. Carlsbad, New Mexico  
 d.  
 p.d.

5 Martha Penelope Welch  
 b. 24 August 1862 (Mother of No. 2)  
 p.b. Lauderdale Co., Miss.  
 d. 1 December 1945  
 p.d. Meridian, Miss.

10 J. M. Welch  
 b. 1854 (Father of No. 5)  
 p.b. Georgia  
 m.  
 p.m. August 1862  
 d. Lauderdale Co., Miss.

11 Martha Boswell  
 b. 20 January 1834 (Mother of No. 5, 14)  
 p.b. Alabama  
 d. 22 January 1884  
 p.d. Lauderdale Co., Miss.

Martha Virginia Fords Woodruff Kobler  
 b. 8 October 1937  
 p.b. Carlsbad, New Mexico  
 m. 1 June 1957  
 p.m. Florence, Alabama  
 d.  
 p.d.

\* 18 Aug 1974  
 Huntsville, Ala.

6 David Thomas Dryden  
 b. 6 May 1865 (Father of No. 3)  
 p.b. Shelbyville, Tennessee  
 m. 15 December 1889  
 p.m. Chapel Hill, Tennessee  
 d. 6 November 1958  
 p.d. Birmingham, Alabama

12 Alexander Barton Dryden  
 b. Dec. 1840 (Father of No. 6, 13)  
 p.b. Bedford Co., Tennessee  
 m.  
 p.m. Bedford Co., Tennessee  
 d. June 23, 1867  
 p.d. St. Francis River, Ark.

3 Magnolia Serena Dryden  
 b. 17 February 1905 (Mother of No. 11)  
 p.b. Lewisburg, Tennessee  
 d.  
 p.d.

13 Lydia Prudence Graves  
 b. July 17, 1847 (Mother of No. 6, 13)  
 p.b. Bedford Co., Tennessee  
 d. Jan 1925  
 p.d. Lawrenceburg, Tennessee

7 Virginia Ann Manire  
 b. 22 January 1869 (Mother of No. 3)  
 p.b. Chapel Hill, Tennessee  
 d. 17 October 1942  
 p.d. Leoma, Tennessee

14 Edmond Henry Manire  
 b. 1820/21 (Father of No. 7, 17)  
 p.b. Williamson Co., Tenn.  
 m. 31 March 1847  
 p.m. Rutherford Co., Tenn.  
 d. April 1887  
 p.d. Marshall Co., Tenn.

Bobber Sandlin Woodruff  
 b. 22 January 1937 (No. 1)  
 p.b. Danville, Alabama  
 d. divorced Oct. 4, 1972  
 p.d.  
 \* Julian S. Kobler  
 b. 1 Jan 1920  
 p.b. N.Y.C., N.Y.

15 Elizabeth Jane Swisher  
 b. 30 December 1834 (Mother of No. 7, 18)  
 p.b. Rutherford Co., Tenn.  
 d.  
 p.d. Marshall Co., Tenn.

FOUR GENERATION ANCESTOR CHART

Name of Compiler Virginia Jones Koblner  
 Address 5802 Macon Drive  
2308 Callatin St #2

Person No. 1 on this chart is the same person as No. 1 on chart No. 1.

Chart No. 12

City, State Huntsville, Alabama 35802

Date June 1968

b. Date of Birth  
 p.b. Place of Birth  
 m. Date of Marriage  
 p.m. Place of Marriage  
 d. Date of Death  
 p.d. Place of Death

4	William Baskin	
	b.	c. 1772 (Father of No. 2)
	p.b.	S.C.
8	Andrew Baskin	
	b.	c. 1730
	m.	Ireland before 1260
9	Mary Marshall	
	d.	c. 1800
	p.d.	Lancaster Co., S.C.

(Mother of No. 4, 8, 9)  
 Cont. on chart No. 12

2	John E. Baskin	
	b.	20 Jan. 1813
	p.b.	Lancaster Co., S. C.
5	Susannah Horton	
	b.	
	d.	Will probated 21 Feb. 1866
10	William Horton	
	b.	
	p.b.	

(Father of No. 2, 5)  
 Cont. on chart No. 12

6	Nancy Horton	
	b.	26 March 1813
	p.b.	S.C.
11	William Horton	
	b.	
	p.b.	

(Mother of No. 3)  
 Cont. on chart No. 12

*My Great Grandmother*

Sarah L. Baskin  
 b. 21 Jan. 1836  
 p.b. Lancaster Co., S.C.  
 m. 1 Jan. 1855  
 p.m. Choctaw Co., Ala.  
 d. 15 April 1926  
 p.d. Lauderdale Co., Miss.

7	Miles W. Pond	
	b.	14 Sept. 1822
	d.	1865
12	William Horton	
	b.	
	p.b.	
13	Nancy Horton	
	b.	26 March 1813
	p.b.	S.C.
14	Miles W. Pond	
	b.	14 Sept. 1822
	d.	1865

(Father of No. 6, 12, 13, 14)  
 Cont. on chart No. 12

Miles W. Pond  
 h. 14 Sept. 1822 (Spouse of No. 1)  
 N.C.  
 c. 1865  
 p.d. Peachtree, Ala.  
 Bueter Co.

15	Miles W. Pond	
	b.	14 Sept. 1822
	d.	1865
16	Miles W. Pond	
	b.	14 Sept. 1822
	d.	1865

(Mother of No. 1, 15)  
 Cont. on chart No. 12

**FAMILY GROUP NO.**

Trans Information Obtained From:

Husband's Full Name **John Baskins**

Day Month Year City, Town or Place County of State or Country Add. Info. on Husband

Birth 20 Jan 1813 Lancaster District, S. C.

Chr'd 10 Sept. 1835 " " " "

Mar. 10 Sept. 1835 " " " "

Death 28 Jan 1901 Choctaw Co., Ala.

Burial Shiloh, Choctaw Co., Ala.

Places of Residence ~~Shiloh~~ Church Affiliation Military Rec.

Occupation Church Affiliation

Other wives, if any, No. (1) (2), etc. Make separate sheet for each mar.

His Father **William Baskin** Mother's Maiden Name **Susannah Horton**

Wife's Full Maiden Name **Nancy Horton**

Wife's Date Day Month Year City, Town or Place County or Province, etc. State or Country Add. Info. on Wife

Birth 26 Mar 1813 Lancaster Dist., S. C.

Chr'd 18 Apr 1873 Choctaw Co., Ala.

Death Shiloh, Choctaw Co., Ala.

Burial Shiloh, Choctaw Co., Ala.

Places of Residence Church Affiliation

Occupation if other than Housewife

Other husbands, if any, No. (1) (2), etc. Make separate sheet for each mar.

Her Father Mother's Maiden Name

Date Children's Names in Full (Attribute in order of birth) Date Day Month Year City, Town or Place County or Province, etc. State or Country Add. Info. on Children

1 **Celia Angeline**

Full Name of Spouse

Birth 10 Aug. 1834 Lancaster Dist., S. C.  
Mar.  
Death 9 Jan 1872 Choctaw Co., Ala.  
Burial Shiloh, Choctaw Co., Ala.

2 **Sarah L. Pond**

Full Name of Spouse  
Miles W. Allen  
Robert Allen

Birth 21 Jan 1836 Lancaster Dist., S. C.  
Mar. 1 Jan 1855 Choctaw Co., Ala.  
Death 15 Apr 1926 Lauderdale Co., Miss.  
Burial Bethany Cem., Wynot, Miss.

**Mary Susan**

Full Name of Spouse

Mar.  
Death 21 Dec. 1841 Choctaw Co., S. C.  
Burial Shiloh, Choctaw Co., Ala.

4 **Elizabeth Jane**

Full Name of Spouse

Birth 7 Sept. 1839 Lancaster Dist., S. C.  
Mar.  
Death 15 Sept. 1855 Choctaw Co., Alabama  
Burial Shiloh, Choctaw Co., Ala.

5 **Nancy Elmina**

Full Name of Spouse

Mar.  
Death 2 May 1842 Choctaw Co., Alabama  
Burial

6 **Henrietta Clay**

Full Name of Spouse

Birth 15 Mar 1844 Choctaw Co., Alabama  
Mar.  
Death

7 **William Sterling**

Full Name of Spouse

Birth 24 Dec. 1845 Choctaw Co., Alabama  
Mar.  
Death

8 **Margaret Missouri**

Full Name of Spouse

Mar.  
Death 9 June 1847 " "  
Burial Shiloh, Choctaw Co., Alabama

**John Thomas**

Full Name of Spouse

Mar.  
Death 24 Sept 1850 " "  
Burial Shiloh, Choctaw Co., Ala.

10 **Anna Eliza**

Full Name of Spouse

Mar.  
Death  
Burial Shiloh, Choctaw Co., Alabama

This Information Obtained From:

Record's Day Month Year City, Town or Place County or Province, etc. State or Country Add. Info. on Husband  
 14 Sept 1822 N. C.

Christnd  
 Mar. 1 Jan 1855 Choctaw Co., Ala.  
 Death 1864 Peachtree, Ala.  
 Burial  
 Places of Residence  
 Occupation Church Affiliation Military Rec.  
 Over 100's if any No. (1) (2) etc.  
 Mar.'s respective street for each mar.  
 His Father Mother's Maiden Name

Wife's Full Maiden Name Sarah L. Baskin

Wife's Day Month Year City, Town or Place County or Province, etc. State or Country Add. Info. on Wife  
 Birth 21 Jan 1836 Lancaster Dist., S. C.  
 Chr. nd  
 Death 15 April 1926 Lauderdale Co., Miss.  
 Burial Bethany Cem., Whynot, Miss.  
 Places of Residence  
 Occupation if other than Housewife Church Affiliation

Over 100's if any No. (1) (2) etc.  
 Mar.'s respective street for each mar.  
 Her Father John Baskin Mother's Maiden Name Nancy Horton

Children's Name in Full (Arrange in order of birth) Children's Day Month Year City, Town or Place County or Province, etc. State or Country Add. Info. on Children  
 Date Her Father John Baskin Mother's Maiden Name Nancy Horton

1. Birth 10 Feb 1856 Choctaw Co., Ala. female

Full Name of Spouse  
 Mar.  
 Death  
 Burial

2 Benjamin Franklin  
 Full Name of Spouse  
 Mar. 4 Feb 1884 Lauderdale Co., Miss.  
 Death 15 May 1926 Neehan, Lauderdale, Miss.  
 Burial Goodwater Bapt. Chr., Neehan

3 Martha Renelope Wel  
 Full Name of Spouse  
 Mar. 13 Sept 1860 Choctaw Co., Alabama  
 Death  
 Burial No further record

4 John H.  
 Full Name of Spouse  
 Mar.  
 Death  
 Burial No further record

5 Joseph W.  
 Full Name of Spouse  
 Mar. 13 Mar 1890  
 Death 13 June 1953 Whynot, Miss.  
 Burial 15 June 1953 Bethany Cem., Whynot, Miss.

6 Mary Ann Goodwin  
 Full Name of Spouse  
 Mar.  
 Death  
 Burial

7 Full Name of Spouse  
 Mar.  
 Death  
 Burial

8 Full Name of Spouse  
 Mar.  
 Death  
 Burial

9 Full Name of Spouse  
 Mar.  
 Death  
 Burial

10 Full Name of Spouse  
 Mar.  
 Death  
 Burial

Full Name of Spouse  
 Mar.  
 Death  
 Burial

Full Name of Spouse  
 Mar.  
 Death  
 Burial

Full Name of Spouse  
 Mar.  
 Death  
 Burial

15

FAMILY GROUP NO.

Husband's Full Name BENJAMIN FRANKLIN FONGS

This Information Obtained From:

Birth 21 Sept 1858 City, Town or Place Shoctor Co., Ala County Ala State or Country Ala Add. Info. on Husband

Chr'd 4 Feb 1884 City, Town or Place Lauderdale Co., Miss. County Miss. State or Country Miss. Add. Info. on Husband  
 Death 12 May 1926 City, Town or Place Heehan County " State or Country " Add. Info. on Husband  
 Burial Goodwater Bapt. Chr., Meenan, Miss.

Places of Residence Goodwater Bapt. Chr., Meenan, Miss.  
 Church Affiliation Church Affiliation Military Rec.

Other wives, if any: No. (1) (2) etc. None  
 His Father Miles W. Pond Mother's Maiden Name Sarah L. Boskan

Wife's Full Maiden Name Yartha Penelope Welch

Birth 24 Aug 1862 City, Town or Place Lauderdale Co., Miss County or Province, etc. Miss State or Country Miss Add. Info. on Wife

Chr'd 1 Dec 1945 City, Town or Place Meridian, County or Province, etc. " State or Country " Add. Info. on Wife  
 Death 1 Dec 1945 City, Town or Place Meridian, County or Province, etc. " State or Country " Add. Info. on Wife  
 Burial Goodwater Bapt Chr, Meenan, Miss

Places of Residence Goodwater Bapt Chr, Meenan, Miss  
 Occupation if other than Housewife Church Affiliation

Her Father J. W. Welch Mother's Maiden Name Yartha Boswell

Children's Data  
 Birth 14 Feb 1885 City, Town or Place Lauderdale Co., Miss County or Province, etc. Miss State or Country Miss Add. Info. on Children  
 Mar. 2 Apr 1905 City, Town or Place Lauderdale Co., Miss County or Province, etc. Miss State or Country Miss Add. Info. on Children  
 Death 14 July 1959 City, Town or Place Lauderdale Co., Miss County or Province, etc. Miss State or Country Miss Add. Info. on Children  
 Burial Lauderdale Co., Miss

1 Mattie  
 Full Name of Spouse B. M. Orel and W. O. Tress  
 Birth 20 July 1887 City, Town or Place Lauderdale Co., Miss County or Province, etc. Miss State or Country Miss Add. Info. on Children  
 Mar. 24 Dec 1916 City, Town or Place Lauderdale Co., Miss County or Province, etc. Miss State or Country Miss Add. Info. on Children  
 Death 12 Dec 1950 City, Town or Place Tullos, Louisiana County or Province, etc. " State or Country " Add. Info. on Children  
 Burial "

2 James Washington  
 Full Name of Spouse Mary Allie New  
 Birth 3 May 1889 City, Town or Place Lauderdale Co., Miss County or Province, etc. Miss State or Country Miss Add. Info. on Children  
 Mar. Jan City, Town or Place " County or Province, etc. " State or Country " Add. Info. on Children  
 Death 10 May 1962 City, Town or Place " County or Province, etc. " State or Country " Add. Info. on Children  
 Burial "

3 Pearl L.  
 Full Name of Spouse E. Monroe Higginbotham  
 Birth 2 Dec 1891 City, Town or Place Lauderdale Co., Miss County or Province, etc. Miss State or Country Miss Add. Info. on Children  
 Mar. 5 Jan City, Town or Place " County or Province, etc. " State or Country " Add. Info. on Children  
 Death 2 Apr 1961 City, Town or Place " County or Province, etc. " State or Country " Add. Info. on Children  
 Burial "

4 Lydia Ann  
 Full Name of Spouse Levi J. Peavy  
 Birth 5 Aug 1891 City, Town or Place Lauderdale Co., Miss County or Province, etc. Miss State or Country Miss Add. Info. on Children  
 Mar. 4 June 1941 City, Town or Place Lauderdale Co., Miss County or Province, etc. Miss State or Country Miss Add. Info. on Children  
 Death 4 June 1941 City, Town or Place Lauderdale Co., Miss County or Province, etc. Miss State or Country Miss Add. Info. on Children  
 Burial "

5 Jesse Milles  
 Full Name of Spouse Madeline Kelly  
 Birth 18 Aug 1897 City, Town or Place Lauderdale Co., Miss County or Province, etc. Miss State or Country Miss Add. Info. on Children  
 Mar. 5 June 1926 City, Town or Place Jackson, Miss. County or Province, etc. Miss State or Country Miss Add. Info. on Children  
 Death 5 Dec 1956 City, Town or Place Vicksburg, Miss County or Province, etc. Miss State or Country Miss Add. Info. on Children  
 Burial Cedar Hill Cem., Vicksburg, Miss.

6 Sarah Estelle  
 Full Name of Spouse Robert Erwin Wood  
 Birth 27 Sept 1902 City, Town or Place Lauderdale Co., Miss County or Province, etc. Miss State or Country Miss Add. Info. on Children  
 Mar. Ft. Sill, Comanche, Okla. City, Town or Place Lauderdale Co., Miss County or Province, etc. Miss State or Country Miss Add. Info. on Children  
 Death 27 Sept 1902 City, Town or Place Lauderdale Co., Miss County or Province, etc. Miss State or Country Miss Add. Info. on Children  
 Burial "

7 Lillian Roxie  
 Full Name of Spouse Morris Marne Jones  
 Birth 5 Dec 1899 City, Town or Place Lauderdale Co., Miss County or Province, etc. Miss State or Country Miss Add. Info. on Children  
 Mar. 15 Apr 1956 City, Town or Place Carlsbad, eddy, New Mexico County or Province, etc. Miss State or Country Miss Add. Info. on Children  
 Death 5 Dec 1899 City, Town or Place Lauderdale Co., Miss County or Province, etc. Miss State or Country Miss Add. Info. on Children  
 Burial "

8 William Edward  
 Full Name of Spouse Magnolia Serena Drockertal  
 Birth 5 Dec 1899 City, Town or Place Lauderdale Co., Miss County or Province, etc. Miss State or Country Miss Add. Info. on Children  
 Mar. 15 Apr 1956 City, Town or Place Carlsbad, eddy, New Mexico County or Province, etc. Miss State or Country Miss Add. Info. on Children  
 Death 5 Dec 1899 City, Town or Place Lauderdale Co., Miss County or Province, etc. Miss State or Country Miss Add. Info. on Children  
 Burial "

Full Name of Spouse "  
 Birth " City, Town or Place " County or Province, etc. " State or Country " Add. Info. on Children  
 Death " City, Town or Place " County or Province, etc. " State or Country " Add. Info. on Children  
 Burial "

Full Name of Spouse "  
 Birth " City, Town or Place " County or Province, etc. " State or Country " Add. Info. on Children  
 Death " City, Town or Place " County or Province, etc. " State or Country " Add. Info. on Children  
 Burial "



The writer has been gathering Baskin data for many years. New information keeps coming in making corrections and additions necessary. This report is on ANDREW BASKIN of Kershaw and Lancaster Counties, South Carolina. Most of the data have been published in The Baskin-Baskins Family 1963. The late Dr. Eldridge Baskin of Florence, S.C. supplied many names and dates. Help has been received from: Mrs Ben C Hough, Mrs H C Floyd, Wade Ruddle, Mrs Hazel P Jones, Mrs Alma D Croxton, Mrs Mamie Rice, J W Baskins, Mrs A P Guess, R R B Shaw, Mrs H W McKay, Mrs R C Stevens, Senator W P Baskin, Miss Mary W Stewart, Mrs H G Womack, Mrs Marlin Withers.

Other sources have been:

Chalkley: Chronicles of the Scotch-Irish, Augusta Co, Va  
 Court Records of Kershaw and Lancaster Cos, S C  
 Land and Military Records, Archives Dept, Columbia, S C  
 Andrew Baskin was born about 1730, probably in Ireland. He died about 1800 in Lancaster County, South Carolina.

Augusta County, Virginia

The first record of Andrew Baskin is Nov 15-1752 in Augusta Co, when he was appointed one of 22 (probably young) men to "clear and keep in repair a road from James Givins Mill to the road over Woods New Gap at the foot of the mountain". Andrew must have lived in the part of Augusta shown in this map:

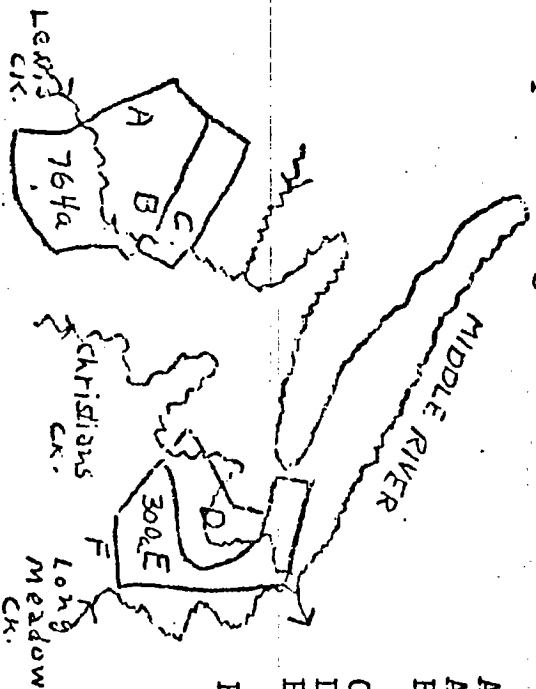

- AB bought by John Pickens 1740
- A sold to Anthony Strother 1753
- B sold to William Baskin 1747
- C sold to George Crawford 1765
- D sold to James Lessley 1740
- E sold to James Lessley Jr 1762
- F sold to John Pickens 1749
- sold to William Bell 1754
- land of Widow Baskin 1749, 54, 59
- land of Thomas Baskin 1761
- title must have gone to Thomas
- about 1759, year he was married
- first of William's sons to be married

The next record of Andrew Baskin is Mar 21-1753 when he with John Pickens and Robert Craven witnessed a deed from John and Sarah Stephenson to Archibald Houston. This may give a clue as to some of Andrew's relatives. Robert Craven, a justice, probably wrote the deed. Stephensons were not neighbors. Was Andrew related to Pickens or Stephenson? The land of Pickens adjoined both Widow Baskin and William Baskin. About 1754/55 Andrew Baskin and John Pickens went south to the NC-SC border. In 1764 John Pickens applied for land near Andrew Baskin before moving to Abbeville Co, S C - where there other Baskins. Andrew is a Pickens, but not a Baskin name.

The Baskin family originated in Ireland. In 1734 William and John Baskin were living in Chester Co, Pa. In 1754 these Baskins were in (now) Perry and Dauphin Cos., Pa: (probably sons of John)

James with 2 sons, William with 3, Francis with 1, Thomas. In Augusta Co, Va were these in 1754:

William with 6 sons, Andrew (single), Widow of Robert.

By 1774 the Baskin distribution was:

Pa: James. William and Francis were dead. Thomas was gone or dead.

Va: Charles, son of William.

SC - Kershaw Co: Andrew

Abbeville Co: James, William, Hugh - sons of William of Va.

(Other sons of Wm dead or in Va.) John, son of William of Pa. Charleston: William, minor son of Thomas who died 1770, leaving sister, Elizabeth Stephenson of Pa. (Could Andrew have been related? Note, Stephenson in Augusta Co, Va.)

The relation of Andrew to the others is unknown. He may have been a nephew of William of Va. If he was a son of Robert, who was dead Feb 28-1749, the name Robert is not found in his children or grandchildren. The estate of Robert was administered by William Baskin, settlement Nov 29-1750 in Augusta Co. William Baskin and John Pickens were together in Pa, Va and SC. They with their neighbor, James Lessley, petitioned for land in South Carolina in 1746. See page 10.

#### South Carolina

The first record of Andrew Baskin is in the Hanging Rock section near the Kershaw-Lancaster Co line, where on Dec 2-1761 he had surveyed 150 acres on the south prong of Little Lynches Creek. See map. The land had been taken out Nov 6-1755 in the name of William Delcack and acquired by Baskin before 1761. He was married in 1759 or earlier for his daughter, Isabella, was born Oct 20-1760. Andrew's wife was likely Mary Marshall. Her father may have been William. In 1769 (Mar 22) Andrew Baskin's name appears in the Augusta Co records, when he received money "on Bigham's account" from the John Trimble estate. It would be interesting to know why. John Trimble had been killed by the Indians in Augusta Co about 1763.

Andrew Baskin was one of a group of Regulators who were pardoned by the Crown Oct 31-1771. (Vol PP, p 46, S C Archives, Misc Records) Richard M Brown has written an informative book on The South Carolina Regulators (Harvard Univ Press 1963). He lists 121 Regulators who "were ambitious Back Country property holders determined to end lawlessness, to discipline the lower people, and to establish an orderly society". This movement was strongest 1767-69, just before the Regulators were established. A substantial number of the Regulators rose into the leading man category. Andrew Baskin was one. He had enemies as men of affairs do. "In 1790 Robert Dumville accused him of extortion and neglect of duties as magistrate. The case of State vs Andrew Baskin was placed on the docket, but in the April 1791 term the Attorney General entered a nolle prosequi and the matter ended." (Brown)

Baslin was granted additional 150 a near the 1761 tract in 1784 (100 acres) and in 1785 (640 acres). He helped pay for this land by using money obtained for military services. This land was likely in Kershaw Co, just southeast of the town of Kershaw. The record of the deed of the part sold in 1797 is in Kershaw Co. He sold the land east of the creek to his son, James. His son, John, got the land to the west. A third son, William, was granted 150 a. in Lancaster Co in the waters of Bear Creek in south cen- may have been named William's death in acres. He had bought Lynches in 1814 and

150 a  
1 Dec 1761  
(6 Nov 1755)

100 a  
28 Apr 85

100 a  
30 Jul 84

460 a  
28 Apr 85

150 on Bear Cr 1815.  
likely on  
Creek, Baskins  
tral Lancaster Co  
after William, At  
1830 he owned 930  
680 on Little  
1794,

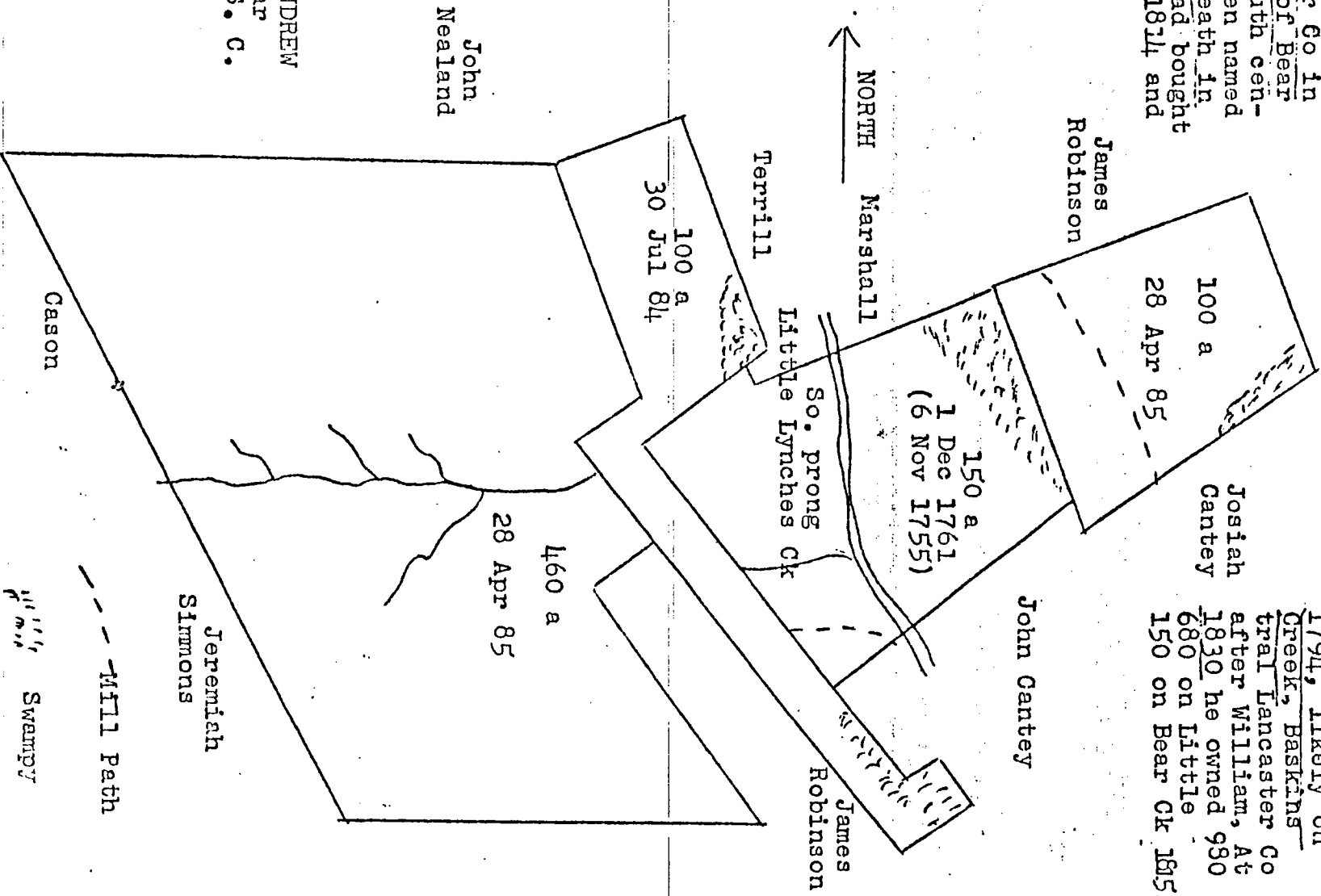

LAND OF ANDREW  
BASKIN near  
KERSHAW, S. C.

John  
Nealand

Andrew Baskin's Revolutionary record is fairly complete:

To 40 days service done under the Commd. of Coll. Jno. Marshal from the 10th day of Octr. 1779 to the 18th day of Novr. following as Horseman at 20/- pr day . . . .	40	0	0
To 23 days service done under the Command of Lieut. Coll. Eli Kershaw at 10/- pr day . . . . .	11	10	0
To 60 days service done under the Commd. of Coll. John Marshal as Horseman at 20/- pr day from the 1st day of Novr. 1780 to the last day of Decr. following . . . .	60	10	0
	Old currency	112	0
	New currency	15	18
		6	

Certified by John Marshal, Coll. New currency  
 15 Dec 1780 Recd. of Mr. Andrew Baskin, For the Use of a Detachment of Troops, under my command, at Grey's Mill, in Camden Dist. the Quantity of 40 Bu. corn. John Marshal, Coll. Militia  
 7 Mar 1781 At another time when Brig. Gen. Thomas Sumter was present with his Brigade - and my Regt. in Co. there was Recd For the use of the Brigade from Andrew Baskin the Quantity of 50 Bu of Corn at Grey's Mill. John Marshal, Coll. Militia  
 6 Oct 1783 I had from Andrew Baskin 300 lb of Pork for the use of Coll. John Marshal's Reg in the Year 1781. Daniel Ayres

The above papers are dated Aug 28-1784 Camden Dist and Jan 8-1787 Lancaster Co, Lancaster was formed from Camden 1785. On Feb 17-1787 Andrew Baskin received a certificate for 15/18/6 for militia duty on foot and horse. He stated that he used this toward the purchase of 640 acres in 3 tracts (Mar 29-1787). He and Josiah Evans also supplied Genl. Gates' army with 5 head of cattle.

Later Years

In 1785 Andrew Baskin became one of the first justices in the new county of Lancaster. He also served as road commissioner. He was a member from the District East of the Wateree to the S. C. convention which met to vote on the adoption of the U. S. Constitution. On Jan 19-1788 he voted against calling a meeting in May. On Mar 23 he voted against adoption. In his district the vote was 9 for 1 against. The state vote was 149 to 73 for adoption. Brown says Baskin stood to gain by voting for the Constitution because he held \$224.24 in depreciated currency. He held to his convictions and voted against the Constitution as did most of the Back Country men.

On Apr 5-1790 he registered his stock mark in Lancaster Co. "Swallow fork and under keel or fish hook in each ear, Brand on horses AB and For Cattle A only." Andrew must have lived on his 1761 land in Kershaw Co until about 1797. Kershaw was formed from Lancaster in Feb 1791. In 1797 when he sold land he was in Lancaster 50 where he likely died - possibly at his son William's. The 1797 deed was recorded Nov 12-1800. He appears in the court records of Camden and Kershaw every year from 1787 to 1797. The last record of Andrew Baskin is Apr 22-1799 when in Camden Dist Court he and others were accused of rioting. Caro dismissed. His name is not in the 1790 or 1800 census. He likely died about 1800 and may lie in an unmarked grave in Baskins Cemetery in Lancaster Co. The will records of Lancaster were destroyed in 1865.

DESCENDANTS OF  
JOHN BASKIN

INCLUDES FAMILIES NAMED:

PONDS  
CULPEPPER  
ROQUE  
ALLEN  
AND OTHERS.



1 2 3 4 5 6 7 8 9 10 11 12 13 14

\* John Beckin #109 (1 Jan 1813) - (28 Jan 1911) m. (18 Sept 1833) Nancy Horton #110 (28 March 1813) - (18 April 1878)

\* Nancy Angeline Beckin #927 (10 Aug 1834) - ( ) 1872

\* Sarah L. Beckin #114 (21 Jan 1836) - (15 April 1928) m. (1 Jan 1858) Miles W. Pond #118 (14 Sept 1822) - ( ) 1843

    m. Robert Allen #929 (7 Sept 1836) - ( )

\* Sarah #927 (10 Feb 1826) - ( )

\* Jonathan F. Pond #120 (21 Sept 1857) - ( )

\* John R. Pond #928 (13 Sept 1840) - ( )

\* Joseph Washington Pond #119 (21 Aug 1842) - (13 June 1933) m. Mary Ann Gordon #141 (7 October 1811) - (25 October 1928)

\* Jessie Underen Pond #11 (12-Nov-1891) - (25-JUL-1978) m. (16-FEB-1912) Sam Culppepper #10 (13-FEB-1871) - (11-JAN-1934)

\* Lottie Mae Culppepper #12 (20-DEC-1913) - (25-OCT-1983) m. (19 Feb 1938) Patrick David Doss #331 (2 May 1913) - (8 April 1983)

\* Percy Davine Cook #332 (2 July 1948) - ( ) m. Darlene Hopkins #333

    Previously Married Jay Rose of Virginia on 5 April 1967

\* John David Rose #334 (5 May 1869) - ( )

\* Jeremy Hopkins #335 (28 July 1977) - ( )

    Jeremy and Jeffrey are twins

\* Jeffrey Hopkins #336 (28 July 1977) - ( )

\* Mary Elizabeth (Lib) Culppepper #13 (29 Mar 1914) - ( ) m. (2 October 1937) Matthew Connell Culppepper #279 (29 Sept 1911) - (28 Nov 1983)

\* Samuel Luther Culppepper #280 (5 April 1944) - ( ) m. (25 August 1967) Brenda Joyce Shirley #281 (1 March 1948) - ( )

\* William Timothy Culppepper #282 (30 Oct. 1970) - ( )

\* Steven Lee Culppepper #303 (13 March 1975) - ( )

\* Grace Myrland Culppepper #14 (23 Feb 1920) - ( ) m. (21 January 1939) Erell Dennis McKinney #337 (29 Sept 1911) - (28 Nov 1983)

\* Cynthia McKinney #338 (25 March 1947) - ( ) m. (19 Nov 1978) Rob Baker #339

    1st Marriage was to Forest Robert Dawson, Jr of Conn. on 18 Oct. 1968

\* Melody Dawson Baker #40 (17 July 1971) - ( )

\* Andrea Kelly (Andy) Barker #341 (30 Nov 1979) - ( )

\* Thomas Ralton (Toby) Barker #447 (31 Dec 1981) - ( )

\* Lewis Ellis Culppepper #1 (25-JUL-1933) - ( ) m. (09-SEP-1950) Eleanor Christine Shaw #2 (15-MAR-1927) - ( )

\* Dianne Culppepper #3 (25-JUL-1952) - ( ) m. (12-MAY-1984) Edwin L. Kelley, III #5 (10-FEB-1945) - ( )

\* Linda Ellis Culppepper, Jr. #4 (09-SEP-1954) - ( ) m. (24-AUG-1973) Donna Elaine Meador #6 (15-APR-1957) - ( )

\* Lynn Harrington #9 (25-AUG-1984) - ( )

\* Nathan Daniel Culppepper #7 (05-AUG-1974) - ( )

\* Matthew Arvon Culppepper #8 (25-JUL-1983) - ( )

\* Sam Cyril Culppepper #15 (8 Feb 1931) - ( ) m. (19 Nov 1950) Almgene Sims #78 (12 Dec 1939) - ( )

\* Preston Ponds #143 (1 June 1935) - ( ) m. (10 May 1954) Almgene McAllister #79 (17 Feb 1938) - ( )

\* Dixie Ponds #97 (2 Sept 1924) - ( )

    She married Martin McDonald

\* Annie Mae Ponds #145 m. (21 Dec 1914) Henry Lee Gough #834

\* Harold Gough #841 (1 Sept 1916) - ( )

    She married Gailly Stokes

\* James William Gough #882 (18 Mar 1920) - ( ) m. (15 April 1942) Annie Mae McCormick #916

\* Donald Gough #93 (12 Sept 1922) - ( ) m. (14 Feb 1948) Helen Gattman #917

\* Lillian Gough #84 (12 Dec 1924) - ( )

    He married Annie ?

\* Wilma Artelle Gough #895 (10 April 1927) - ( )

    married Grover McDonald 22 Mar 1947

\* Roland Ponds Gough #846 (21 Nov 1929) - ( )

    He married Imogene Boyette

\* Elmer Gough #887 (22 August 1934) - ( )

    She married Dennis Ellis

\* Tommy Peare #246 (30 Jan 1907) - ( ) m. (30 Dec 1924) Lois Carter #857 (4 Nov 1917) - (21 Oct 1974)

\* Shirley Lois Ponds #859 (15 October 1936) - ( ) m. Edna Massey #859

\* Essie Ponds #104 (14 Aug 1903) - (19 Oct 1903)

    Died while an infant

1 2 3 4 5 6 7 8 9 10 11 12 13 14

23