

WILL OF
SION COATES

The State of South Carolina

I Sion Coates of the District of Kershaw & State aforesaid calling to mind the uncertainty of life do make and publish this my last Will and testament in Manner & form following, Viz. Item 1. I give and devise to my son Sion Coates in fee Simple, all that parcel of Land purchased by me from Gillam Clanton Situate in the District of Kershaw on the drains of Singletons Creek also all the Land I now own that lays between the road passing by Liberty Hill to Camden the Land belonging to John Clanton, the Land now claimed by Dempsey Graham and a line running from the North East Corner of a tract of Land originally granted to Thomas Magee to a stake corner of the said Land thence continuing the course of Said line across a tract of Land originally granted to William Kirkland to a tract of Land originally granted to James Perry now in the possession of Dempsey Graham, I also give and bequeath to my Said Son Sion Coates one Negroe man named Bob.

Item 2. I give and devise to my two Sons Gideon Coates and John Coates in fee Simple All that tract or parcel of Land on which my dwelling House is Situated composed of parts of Several Surveys being all the Land I now own that lies between John Clantons Land, Austin F. Peays Land, the land now in the possession of Dempsey Graham and the land above designated & devised to my son Sion Coates to be equally divided between my said two Son's Gideon Coates & John Coates I also give and bequeath to my son Gideon Coates one Negroe Man named Joe, and a young Mare known by the name of the printer filly, and one Feather Bed & furniture- I also give & bequeath to my Son John Coates one colt known by the name of the Kupiosco Colt also one feather Bed and furniture.

Item 3. I give and bequeath to my daughter Betsey Coates two of my Slaves, Viz. Eliza and Harlotte, and a man Known by the name of the Virginus Filly

CLARE TOPPER

WILL OF SION COATES. Page 2

and a feather Bed & furniture. Item 4. I give and bequeath th two of my Slaves, Viz. Amy & Reuben a horse call John to my Wife Sarah Coates in trust, for the use of my daughter Jincey Revell, during her natural life and at her death to the heirs of her body forever. The earnings of Said negroes slaves and horse is not to be subject to the controul of her husband or liable for any of his debts. Item 5. I give and bequeath th to my daughter Mary Coates two of my Slaves, Viz. Chainsy and Diner, also one Feather Bed & furniture. Item 6. I give and bequeath to my daughter Rebecca Coates three of my Slaves, Viz. Mathew, Venus, and Jackson also one Feather bed and Furniture- th Item 7. I give and divide to my Wife Sarah Coates during her natural life the use of one third part of the land I have divided to my two Sons Gideon Coates and John Coates, I also give and bequeath to my said Wife Sarah Coates during her natural life three of ^{my} Slaves, Viz. Hannah, Ferriby and Jim and two of my horse, also all my Stock of Cattle, & Hogs My plantation Tools & also my Waggon & Gear & also all my Kitchen Furniture and the residue of My household Furniture- and after the death of my Wife Sarah Coates, the negroes, Stock of Cattle, Hogs, plantation Tools & the waggon & Gear Kitchen Furniture & Household Furniture in this Item of my Will - to be equally divided among all of her children or such of them as she the said Sarah Coates may direct, or the Same to be sold by my Executors & the proceed thereof be divided among such of her children as she may direct. th Item 8. I farther will and direct that a pice or parcel of Land lying on the North East side of the road pafsing by Liberty Hill to Camden and adjoining Joseph Cuninghams land & near to his dwelling house be sold by my Executors herein after Named in Such manner as shall appear to them Most for the interest of my Estate and the proceed thereof applied in the first plan to the purchase of a Negroe boy for my son John Coates, the boy to be of a good Size for

WILL OF SION COATES. Page 3

a plough boy, the balance arising from the Sales of this land, if any balance to be applied to the payment of my debts. ---
Item 9.. I will and bequeath to my daughter Polly Flanigan Two hundred Dollars to be paid her by my Executors here after named out of the proceed of the crops to be raised on my plantation, at the Expiration of three Years from the time of my death.--- Item 10.. I also will and direct as a further Means for the payment of my debts, that the whole of my Land devised to my children (except the land devised to my Son Sion Coates) and all my Slaves, Horse, Stock Cattle, Stock Hogs, Household & Kitchen furniture plantation tools waggon & Gears &. bequeathed to My Wife & children (except the Negroe Slave named Bob bequeathed to my son Sion Coates) and every thing necessary & proper for the carrying the planting on my said Lands as fully as at present, remain in the hands and under the direction and management of my Executors for three Years, or untill the profits & earnings thereof together with monies to be raised by Sales of the Land authorized to be made by my Executors shall enable them to pay off and discharge all my just debts, the Legacy to my daughter Polly Flanagan & the negroe boy for my son John and untill the devices & Legacies be delivered up to my Wife & children. The above mentioned property whilst it remains in the hands of my Executors is hereby charged with a reasonable allowance for the Support of, and Maintainance of my Wife and children (except my son Sion Coates) and with a reasonable allowance for the Schooling of my three youngest children their Schooling to be such as I have given my other children. Item 11.. I do hereby further authorize my Executors here after named to renew regularly & Keep up all my notes in any and each of the Banks, According to the rules and regulations of said Banks untill they can finally pay off and satisfy & discharge the same out of monies of my Estate.----
Item 12.. Lastly I hereby nominate, constitute and appoint my

Wife Sarah Coates my Executrix my Son Sion Coates & my friend
Austin F. Peay Executors of this my last will and testament.

In witness whereof I have hereunto set my hand and Seal this
twenty Seventh day of March in the year of our Lord one thou-
sand Eight Hundred and Thirty & in the fifty fourth year of
American Independence.

Signed Sealed published & Delivered by)
the said Testator who signed this sheet)
& the sheet hereunto annexed as his last)
Will & testament, in presence of us who)
at his request & in his presence & in the)
presence of each other, have Subscribed)
our Names as Witnesses to the due Execu-)
tor thereof)

Sion Coates (SEAL)

Roland Cornelius)

John Clanton Junior)

Nathaniel Clanton Junior)

Recorded in Will Book O Page 323

Recorded May 20, 1830

Ord. David Schrock

Apt. 17 Pkg. 536

Coats - 6-10

FIFTH GENERATION

10. Daniel^s Coats (Sion L., 12). Born, 14 Dec 1806, in S.C. Died, 30 Nov 1862, in Miss. Burial: 1862, in Knight Cem., Gitano, Miss.

He married Eugena Garrick (11), circa 1832. Children:

- i. Mary Elizabeth⁴ Coats. Born, 19 Mar 18~~0~~³⁴. Died, circa 1864.
- ii. Matilda Coats. Born, 17 Jun 1837, in Lauderdale Co., Miss. Died, 22 Oct 1898. She married William Bryant Valentine.
- iii. Frances "Fannie" Coats. Born, 14 Jul 1840, in Jones Co., Miss. Died, 3 Jan 1912. She married John Ira Valentine.
- iv. Armarada Coats. Born, 11 Dec 1842. Died, circa 1903. She married William Welch.
- v. Morgan Marida "Med" Coats. Born, 16 Jul 1844. Died, circa 1914. He married Elizabeth Drennan. *married Elizabeth*
- vi. Adam Coats. Born, 29 Mar 1847, in Jones Co., Miss. Died, 10 Apr 1924. He married Jane Powell.
- vii. Sarah Jane Coats. Born, 27 Aug 1843. Died, circa 1901. She married Richard Hamel Valentine.
- viii. Candey Coats. Born, 29 Dec 1851. Died, circa 1863.
- ix. Daniel Coats, Jr. Born, 5 Jul 1853, in Jones Co., Miss. Died, circa 1862.
- x. James Buchanan Coats.

8

11. Eugena^s Garrick. Born, 14 Mar 1814, in Orangeburg Dist., S.C. Died, 30 Jan 1896.

She married Daniel Coats (10).

SIXTH GENERATION

12. Sion L.⁶ Coats (Sion, 14). Born, circa 1770, in S.C. Died, circa 1854, in Lauderdale Co., Miss. Census: circa 1850, in Lauderdale Co., Miss.

He married, first, Mrs. Sion Coats (13), circa 1800. Children:

- i. William⁵ Coats. Born, Dec 1804, in S.C. He married¹ Nancy Jane Kittrell.
- 10 ii. Daniel Coats. *14 Dec. 1806 SC d 30 Nov 1862*
- iii. Sion Coats III. Born, 30 Nov 1807, in S.C. Died, 3 Oct 1857, in Etowah Co., Ala. Census: circa 1850, in Cherokee Co., Ala. He married Mrs. Elizabeth Coats.

He married, second, Catherine Musgraves, 25 Oct 1816, in Greene Co., Tenn. Children:

- iv. Livona Coats. Born, circa 1820, in S.C.
- v. Elizabeth Coats. Born, circa 1825, in S.C.

13. Mrs. Sion⁶ Coats. Born, circa 1775.

She married Sion L. Coats (12).

SEVENTH GENERATION

14. Sion⁷ Coats (Joseph, 16). Born, circa 1742, in S.C. Died, circa 1830.
He married, first, Mary Perry (15), circa 1769. Children:
- 12 i. Sion L.⁶ Coats.
- He married, second, Sarah Perry, circa 1790. Children:
- ii. Gideon E. Coats. Born, 24 Jun 1811, in S.C. Died, 21 Feb 1883. He married Sarah Coats, 27 Jan 1842.
- iii. John Coats.
- iv. Elizabeth (Betsy) Coats.
- v. Jincey Coats Revell.
- vi. Mary Coats.
- vii. Rebecca Coats.
- viii. Polly Coats Flanigan.
15. Mary⁷ Perry. Born, circa 1768. Died, circa 1788.
She married Sion Coats (14):

EIGHTH GENERATION

16. Joseph^a Coats (Thomas, 17). Born, circa 1705, in England?.
He married Elizabeth Ann Marr. Born, circa 1710. Children:
- 14 i. Sion⁷ Coats.

NINTH GENERATION

17. Thomas^o Coats. Born, circa 1675, in Glasgow, Kingdom of North, Britain.
He married Sarah Cramer (18). Children:
- i. William^a Coats ,Sr. Born, circa 1700, in England?. Died,
 21 Mar 1753, in Charles Town, S.C. Immigration: circa
 1719, in America. Occupation: Minister. He married an
 unknown woman.
- 16 ii. Joseph Coats.
18. Sarah^o Cramer.
She married Thomas Coats (17).

Sandra Bradley
401 Parkway Dr.
Natchitoches, La
71457

318-352-4692

NOTES AND REFERENCES

¹Thomas M. Coats.

Mr. Geo. W. Nisbet

Meridian, Miss.

Aug 29th 1874

TO HORN & KERLEE, DR.

for subscription to Weekly MERCURY, from Aug 19th 1873
to Aug 19th 1874 at \$ 2.50 per annum, \$ 2.50

Received payment

Geo. W. Nisbet
per Nisbet

FOR BIRTH

Articles Sent Number 2. Lander date. 1872
 May the 1 1872

The undersigned Proposes to Teach school
 at the new school House Near Jelen, W
 Pittrells for the Term of four ~~five~~ months
 Commencing May the 6th 1872 at one
 Dollar and a half a scholar for Month
 for all signed Day scholars the same
 State

Names	Number	signed
W. H. Weatherford	2	
W. J. Gorman	2	
W. H. Forence	2	
J. H. Hatchett	1	
J. W. Pittrell	1	
A. A. Brown	1	

W. G. Gibson

Washing Receipt

1 lb. Hard Soap
7 oz. Sparrow's Soapstone
" " " " Beards horn
" " " " Vinegar

Dissolve the soap in hot water
mix the ingredients - Put half the mixture
on right in sufficient water to cover
the clothes, next morning wring them
out, put the balance of the mixture in a
boil 30 minutes

Rt. 2 Box 390
TAYLORSVILLE, MS. 39168
Jan. 22, 1986

Dear Mary

My G.G. Grandfather, Daniel Coats, was b. 14 Dec. 1806 in
Orangeburg District S.C.
d. 30 Nov. 1862 Utah, Ms.
he married a S.C. girl Eugenia Davrick b. Mar. 14, 1814. S.C.
d. here 30 Jan. 1896
in the home of her youngest son
James Buchanan Coats, my G. Grandfather
(my ~~father~~ sister still lives with her
husband and family in this Victorian house.

Daniel's older brother was
William Coats b. Dec. 1804 Orangeburg District, S.C.
he d. after 1850 perhaps in Jones County.
he married a S.C. girl Nancy Jane Kittrell b. 18 Feb. 1812
both couples came to Lauderdale County (Meridian)
later (ca. 1830) to Jones County (here ~~was~~ where we live)
Daniel first, Williams later.
William Coats + Nancy Jane Kittrell's
Children were: Thomas Coats b. 1834 died in the Civil War.
Mary Coats c. 1836
Annie Coats b. 1838
Ellen Coats b. 1840
Eliza Jane Coats b. 18 Feb. 1842 d. 11 Aug. 1886
m. James Morgan Valentine

The above children were born in Lauderdale County —
Thomas Coats came to Jones Co. where he had
one son Jefferson Davis Coats. Since Thomas did
not return from the war, he still left descendants to
Carson his name. They live in Soso, Ms. proper.

2-

I have a very complete Coats record on my line. I also have a large family of brothers, Sisters, their families, etc.

None of my records show TABITHA COATS. I do believe she was a sister of Daniel and William or at least a ~~close~~ close Cousin. Also, marrying a Pittrell we might consider that Nancy Jane was close kin to Nathaniel.

Thank you so much for this Pittrell family record. I have searched all over for it!

Thank's for your help.

Your friend (as if forever)

Edsel R. Coats

1880
68
12

P. S. I'll not bother you with too much on this Coats' branch. We do love the Pittrells — be patient with my writing! I do type, but prefer this!

Ed

Names of parents?

Coats Brothers

from Orangeburg District, S.C.

Daniel Coats (991)

William Coats

b. 14 Dec. 1806 S.C.

b. Dec. 1804 S.C.

d. 30 Nov. 1862 Githens, Mo.

d. after 1850 Jones Co.
(Perhaps in Jones Co.?)
Where buried?

Mr. Eugenia Garick

Mr. Nancy Jane Kitchell

Assume Mr. S.C.?

Name of father unknown -
Assume they were Mr. S.P.?

b. 14 Mar. 1814 S.C.

A. 18 Feb. 1812 S.C.

d. 30 Jan. 1896 Taylorsville, Mo.

in the home of his youngest son.
Where buried?

Where did he die?
Where buried?

1.

2.

1. Thomas Coats b. 1834 Mo.

2. Mary Coats A. 1836 Mo.

3. Annie Coats A. 1838 Mo.

4. Ellen Coats A. 1840 Mo.

? James Buchanan Coats (91)

5. Eliza Jane Coats

A. 18 Feb. 1842 Mo.

d. 11 Aug. 1886

?

Mr. James Morgan Valentine

Edual R. Coats (Taylorsville, Mo.)

The above children of William Coats & Nancy Jane Kitchell were all born in Tazewell Co., Mo.

WILL GET THIS OFF TO YOU. HAVE DEAD INFO - & BE
sent in next letter.

KITRELL

BOOK 2 ORIGINAL LAND ENTRIES - LAUDERDALE CO. MS.
NATHANIEL KITRELL first bought LAND IN LAUDERDALE
Co MS on Feb. 11, 1836 - Certificate 25556 for \$107.62
(He apparently bought the LAND from some LAND office
could have been office AT Columbus MS. The value was
\$1.25 per acre - 86 + .10 acres.

this the S 1/2 of NW 1/4 in Section 13 Township 8 Range 16W
(SAM DALE owned SECTION 14 + 15 - Given to him for his
WORK IN REGARD to the TREATY of DANCING RABBIT CREEK

NATHANIEL ALSO BOUGHT 43 ACRES - SECTION 36
TOWNSHIP 8 RANGE 16W on 9/19/1849. Certificate
33645. THIS NEAR LOCKHART + SE of LIZELIA.
Certificates were issued from either the LAND office
IN Columbus MS OR the LAND office IN AGUSTA
NOW NEW AGUSTA - NEAR HATTIESBURG MS.

HENRY M KITRELL located (wanted land + improved it) and
later received same from the land office on 8/7/1850

NE of SE 1/4 40 acres Sec 27 T8 R16W. Also secured
another 40 acres in same section on 9/19/1849 which
AN INDIAN HOLIS OH TN BRE had apparently been granted
After the treaty or had filed CLAIM ON SAME. There were
many INDIAN LAND CLAIMS - ABOUT 300 IN LAUDERDALE
Co. The INDIAN PROBABLY Released his CLAIM

Now: It was JAN 23, 1872 when JOHN W KITRELL
bought LAND - 80 acres in Sec 27 T8 R16W. On the
same day ELISHA B KITRELL bought 80 acres same section
+ MARGARET J KITRELL bought 40 ACRES on 2/1/1872

See MAP: SECTION 13 (NATHANIEL) IS ON THE PRESENT NAVY
BASE. SECTION 27 IS NOT BUT CLOSE. THE GRAVE
YARD IS EAST of present Hwy 39 NOT between the new + old
Hwy 39

There is ONE GRAVE YARD that was moved by the
NAVY. IN PLAIN VIEW. WILL CHECK

LAUDERDALE became A COUNTY 12/23/1833
NATHANIEL here by or before 2/11/1836 - so he was

KITRELL

AN EARLY SETTLER. PROBABLY LEAD HERE BY SAM DAK
SAM WAS A SCOUT

WILLIAM W KITRELL BOUGHT LAND, LOTS 13, 14, 18 + 19
172 ACRES FOR 10⁰⁰ PER ACRE ON 1/7/1889 Certificate
NO 19117 in Sec 1 T8 R16W. This just above Section 13
bordering Kansas Co Line

THERE WAS NO WEATHERFORD ON THIS BOOK OF
ORIGINAL ENTRIES. THE LAND WAS RECORDED AFTER
THE LAND WAS SURVEYED. WEATHERFORD HAD LAND NO
DOUBT IN SAME AREA, JUST NOT RECORDED.

CHECK THROUGH DEAD BOOKS SHOULD REVEAL THIS
DESIRED INFO
MORE LATER.

IN CHECKING DEAD BOOK A PAGE 84
NATHANIEL KITRELL ON 8/25/1838 BOUGHT 86 ACRES
W $\frac{1}{2}$ SW $\frac{1}{4}$ SEC 13 T8 R16W FOR \$1,000 FROM JOHN
BAILIFF + HIS WIFE EDYAN. ALSO HE (NATHANIEL) BOUGHT
43 ACRES W $\frac{1}{2}$ W $\frac{1}{2}$ NW $\frac{1}{4}$ FROM THE BAILIFFS. THIS ALSO IN
SECTION 13 T8 R16W.

NOTHING IN BOOK A REGARDING JOHN W. OR WEATHERFORD

DEAD BOOK B PAGE 345-346
1/12/1841 RICHARD WEATHERFORD PURCHASED FROM
JAMES P HILL + WIFE LUCY FOR \$3,000 THE NE $\frac{1}{4}$ OF SW $\frac{1}{4}$ OF
SEC 26 T8 R16W. - 39 $\frac{8}{100}$ ACRES

DEAD BOOK C PAGE 365-366
ON 11/28/1843 NATHANIEL KITRELL AND HIS WIFE
TILITHA SOLD W $\frac{1}{2}$ OF SW $\frac{1}{4}$ SEC 13 T8 R16W - 86 ACRES
FOR \$479.00 TO ELISHA MOSLY + A H HARRIS
ADMINISTRATORS OF ESTATE OF WILEY MOSLY DECEASED.

DEAD BOOK D - NOTHING

NO KITRELL IN LAUDERDALE CO MS CSA PENSION
APPLICATION FILE

1878 LAUDERDALE CO LAND ROLL BOOK

J W KITRELL owned

E $\frac{1}{2}$ NW $\frac{1}{4}$ + E $\frac{1}{2}$ SW $\frac{1}{4}$ Sec 10 T8 R16W
400 acres Value \$800.00

M. Kitrell

NW NW $\frac{1}{4}$ Sec 36 T8 R16W 40 acres \$50.00

THIS PROBABLY THE LAST of NATHANIEL LAND.

Neither were on the 1841 or 1850 Land Roll Book.

1885 - ENUMERATION of EDUCABLE CHILDREN - LAUDERDALE CO MS
BEAT 2 (NE Section of County) WARD 2

CHILDREN

FATHER	NAME	AGE	SEX
W.W KITRELL	ANNA L	6	F
	Oley M	5	F

J C KITRELL	Jennie	15	F
	FRANK	14	M
	LANK	12	M
	Lenny	11	M
	Andy	9	M
	CHARLEY	8	M
	ELLEN	6	F
	EADY	5	F

1885
15
1870

The ABOVE KITRELLS were fairly close together

J W KITRELL	J R	18	M (b 1867)
	LILLIE	9	F (b 1876)
	MILLIE	9	F "

So the J R who md in 1877 WAS NOT THE J R ABOVE. Who would have been 10 yrs old in 1877. FORGET MY SPECULATIONS!!

The VOTING TOWNS IN THE ABOVE BEAT 2 WERE
LAUDERDALE, LOCKHART + HICKORY GROVE. THESE THE MAIN
TOWNS. OTHERS DALEVILLE + LIZALIA

Beat 1 - MARION

E B KITRELL

WILLIAM N

16

M

DORER

10

F

ONIMUS B

6

M

I STILL HAVE NOT HAD TIME TO CHECK FURTHER IN THE SCHOOL RECORDS

I ALSO WANT TO CHECK CENSUS RECORD. WILL COVER SAME IN NEXT REPORT.

DON'T SEEM TO FIND MUCH ON WEATHERFORDS BUT HAVE SEEN THE NAME. WILL CHECK CIRCUIT COURT + PROBATE RECORD

YOU ARE GETTING INFO THAT IS NOT AVAILABLE ELSEWHERE. WHEN WE GET IT ALL INDEXED IT WON'T TAKE SO MUCH TIME

AM GETTING FAIRLY SURE THAT THE GRAVE YARD THAT WAS MOVED IS HICKORY GROVE. AM GOING THERE TO SEE IF KITRELL BURIED THERE. THIS CEMETERY IS OUTSIDE THE ENTRANCE TO NAVY BASE + WAS MOVED

HOPE TO GET THIS MAILED TOMORROW.

WE KNOW NATHANIEL WAS ALIVE IN 1878. WE MAY NEVER FIND HIS GRAVE - SINCE THIS WAS CARPET Bagger days + THERE WAS NO MONEY FOR GRANESTONES.

Sincerely
Jim Dawson

1

Kittrells Not accounted for

① John G. Kittrell to Sadie Page Van Sykes 1911

are these the same? ② J. R. Kittrell to Alice Weston 1877

John R. vs John R. - admitted self to hosp. for treatment -

③ Quiner R. Kittrell - committed to state hospital

Is this 2nd wife of Wm. R. ④ Mrs. Ropic - Lunacy of -

⑤ Eric Kittrell - estate of

⑥ William C. Kittrell - brought divorce action 3 different times against Violet E. Kittrell.

* ⑦ Effie Lee Kittrell divorced Timothy Franklin Kittrell
Chart shows only 2 marriages for Timothy Franklin Kittrell and no Timothy Franklin Jr. among offspring.
yet there is a Timothy Franklin Jr. in Hickory Grove Cemetery -
Is this one Jr. or Sr.?

⑧ Timothy Franklin Kittrell Jr. - Jan. 14, 1931 - Feb. 27, 1978

⑨ Lena Kittrell Caldwell - Jan. 5, 1901 - June 4, 1976

⑩ May Kittrell McKeithen - May 7, 1900 - Jan. 24, 1980

⑪ Elizabeth J. Pittell - Nov. 16, 1868 - Aug. 3, 1915

⑫ Unnamed Pittell Farmer - (Female) - off-spring
and possibly grandson -

J. R. said
she was
his Cousin.

Annie Sharp Watkins - 1877 - 1940

William Elbert Weatherford - 1/23/1909 - 12/28/1928
(Fellowship Baptist Cemetery)

DEEN, CAMERON, PRICHARD, YOUNG & KITTRELL
ATTORNEYS AT LAW

1122 22ND AVENUE
MERIDIAN, MISSISSIPPI 39301
TELEPHONE (601) 693-2561

Dec. 27, 1985

Dear Mary,

I hope that you and your family enjoyed a Merry Christmas. I met with Jim Dawson a few days ago and made a copy of the family tree diagram. I received the enclosed information from Robert D. Kittrell (son of Franklin Thomas Kittrell and grandson of Isham Kittrell), and thought I'd share it with you. Robert lives here in Meridian.

As for my parents: My father was a Sgt. in the U.S. Army in WWII and was stationed in Belgium. He worked

DEEN, CAMERON, PRICHARD, YOUNG & KITTRELL
ATTORNEYS AT LAW

1122 22ND AVENUE
MERIDIAN, MISSISSIPPI 39301
TELEPHONE (601) 693-2561

for Liberty National Life Ins. Co. when I was very young.
Later, he sold cars at Consolidated Motor Lincoln-Mercury.
Afterward, he worked approx. 10 years at Meridian Naval
Air Station. He was killed in a work related accident,
there in Feb., 1974.

My mother grew up in Noxapater, Miss. She went
to Mattie Herse Nursing School in Meridian, where she
was an outstanding student. She worked as a nurse
at Rush Hospital in Meridian, and "private duty,"
as long as she was healthy. She was seldom "well",
having a miscarriage prior to my birth. She developed
heart trouble, high blood pressure, thyroid problems,

DEEN, CAMERON, PRICHARD, YOUNG & KITTRELL
ATTORNEYS AT LAW

1122 22ND AVENUE
MERIDIAN, MISSISSIPPI 39301
TELEPHONE (601) 693-2561

ulcers, and finally cancer. She died of cancer in Jan. 1972.
Looking forward to hearing from you.

Jerame

Dear Mary

12/11/85

Know you are busy now & have this on
back burner. Things sure are getting a high
gear around here.

Finally got the 30 minute TV show off &
behind me - also the board meeting. Got all
material ready to take to legislators to get
law modified for the Co & City to be authorized
to fund Archives

RAN INTO NEW NAME:

1872 Lauderdale Co. Assessment, Florida State Tax
N. B. KITRELL ASSESSED 70 CENTS on
2 1/2 of NE 1/4 SECTION 2 T 7 R 16E - 80 acres
valued at \$200.00

This is first time this N B has appeared

1874 Assessment Book

N B Kitrell in the same location - 80 acres

In 1874 he also owned 100 acres in Section 30 T 8

SO WAS NATHANIEL also N B?

Now:

1872 Book

N. Kitrell NW SW 1/4 S 26 T 8 R 16E 40 acres
Value \$60.00

1874 N. Kitrell NW SW 1/4 S 36 (26) T 8 R 16E 40 acres

NATHANIEL no doubt owned more than 40 acres?

Of him why was it N why wasn't it all written as
N Kitrell. It indicates that N and N B are two
different people

We have N in the deed books but there
is no N B in same.

1872 Book

H R Weatherford Lot 67 S1 T8 R16E 80 acres \$160.00
also lot 16 Sec 3 T8 R16E 40 acres \$80.00

W H Weatherford S10 T8 R16E \$200.00

J W Kittrell NW 1/2 NE 1/4 SW NE 1/4 NW SE 1/4
S10 T8 R16E 160 acres \$480.00

J W Kittrell NW 1/2 SE 1/4 S 27 T8 R 16E 40 acres \$60.00
SW 1/2 SE 1/4 " " " " 50.00

E B Kittrell SE NW 1/4 SW NE 1/4 SW SW 1/4 S35 T8 R16E

1874 Book

H R still when he was

J W Kittrell Same except had sold some of the land
was in S10 T8 R16E

E B Kittrell listed in S35 T8 R16E same

There is a

WILLIAM WALTER KITRELL buried in the
Cemetery of the ZION BAPTIST CHURCH at RIO (R40)
just across Co line in Kanjan Co MS
B 1/15/1857 & 1/22/1941

There was nothing more in Church material that
I have.

1880 Census Fairbault Co MS Western Part, Beat 2 P13

114 Kittrell, John 43 Farmer & MS Paint & SC

Matth 40 (Wife) " " " " Ha

John 13 SON " " " " MS

Sallie 6 Daw " " " " "

Minnie 6 " " " " "

John A Crage freed bond

1857
3

1880
43
3

1880 68 68 1880 1880
 20 23 23 68
 184 185 185 12

Same Best 2 (Western part)

130	Kitrell (No first name)	Female	68	Farmer	L SC	Parents	SC
	Ross		23	Labourer	" MS	"	"
	Mary		20	Daughter	" "	"	"
	Robert		9/12	Stepson	" "	MS	MS

Ross not indicated as SON yet least name was Kitrell

Don't get the Step SON BIT. Step SON of MARY?

SURELY NOT the 68 year old female
 (Here you file at home - want to get this in mail to you)

Spine Best 2 (Western Part)

167-261	Kitrell, George	24	Farmer	Single	L MS	Parents	L SC
	Dove	23	Brother	"	"	"	"
	Jane	60	Mother		L SC	"	"
	McMillen, Ellen	35	Female	Sister	L SC	"	"

Afrop Dues Hued herd

Best 3 - Page 43

321-324	Kitrell, John C	48	Farmer	L MS	Parents	L SC
	Nancy	34		"	Unknown	
	Jenny	11	(Female) daughter	L MS	Worked on farm	Parents L MS
	Frank	10	Son	Worked on farm	L MS	" " "
(LANKford?)	LANKforce	8	"	" " "	"	" " "
	Andy	6	"	at home	"	" " "
	Charles	5	"	"	"	" " "
	Sevi	7	"	"	"	" " "
	Ellen	3	da.	"	"	" " "
	Caroline	1	"	"	"	" " "

Back to Best 2

171-265	Kitrell, Elisia	37	Farmer	L MS	Parents	L SC
	Margaret	27	Wife	L MS	"	"
	William	12	Son	"	"	"
	Amanda	7	Daughter	"	"	"
	AMOUS	2	Son	"	"	"

The above represents 8 hours @ \$3.00 per hour for \$24.00
 Job Care

Sincerely
 Jim Dawson

Route 6 Box 115
Meridian, MS 39301

11/6/85

Dear Mr Winnard

Will commence this - In Pencil - so can go back
& correct if need arises.

Lauderdale Co Schools

White Schools Beat 1 1879. Beat 1 was Meridian
and surrounding area.

HAWKINS (Now part of East side of Meridian) - Grade one
E B KITRELL Trustee appointed 12/11/1879

KITRELL (IN BEAT # TWO) THE SECTION of the County.
J W KITRELL Trustee - appointed 2/11/1879
Grade Two.

These schools were handled as follows:

The PATRONS would get together - build a school -
furnish ALL supplies etc AND IN MANY CASES
PAY PART OR ALL of Teachers SALARY. The schools
were LOCATED yearly - AND the NAME of the
school changed often - from year to year.

Fort Stephens School was on Kemper/Lauderdale
Co. Line - later it was in Lauderdale Co.

White School Located 1880

E B KITRELL still Trustee of HAWKINS - IN BEAT ONE

Beat 3

HARRINGTON. Teacher S B Cooper - Contract 6/13/1880.
This school referred to as SPRING HILL on Cooper
Institute. One of the TRUSTEES WAS H. P. HARRINGTON,

thus he had the school named after him for a year.
TUCKERS School - Teacher W. L. MOORE Contract
1/6/1880. EXACT LOCATION NOT KNOWN.

1881

Dum Sole Teacher W. L. MOORE Contract 5/17/1881
(This now present Bailey ms)

1882

BEAT 2

HAWKINSfield - ER KITRELL TRUSTEE

TUCKERS - WILLIAM MOORE TEACHER CONTRACT 1/9/1882

(The next year 1883 the name was "MARTIN BOY SCHOOL")

HARRINGTON - This was Line School serving
STUDENTS IN Kemper. Do NOT THINK IT WAS
COOPER INSTITUTE BUT IT NO DOUBT WAS NEAR
PRESENT DALEVILLE

White Schools 1900-1901 (List of Teachers)

Smith's Chapel - Jennie Moore

Lauderdale - Luda Moore

Cooper Institute - WALDO MOORE

NO KITRELL

Now to the List of Teachers for year 1886-87

In July 1887 J R KITRELL WAS PAID \$114.00
for Teaching school. but it does NOT mention name of
school. Will back track to see if can find name

Oh Goodness. Record that year left off a lot of info -
At the time of the location of the schools, info incomplete
on some school. Lets TAKE BEAT 2 (NE Section) & BEAT 3.

Rechecked for any possible lead

In BEAT 2 there was CALVARY School with no info. also

WILLIAMS In BEAT 3 COOL SPRINGS WITH NO INFO - also

BLACKMANS AND JOHNSONS

CONTINUING WITH ABOVE LIST

MISS LILLY MOORE PAID \$29.00

SO NOW we know they were Teaching in LAUDERDALE Co

In this same school year (There were most ALWAYS
two periods of 4 months schooling)

J R Kitrell Paid $29.00 + 29.00 = 58.00$

MISS LILLY MOORE $81.00 + 29.00 = 110.00$

There were NO further record of their Teaching
AFTER the school year 1886-87

Could be They then went to Kemper

WAIT A MINUTE

White Teachers Examined in MAY 1887

PAID 50¢ Miss Lilly Moore - ENTERPRISE to WANITA Box - WILL
ISSUE 2nd grade. She had already passed 1st grade
PROBABLY IN 1885 (HAVE NO RECORD ON 1885)

THE WANITA WAS THE POST OFFICE ENTERPRISE IS IN
CLARKE Co MS. JUST ACROSS THE LINE. APPARENTLY SHE
LIVED AT ENTERPRISE. I WILL EXPLORE 1880 Census
of CLARKE Co MS. - SHOULD GIVE HER PARENTS

J R KITRELL - DAKVILLE. He too paid 50¢ - was
issued 2nd grade Teaching Certificate. It says
'WILL issue' so date of issue later
He was LIVING AT DAKVILLE.

We STILL do NOT have the name school they taught
AT.

J R KITRELL ATTENDED A TEACHERS INSTITUTE in
JUNE 1887. He APPARENTLY GAVE A PRESENTATION
on GRAMMAR & COMPOSITION !! for 2nd grade level.
Miss Lilly Moore ALSO ATTENDED & ALONG WITH J R
WAS EXAMINED AT THE CLOSING INSTITUTE

J R along with two other men held ARITHMETIC
discussions of difficult examples of percentages
while Lilly Moore helped with discussion on
M (math?) ARITHMETIC MODEL ANALYSIS for diagram

FROM THE WAY IT READS THEY BOTH PARTICIPATED
in A NUMBER of INSTITUTES THAT YEAR 1886-87

END of book. WENT PAGE BY PAGE
So, IT APPEARS THAT J R + LILLY LEFT SOMETIME
AFTER JUNE 1887

OUR MARRIAGE RECORDS DO NOT REFLECT THE MARRIAGE of
J R + LILLY - WHICH MOST LIKELY OCCURED IN 1887-88??
IT COULD BE (THE RECORD) IN THE COURT HOUSE, QUITMAN
(CLARKE Co) MS. If Lilly lived in Enterprise - she more than
likely married there at her parents home I will check
on this.

MARRIAGE Record Lauderdale Co MS
 1854 KITRELL, H M md JANE CLAYTON Book page
 A-1 118
 1860 Kitrell, John W md Martha A Weatherford
 on 8/1/1860 by Thomas J Hand Minister of the Gospel
 License issued on 8/1/1860
 Bondmen J W and C. C. TRAWICK BK 1 P 115

1867 E B Kitrell and Mrs RASBURY BK 1 - P 422

1877 J R (now index J R R J R R) Kitrell and Alice Weston
 BK B Page 311
 married by L E Hall mgt on 9/2/1877 - License
 issued 8/31/1877 Bondmen J R + Y W BIRD
 On the license study it was J R not J R R.
 This would indicate THAT J R WAS MARRIED
 before his later marriage to Tully Moore.

Went on to 1900:

Year	Name	Spouse	Book	Page
1892	F T Kitrell	md Mollie WARD	BK	P
1894	E B	" Mollie Phyllis	2-A	29
	W N	" Mamine Odum	2-B	104
1900	O B Kitrell	" Effie Covington	2-B	60
1904	E B	" Clara Lon BRICK	3	337
"	J I	" Minnie Cummings	5	92
			5	220

Cemetery Records

Hickory Grove Cemetery - Lizelia.
 Now Lizelia is really old Dalville. It is located
 just west of the 2nd Navy Base (not Air Force). The
 Navy Base was opened AFTER WWII. There was
 no base of any kind there before. More later. Lizelia
 is what GRACE KITRELL called Lizely and it is
 located west of present or new Dalville. Dalville
 we think was moved on account of the School-
 Cooper Institute or Cooper Normal College.
 There is NOTHING AT Lizelia now but was
 once huge farming lands.

Children of John W & Martha W. Kittrell

on may
near this

FRANCES LEONORA 7/15/1861 - 9/9/1864
ARTIS DEWATT 8/30/1869 - 7/25/1872
2 LA MARTHA 2/11/1877 - 11/15/1879
JONES WILBURN 1/9/1881 - 12/30/1895
Infant SON (not named) 10/8/1870 - 10/21/1870

NANCY A KITTRELL Wife of J. C. Kittrell 1/10/1849 - 9/27/1919

MINNIE I KITTRELL daughter of J. L. & M. L. Kittrell
8/7/1907 - 12/27/1907

BROTHER

CAS MAXWELL KITTRELL 7/4/1890 - 3/29/1955

MOTHER

ELIZABETH J. KITTRELL 11/16/1868 - 8/3/1915

FATHER

John L. Kittrell 7/6/1871 - 3/31/1934

John Kittrell Company 5 ms. Ing. CSA no date.

MARY L. KITTRELL 2/2/1902 - 9/12/1941

SUSAN

FRANK THOMAS KITTRELL 4/12/1872 - 4/11/1953

LUTHER B. KITTRELL 4/6/1901 - 2/19/1936

MOLLIE W. KITTRELL 12/4/1876 - 12/14/1944

EB KITTRELL 8/10/1837 - 7/20/1905

ANDY ARTIS KITTRELL son of J. B. & Ada
11/20/1915 - 2/10/1934

FATHER

James Charlie KITTRELL 9/8/1875 - 2/27/1945

Mother ADA ESTHER WHITE KITTRELL
12/7/1893 - 11/16/1964

Mother

ELIZABETH J KITRELL 11/16/1868 - 8/3/1915 -

BLACK WATER BAPTIST Church Cemetery.
In Kenyon Co - Just above Daleville

Blalys Kitterell 8/21/1907 - 2/16/1912

Emma Holloway Kitterell 7/24/1893 - 6/25/1913

Your Letter - Have both now. The first got sent
to the Food Stamp Office !!

I think there is a small frame house. I will
re-check it shortly

I will let you know re charges what will be
reasonable. For you it will be \$3.00 per hour of researching.
If I go to Putnam then will be \$25.00 travel cost. For
going to Daleville it will be \$12.00. You will not be
charged for any trips I have made so far

When did Lilly die? What year? and 74 years at time of
death

Desire to check Lauderdale Co 1880 Census for J.R.
If I was him who md in 1877 the more than Lilly will be
on the census

MARION

1870 Lauderdale Co Census

Just

Township 7 Beat 1 P.O. MARION STATION. MARION

moved

became MARION STATION AFTER THE RR CAME THROUGH

over to

Page 113, Dwelling # 384 Family # 384

R.R

KITRELL, NATHANIEL age 60 t SC (1810)

MARGARET 28 t MS (1842)

AMANDA 20 " " (1850)

CALVIN R 14 " " (1854)

WILLIAM W 13 " " (1857)

Wife & mother dead before 1870. Need also to check
1860 Lauderdale Census Record

Next door

85-385 KITRELL ELISHA (male) 32 t MS (1838)

MARGARET J 24 t MS (1846)

WILLIAM N 1 t MS (1869)

Page 170

5 4-544	KITTRELL Jcem	75	+ SC (1755)
	JANE	56	" " (1814)
	MARY	24	+ MS (1846)
	DANIEL	16	" " (1854)
	DAVID A	15	" " (1855)
	McMILLAN, ELIZABETH	34	+ SC (1836)

NATHANIEL + 1810 + Jcem (Jcem) + 1795. Could have been brothers

APPARENTLY JOHN WASHINGTON NOT IN COUNTY (Lauderdale) in 1870. He came built house for children. I forget which Co. you told me he lived in when this done - BUT he KNEW THE AREA. Yet he WAS TRUSTEE IN 1879. He THEN FIRST ARRIVE IN MS ? In Kemper?

MOORE'S

There was NO LILLY MOORE ON 1870 Lauderdale Co Census which further points to CLARKE Co MS.

1870
24
6

YOUR LETTERS

PLAN to check further (LATER) School records. This takes lots of time - re around 1900. These ARE COUNTY School minutes that have NOT yet been indexed - NO FOR he was gone to Med School 1892-1893 - WILL check the next book ANYWAY. He was NOT in Co in 1900.

1880
20
58

SINCE TABITHA COATS WAS WIFE of NATHANIEL + died by 1870 I wonder why she was NOT buried in Hickory Grove. She could have been. We must remember the difficult times after the CIVIL WAR. NO money for GRAVESTONES. The 1860 census will tell us if she was ALIVE in 1860.

I WILL plot NATHANIEL'S LAND ON MAP for you. The 1880 census will give info re NATHANIEL still ALIVE. ALSO remember it WAS IN THE 1880 before local people regained ANY control over their AFFAIRS + OUSTED the carpet bagger etc.

If your grand parents did live in Kemper in 1894 then there is absolutely NO chance of finding the record. The COURT house AT Dabala burned A NUMBER of times - the last fire in 1910. The only old records ARE a 1854 + 1878 LAUDRELL book

BINNSVILLE RINGS A BELL HAVE SEEN IT SOMEWHERE.

The directions were possibly

TAKE Hwy #39 due NORTH of Meridian. Then turn EAST on Hwy 16 toward SCOOBA. You TURNED EAST on #16 AT DEKALB (Present Co. Seat) which is not far from Deleville. SCOOBA NE of Dekalb & 4 miles from Ala Lines. The Road (#16) is the old Gainesville (Sumter Co. AL. not door) SCOOBA Road which in those days WAS USED A LOT - THE ROAD from DEKALB to JACKSON MS WAS known as the JACKSON ROAD (more history!). I THINK I CAN plot the APPROXIMATE LOCATION of BINNSVILLE. THE NAME FAIRVIEW ALSO RINGS A BELL. It very possibly WAS ACTUALLY IN the STATE of ALA. Lots of people back then didn't know if they were in AL or MS. Have found this in Church Histories etc. They didn't pay any ATTENTION to SUCH except the BAD GUYS who knew where the County & STATE Lines were.

There is something re your son NOT giving the name of the school - of WAITING to make TRIP. If he was MARRIED prior to his marriage to Lilly Moore - then perhaps he had memories of his wife's death. Just a thought. No children - did they divorce? maybe getting off they have - but I really like to share my thoughts with people I respect for. There was something in J R childhood or early years that caused him to NOT reflect on it.

J W & MARTHA CHILDREN. FRANCES LEONORA WAS the first child & 7/15/1861. Apparently J R was ABOUT the second child - say & 1863 - so in 1877 he was 14-15 years old, a bit early to MARRY. So perhaps (if the J R who md in 1877 is your JR) he WAS SON of J W by previous marriage - whose real mother was dead. If so he was OLDER. PURE SPECULATION. Why was he close to the TINSLEY'S - WAS his mother A TINSLEY OR did the TINSLEYS fill a void for J R.

Yes the Lizabeth (old Deleville) WAS where Samuel Dake the Pioneer brought the earliest Settlers. NEAR BY WAS the INDIAN VILLAGE COOSA

Lizabeth is about 2-3 miles West of present Deleville.

Will see if I CAN PLOT THE GRAVE YARD WHICH IS OFF OLD HWY 39 WHICH IS NORTH OF PRESENT 39

I THINK THE GRAVE YARD IS IN BETWEEN THE TWO ROADS. THE NEW 39 BORDERS THE NAVY BASE - THE CHURCH PROBABLY ON PRESENT NAVY LAND. YOU MUST UNDERSTAND THAT COMMUNITIES SUCH AS LIZELIA (BACK THEN) COVERED RATHER LARGE AREAS. IT VERY POSSIBLE ONE COULD SEE CHURCH FROM THE MRS TINSLEY'S HOME. SHE PROBABLY LIVED WEST OF PRESENT DALEVILLE - AT LIZELIA
NO TINSLEY ON 1870 LAUDERDALE CO CENSUS

THERE WAS A

WEATHERFORD, MALINDA 50 BLACK F VA WHICH WOULD REFLECT THAT A WEATHERFORD OWNED ONE OR MORE SLAVES

THERE WAS NANCY COATS 76 (1794) VA IN TOWNSHIP 8 BEAT 3 (NO P.O. LISTED). LIVING BY HERSELF IN 1870

273-273 (PAGE 153) 1870 LAUDERDALE CO CENSUS P.O. LOCKHART, T. 8

WETHERFORD, HENRY	40	F AL (1830)
Emily	29	F MS
MARY M	10	F MS
WILLIAM	8	" "
RICHARD	6	" "
CORNELIUS	2 1/2	" "
CORNELIA (7)	2 1/2	" "

LOCKHART NOT FAR FROM LIZELIA - EAST. STUDENT TOOK TRAIN TO LOCKHART - WHERE COOPER INSTITUTE PICKED THEM UP.

LAND

THERE WERE A NUMBER OF WHITE MEN WHO CAME INTO THIS AREA - LIVED + TRADED WITH THE INDIANS. MANY WERE GIVEN LAND BY THE INDIANS + MANY MORE INDIANS.

3132 STILL LATER AFTER THE TREATY OF DANCING RABBIT CREEK (MOXLEE CO MS) THE GOVERNMENT SOLD OR ISSUED LAND GRANTS TO A NUMBER OF PEOPLE. IN 1833 LAUDERDALE CO BECAME A CO IN MS. PRIOR TO THAT IT WAS PART OF CHOCTAW INDIAN NATION. BUT MS BECAME A STATE IN 1817 (COAST + WEST PART)

PRESENT MS. THE LAND CONSIDERED PART OF THE MS
Territory prior to 1833 - owned at one time by the
BRITISH - SPANISH AS WELL AS THE FRENCH.

AFTER 1833 people were suppose to come in
& REGISTER THEIR LAND WHERE THEY WOULD RECEIVE
A CLEAR TITLE AFTER THE LAND WAS SURVEYED. MANY
DID NOT DO THIS. IT WAS AFTER THE CIVIL WAR THAT
ALL LAND CLAIMS WERE SETTLED. THE COURT RECORD ARE
FULL OF SUCH.

I WILL STUDY THE ORIGINAL LAND ENTRY BOOK SOON
AS I CAN - WHICH SHOULD REVEAL SOME INFO

AS STATED ABOVE I THINK THE MOORE'S LIVED IN
CLARK Co MS. TO CHECK THIS

I AM FAIRLY SURE THAT THE HICKORY GROVE CHURCH
& CEMETERY WAS ESTABLISHED AFTER SETTLERS CAME TO THE
AREA - THE FIRST CHURCH WAS NO DOUBT BUILT OF LOGS -
AND TOO THE FIRST CHURCH WAS PERHAPS THE FIRST
SCHOOL. NOW THE CHURCH COULD HAVE BEEN THERE
WHEN YOUR KITTRELL CAME.

COULD THE JOHN CHESTER KITTRELL YOU HAVE ON
JEROME S S ACTUALLY BE JAMES C KITTRELL - NO
JAMES C H 1875. PROBABLY A SON.

THE JOHN KITTRELL IN CIVIL WAR WAS THE
JOHN C.

YOUR 1840 CENSUS INFO NATHANIEL KITTRELL - CHILDREN
UNDER 5 (YES HAS TO BE A SET OF TWINS) MARRIED ABOUT
1834-1835-1836. COULD HAVE MD IN ALA, GA OR SC

LILLY MOORE TEACHING IN 1886-87 SO COMPLETED
SCHOOL PRIOR TO THAT DATE AND FROM YOUR INFO WE
KNOW SHE WAS TEACHING IN 1888, ALSO 1891

SHE APPARENTLY WENT BACK TO COLLEGE AT BINNSVILLE
AFTER SHE HAD TAUGHT FOR AWHILE AT FAIR VIEW. THEN
TAUGHT IN NESHOBAMA Co MS 1892-93.

I WILL CHECK OUT NAMES OF THESE SCHOOLS. SOME I
THINK I CAN LOCATE. HAVE DOUBTS RE. KEMPER Co THO.
THEIR MARRIAGE (DRY LILLY) HAD TO OCCUR IN 1893-94.

Hope I have answered most of the questions you presented.

WILL CONTINUE LATER:

BINNSVILLE WAS LOCATED IN THE EXTREME NE CORNER of Kemper Co ms. It was NEAR THE SUMTER CO & LINE AS WELL AS THE MURBEE CO MS LINE. IT WAS HIGH SCHOOL LEVEL. WENT TO LIVINGSTON, AL Today TO OBTAIN THIS INFO - PLUS CHECK FOR KITTRELLS. NO LUCK RE KITTRELLS. CHECKED WILLS - DEATHS - ORPHANS RECORD ETC. PLEASE SEE MAP ATTACHED

Lilly PROBABLY TAUGHT BEFORE SHE RECEIVED DEDUCE FROM FAIRVIEW OR SHE ATTENDED TO BRADON HER KNOWLEDGE. FOUND OUT THAT MANY OF FAIRVIEW WENT ON TO COLLEGE AT TROY, ALA.

WELL TRY TO GET THIS READY FOR MAILING TODAY. HAVE MORE RESEARCH TO DO - I KNOW OF YOUR INTEREST

CHARGES SO FAR	
TRIP TO LIVINGSTON	\$12.50 (Half price since I did not clear this with you)
RESEARCH TIME JOHN @ 3 ⁰⁰	= 60.00
TOTAL	\$72.50

WILL CONTINUE. HAVE MADE LIST OF OTHER ITEMS TO CHECK. SUCH AS CENSUS RECORDS, LAND RECORD ETC SINCE I AM DOING PRIVATE RESEARCH FOR YOU PLEASE ADDRESS FUTURE CORRESPONDENCE TO ME AT HOME ADDRESS

ROUTE 6 BOX 115
MERIDIAN, MS 39301

IT IS A PLEASURE TO WORK FOR YOU. AM HOPING SOME DEAD WILLS REFLECT WHAT DISTRICT OR CO IN SC. THE KITTRELLS WERE FROM

SINCERELY
Jim Dawson

11/14/85

DEAR MRS WINNARD,

The School WAS PONTA NOT PINTER. I THOUGHT THIS THE CASE. PONTA SCHOOL WAS A ^{FIRST} LOCATED IN THE SMALL AREA BETWEEN THE OLD HWY 39 + THE NEW TWO LANE HWY 39. PLEASE SEE MAP. THIS PONTA SCHOOL WAS LATER CONSOLIDATED WITH OTHERS SCHOOL + MOVED (SEE MAP) TO ANOTHER SITE + NAMED PONTA BECAUSE THIS PONTA SCHOOL WAS THE ONLY ONE IN THE GROUP THAT WAS ACCREDITED - IT IS NOW THE NORTH EAST HIGH SCHOOL

HE NO DOUBT
ATTENDED
MRS
TINSLEY
PRIVATE
SCHOOL
ALSO

NO DOUBT THIS IS THE SCHOOL DR ETC ATTENDED THE SCHOOL HAD NOTHING TO DO WITH THE HICKORY GROVE CHURCH - I MEAN THAT THE CHURCH WAS NOT A SCHOOL TOO AS WAS THE CASE MOST GENERALLY BACK IN THAT PERIOD.

NOW KNOW THAT HICKORY GROVE CEMETERY WAS NOT MOVED. THE CHURCH WAS MOVED SINCE IT WAS ON LAND THE NAVY PURCHASED - BUT ACCORDING TO MRS M E ROYER OF THE AREA, NOT VERY FAR. THE MEMBERS FURLED A GOOD BIT AND THE OLD CHURCH WAS TORN DOWN AND A NEW CHURCH BUILT, IT STANDS TODAY NOT FAR FROM THE MARY BOY LAND LINE - NEAR NAVAL HOUSING AND STILL ACROSS THE ROAD FROM THE CEMETERY.

THE OLD HOUSE (TINSLEY'S) IS NOW ABOUT GONE. MRS ROYER DESCENDS FROM TINSLEY'S + HER GRAND FATHER LIVED IN THIS HOUSE + HE IS THE ONE WHO DONATED LAND FOR THE CHURCH. SHE IS THE OLDEST RESIDENT IN THE AREA - NOT A BAPTIST THO + NEVER ATTENDED HICKORY GROVE BAPTIST CHURCH.

AM NOW TRYING TO FIND OUT IF THERE ARE ANY OLD CHURCH MINUTES. THIS COULD GIVE VALUABLE INFO.

AFTER YOU TURN OFF HWY 39 ON THE NAVY ROAD TO THE BASE YOU CAN SEE GRAVES IN THE CEMETERY

NOW RE PONTA SCHOOL. LEGEND HAS IT AS BETWEEN OLD + NEW HWY 39. BUT IN MY CHECKS OF SCHOOL RECORDS I HAVE IT IN THE SW CORNER SECTION 14 T8 R16W IN 1904-05. WHICH PUTS IT CLOSE TO WHERE MRS TINSLEY LIVED. THE POSSIBLE ANSWER TO THIS W: WHEN FIRST STARTED THE SCHOOL WAS NEARER LIZELIA. MRS ROYER REMEMBER BEING TOLD IT WAS STARTED IN AN OLD REPAIR BUILDING. COULD BE - THEN LATER A BUILDING BUILT IN SW CORNER SECTION 14

1835 LAUDERDALE TAX ROLL

NO KITRELL, WEATHERFORD

MARION: LAUDERDALE-REPUBLICAN NEWSPAPER

2/16/1855 Henry M KITRELL found a horse AND presented it to the Justice of the Peace

Land Grant - ALA - No Kitrell or Weatherford

Early managed Quar Co cl - None

PROBATE COURT MINUTES - LAUDERDALE Co MS 1849-52

Nothing

Reverse Index - Deed Books

Deed Book N Page 666

J W KITRELL bought NW $\frac{1}{4}$ of Section 10 T 8 R 16W from H R Weatherford. This filed on 12/29/1869 + recorded on 2/26/1870 for \$220.00 WAS H R a son of Richard. Could this be DOCK? THIS APPEARS to be the first LAND J W BOUGHT (1870)

Deed Book T PAGE 148

J W KITRELL bought LAND that was being sold to collect money. This was land of Sallie Cole et al. LAND E $\frac{1}{2}$ of SE $\frac{1}{4}$ + W $\frac{1}{2}$ of SE $\frac{1}{4}$ + E $\frac{1}{2}$ of SW $\frac{1}{4}$ Section 10 T 8 R 16W. J W was the highest bidder at \$160.00. PUBLIC SALE of LAND. MORTGAGED LAND.

Deed Book W (1877) Page 334

J W KITRELL bought LAND from B F Brown on 11/20/1876 - 330 Acres in Section 24 T 8 R 16W + Section 18 T 8 R 17W You WILL NOTE ON MAP THAT Section 24 below Sec 13 IN RANGE 16W + THAT Section 18 IN RANGE 17 IN NEXT SECTION EAST of SECTION 13 in R 16W. Close by.

PAGE 16 (same Book)

J W KITRELL purchased LAND from W B Weatherford (failed to get date) who is W. B.?

Deed Book X Page 401

MRS M. A KITRELL bought LAND from J W Kitrell. This on 12/1/1877 for \$800.00 Sec 10 T 8 R 16E
NOTE ALL RANGES IN LAUDERDALE ARE EAST
ALA IS WEST. HOPE I did NOT GIVE INCORRECT E or W.

Direct Index

Deed BK O Page 179 J Kitrell sold land to AC Edwards-

This page MISSING on microfilm copy - Will dig out ORIGINAL BOOK + advising ANYTHING there I caused a stir in Channing Club office today over this

Deed Book R Page 99

JC KITRELL AND JANE his wife - Deed of TRUST to Terry Latham + Co. Mortgage. Jane signed with an X

Deed Book S Page 385

J W Kitrell sold land to Samuel Cole on 1/16/1870

Deed Book T Page 415

J Kitrell sold land to George H young et al (Note ET AL in case you don't know means "and others")

Deed Book U Page 227

JOSIAH KITRELL entered into agreement to pay the Mobile + Ohio Railroad for land. This in Section 36 T 8 R 16W on 3/10/1875. He was to secure the land that he had rented for the past year - with payments over the next 11 months. WAS JOSIAH brother of J W?

Deed Book V Page 11

J W KITRELL SOLD LAND to W B WEAVER there on 12/17/1874 in SECTION 10 T 8 R 16W.

It appears

J W began to sell all his land about 1876 or so.

Deed Book W Page 336

J W KITRELL Deed of TRUST to J W PARKER. MORTGAGED 330 acrs on 12/1/1876

Deed BK X Page 584

J W KITRELL SOLD THE MORTGAGED LAND ABOVE to J W PARKER (330 acrs) for \$1,650.00

Deed Book Y Page 569

NATHANIEL KITRELL gave deed of TRUST to H C Smith + Co on 1/25/1879 - Had debt of \$76.84 - mortgaged land NW 1/4 of NW 1/4 Section 36 T 8 R 16W. Note He signed his

name

Deed Book B Page 345-

R. Weatherford bought land from J P Hill on 1/12/1841
NE 1/4 & SW 1/4 Sec 26 T 8 R 16 E (40 acres)

PLEASE NOTE THAT MARTHA, WIFE OF J W IS NOT ON
ANY OF THE DEEDS WHERE J W SOLD LAND.

MARTHA A NOT A TINSLEY - KNOW SHE WAS A
WEATHERFORD. EVIDENCE IS THE MARRIAGE LICENSE. I GOT
OFF TRACK A BIT IN SPECULATING ABOUT HER BEING A TINSLEY.

THERE IS A LARGE GAP IN THE BIRTH OF JR - 1867
& THE BIRTH OF THE TWINS - NINE YEARS

THE SCHOOL RECORD CHECKED YESTERDAY DID
NOT REVEAL ANY FURTHER INTO

NOW THE BIGGIE!

Deed Book U Page 403

JANE KITRELL AND J W KITRELL WERE INDEBTED
TO KELLY & THOMAS CO. - \$200.00 BY PROMISSORY NOTE
DATED 4/7/1875 AND DUE 10/15/1875. THEY MADE A DEED
OF TRUST TO W PEARL WHO ACTED FOR THE CO (AGENT I SUPPOSE).
THEY MORTGAGED 2 HEADY HORSES, 1 YOKE OF WORK STEERS, 3
MILK COWS + CALVES, 1 3 YEAR OLD HUFER, 2 SOWS AND
5 GOATS - THIS ON 4/7/1875

WAS JANE WIFE OF J W? IT DID NOT SAY HIS WIFE
ON THE DOCUMENT. WHICH IS MOST USUALLY THE CASE
LET'S LOOK AT JOHN W & MARTHA CHILDREN

FRANCIS b 1861, JR b 1867, ATTIE b 1869, Infant son
b 1870 - Minnie & Billie b 1876. THEN IT JUMPS TO
JONES b 1881

NEED TO CHECK CENSUS BEFORE GOING FURTHER.
WE KNOW ONE JANE WAS WIFE OF J C KITRELL

J W KITRELL NOT ON 1870 LAUDERDALE CO MS CENSUS.
YET HE BOUGHT LAND ON 12/29/1869 - RECORDED 2/26/1870.
WHERE WAS HE - IN KEMPER CO. MS? HE BEGAN TO SELL HIS LAND
IN 1876 - YES THE TWINS WERE b.

1840 Lauderdale Co MS Census

2 Shum KITRELL

Males 1- Under 5 years 1- 5 to 10 1- 30-40	Females 2- Under 5 1- 20-30
---	-----------------------------------

He WAS NEAR SAM DALE

NATHANIEL KITRELL

Males 2- Under 5 1- 15-20 1- 20-30 1- 30-40	Females 2- Under 5 1- 20-30 1- <u>60-70</u>	Mother of NAT on Tabitha?
---	--	------------------------------

J.W. has to be one of the 2 MALES UNDER 5 - AS he WAS 14 IN 1850 - See below. Wonder if he had a TWIN. ELISHA would have been 3 + Margaret ANN 1 year in 1840. One the children died.

1850 Lauderdale Co MS Census

			Real Estate	
2-2	NATHANIEL	40	Farmer	\$ 200.00 LSC (1810)
	TABITHA	30	F	LSC (1820)
	John W	14	M	LMS (1836)
	Elisha B	13	M	" "
	Margaret ANN	11	F	" "
	Rosay A	10	F	" "
	Robert B	8	M	" "
	Mary E	6	F	1846 " "
	AMANDA	4	F	" "
	CALADONIA J	2	F	" "
	FRANCES J	1/2	F	" "
				1840 10 70

Next door

1850
14
1836

Isam <u>Kitrell</u>	50	Farmer	t DC (1800)
Jane	35		t DC
James <u>SANDERS</u>	18	Farmer	t DC
Elizabeth <u>Kitrell</u>	14	F	t DC (1836)
John	12	M	t MS (1838)
Eliza A	10	F	" "
Thomas	8	M	" "
Columbus	6	M	" "
Polly	4	F	" "
MARTHA L	2	F	" "

Isam perhaps brother to NATHANIEL. James SANDERS PROBABLY some kin could be JANE son by A 1st MARRIAGE

126-130	Richard Weatherford	53	Farmer	t GA (1897)
	Lucinda A	35		" "
	HENRY R	14		t al
	Frances	13		t al
	MARTHA A	11		t MS (1839)
	ELIZABETH P	9		" "
	GUSTANUS W	4		" "

HENRY or GUSTANUS has to be Dock??

35
2

1860 Lauderdale Co Mrs Census

H 27 412 In household of L D Clanton 65 Farmer t Ga.
 Beat 2 JANE Kitrell 35 Female Domestic Business t MS (1815?)
 P.O. Lauderdale (PROBABLY t in Mrs Territory which could have been in
 Station present Clanton

590-570 J KITRELL 56 FARMER Real estate \$700.00 t SC
 P.O. THIS has to be
 D'ville 2 (sham) KITRELL (Age off a bit but see below)
 BEAT 3

JANE	46		t SC
John C	24	Farm Laborer	t MS
Elizabeth	25	Dom. BUS	t MS? (SC in 1850)
Eliza	20	" "	" "
Thomas	17	Farm Laborer	" "
COLUMBUS	15	" "	" "
MARY	13		" "
DANIEL BW	5	1860	" "
DAVID A	3	18	" "
LOUISA	1	1847	" "
		20	
		67	

746-725 R Weatherford 58 BAPTIST MINISTER \$3,000 t Ha
 P.O. Lucinda A 45 " "
 D'ville Martha A 21 " MS
 William H 13 " "

Nextdoor

747-726 NAT KITRELL 53 Farmer \$600.00 t SC
 Beat 3 TIBITHA 44 t SC
 D'ville John W 24 Farm Laborer t MS
 Eliza P 23 " " " "
 Margaret 19 " "
 Rose P 17 " "
 Elizabeth 14 " " (NOT Listed on 1850)
 ROBERT R 16 77 1860 " "
 AMANDA A 13 61 " "
 CALEDONIA 11 16 " "
 MARY M 8 " "
 WILLIAM W 4 " "
 MOSES 1 " " 1855

FRANCIS must have been deceased in 1860 + ALSO CALVIN

Will get the off to you this afternoon.
 more later
 Sincerely Jim Dawson

(Underlined names have continued lineage in this history.)

by J. V. Kittrell
4805 Foard St.
Ft. Worth, Tx. 76119

FIRST KNOWN GENERATION

I. KITTRELL

Kittrell had atleast two issue that we know of, probably more.

- 11 Isham Kittrell b ca 1805 in S. C.
- 12 Nathaniel Kittrell b 1807 in S. C.

SECOND GENERATION

11 ISHAM KITTRELL

Isham Kittrell b 1805 in S. C. m JANE _____ b ca 1815 in S. C.
Listed on 1840, 50, 1860, 1870 census of Lauderdale Co., Miss.

	1850	1860	1870
James ^(SAUNDERS) Saunders aged 18 b S.C. (1832)	X		
111 Elizabeth Kittrell aged 14 (b 1836) b S. C. (listed in 1870 census as Elizabeth McMillan)	X	X	X
112 John Kittrell aged 12 b Miss. (b 1838)	X	X	
113 Eliza aged 10 b Miss. (b 1840)	X	X	
114 Thomas Kittrell aged 8 b Miss. (b ca 1842)	X	X	
115 Columbus Kittrell aged 6 b Miss. (b ca 1844)	X	X	
116 "Folley" aged 4 b Miss. (ca 1846) Mary on 1860 census	X	X	
117 Martha L. Kittrell aged 2 b Miss. (b 1848)	X		
118 Daniel W. Kittrell aged 5 b Miss. (1855)		X	X
119 David A. Kittrell aged 3 b Miss. (b 1857)		X	X
11A Louisa 6 mo. b Miss. (b ca 1859)		X	

12 NATHANIEL KITTRELL

Nathaniel Kittrell b ca 1807 in S. C. (Wills 1859-1860 of Lauderdale Co., Miss. show #703- J. W. Adm. estate of Nathaniel) m TILISPA b ca 1816 in S. C. who d before 1870.

- 121 John W. Kittrell b 1836 in Miss.
- 122 Elisha B. Kittrell b 1837 in Miss.
- 123 Margaret Kittrell b 1841 in Miss.
- 124 Rose P. Kittrell b 1843 in Miss.
- 125 Elizabeth Kittrell b 1846 in Miss.
- 126 Robert B. Kittrell b 1844 in Miss.
- 127 Amanda A. Kittrell b 1847 in Miss. m D. BROWN in 1875
- 128 Caledonia Kittrell b 1849 in Miss.
- 129 Frances Kittrell b 1851 in Miss.
- 12A Mary M. Kittrell b 1852 in Miss.
- 12B Calvin R. Kittrell b 1853 in Miss.
- 12C Wm. W. Kittrell b 1856 in Miss.
- 12D Moses Kittrell b 1859 in Miss.

-----THIRD GENERATION-----

112 JOHN CHESTER KITTRELL

John Chester Kittrell b 1837/38 in Miss. (Fvt. in Co. C. 5th Miss. Inf- Lauderdale Springs Grey's- which became Co. C. 5th regt of Miss. discharged 12/3/1861 in

ville, Tn. Admitted to Oliver Hospital at Ft. Orange, Ga. 11/25/1862 and transferred to Genesee Hospital at Macon, Ga. 12/16/1864 with leg injury. Decorated for bravery and courage 8/10/1864 after Battle of Chickamauga, etc.)

He married 12/26/1865 NANCY ADALINE WEDGEWORTH b 1/10/1849 in Choctaw Co., Ala. d 9/27/1919 in Lauderdale Co., Miss. burial at Hickory Cem. by her husband (who has only CSA marker-no dates) 2 miles N/E of Lizelia, Miss.

1121 Jennie Kittrell b Miss. 1869 m FRANK SPEEDLEY

1122 John Langford Kittrell b 7/6/1871 in Lockhart, Lauderdale Co., Miss.

d 3/31/1934 burial Hickory Grove Cem. m MINNIE L. CUMMINGS who d 6/20/1973 aged 87 yrs, 4 mo 20 days. Known issue was infant dau. Minnie I. (? 8/3/1907-12/27/1907.

1123 Franklin Thomas Kittrell b 4/12/1872 m (1) Molly Ward m (2) Nancy E. Ruth

1124 Olivia (Levie) Kittrell b 1/10/1873 in Lockhart, Miss. d 10/24/1950, burial in Hickory Grove, Cem. Meredian, Miss. m W. M. TRENT 1921

1125 Andy Kittrell b 1874 in Miss. d Lockhart, Miss. -never married

1126 James Charles Kittrell b 9/8/1875 in Lockhart, Miss. d 2/27/1945 in Meredian, Miss. burial Hickory Grove Cem. m (1) 1906 MARY WILSON m (2) 1914 in Clark Co., Miss. to ADA ESTHER WHITE b 12/7/1893 d 1/16/1964 Known issue of James and Ada: Andy Audrey (11/20/1915-2/10/1934); James Shel Kittrell (5/25/1922-8/10/1972)- all buried Hickory Grove Cem.

1127 Ellen Kittrell b 1877 in Lockhart, Miss. died somewhere in Oklahoma m JESSIE C. WHITE 1908 in Marion, Miss. (bro. of Ada Esther & Charles Ed

1128 Caroline (Carrie Lesner) Lena (?) Kittrell b 12/31/1879 in Lockhart, Miss. d 7/29/1961 in Meridian, Miss. m M. EDGAR RAWSON

1129 Mary Lillian Kittrell b 3/10/1880 in Lockhart, Miss. d 11/3/1915 in Lockhart, Miss. m 1899 FLIM ALONZA RAWSON b 12/27/1876 d 12/1/1952. Known issue: George W. Rawson (10/13/1899-6/4/1901); Melia E. Rawson (10/26/1902-~~6/1/1904~~ 3/26/1904) all buried Hickory Grove Cem.

112A Cas Maxwell Kittrell b 7/4/1881 in Lockhart, Miss. d 3/29/1955 in Meridian, Miss. (buried at foot of sister Levie)-never married.

112B Ralph R. Kittrell b 3/20/1884/5 in Lockhart, Miss. d 3/22/1968 in Ft. Worth, Tx. m (1) 1912 in Tx. ANNA T. KUEOR b 12/29/1890 m (2) 5/10/1965 THERESA M. KUEOR (sister of Anna) - no issue

- 112C Nannie Lee Kittrell b 9/16/1887 in Lockhart, Miss. d 8/7/1956 in Meridian, Miss. m CHARLES EDWARD WHITE 1908 in Marion, Miss.

121 JOHN WASHINGTON KITTRELL

John Washington Kittrell b 1836 in Miss. (adm. of father's will) m 1860 MARTHA ANN WEATHERFORD. Known issue are:

1211 Dr. John R. Kittrell b 12/12/1866 (living 1964 in Laurel, Miss.) m 5/17/1894 LILY MCORE of Lauderdale Co. but reared Kemper Co. who d 1962 & had issue: John R. Jr. deceased- served WW I. W.H. of Montgomery, Ala: Robert H. of Yuma, Ariz.: Grace who m R. B. Irby

1212 Frances Lenora Kittrell b 7/15/1861 d 9/1/1864-burial Hickory Grove Cem.

1213 Attis DeWitt Kittrell b 8/30/1869- d 7/27/1872-Burial Hickory Grove Cem.

1214 Infant son 10/8/1870-10/21/1870- Burial Hickory Grove Cem.

1215 Ma Martha Kittrell 2/11/1877-11/5/1879-burial Hickory Grove Cem.

1216 Jones Wilburn Kittrell 1/9/1891-12/30/1895 burial Hickory Grove Cem.

122 ELISHA B. KITTRELL

Elisha B. Kittrell b 8/10/1837 in Miss. d 7/20/1905 and buried with Masonic Lodge Marker in Hickory Grove Cem. near Lizelia, Miss. m 1857 MARGARET J. RASBERY b ca 1846 in Miss.

1221 Wm. N. Kittrell b Miss. 1868-9 m. MAMIE ODOM 1896
1222 Amanda Kittrell b 1873 in Miss.
1223 Amous Kittrell b 1878 in Miss.

-----FOURTH GENERATION-----

1123 FRANKLIN THOMAS KITTRELL

Franklin Thomas Kittrell b 4/12/1872 in Lockhart, Lauderdale Co., Miss. d 4/11/19
buried Hickory Grove Cem. near Daleville/Linolia, Miss. m 12/17/1892 MOLLY
WARD (dau. of Linzy Ward) b 12/4/1876 d 12/14/1944 also buried Hickory Grove Cem.
He m (2) NANCY EVELYN RUTLEDGE

11231 John Linzy Kittrell b 12/26/1893 in Lockhart, Lauderdale Co., Miss.

11232 Lillian E. Kittrell b 8/6/1896 m (1) J. M. Daniels m (2) Andy White (3) He

11233 Timothy Franklin Kittrell b 12/19/1898 m (1) Mary Lee Brown m (2)

Kizzie Gertrude Rutledge Riley, a widow

11234 Luther Berry Kittrell b 4/6/1901 d 2/1936-burial Hickory Grove Cem.
never married.

11235 Harvey Lennis Kittrell b 9/3/1903 m NELL CAMP

11236 Robert Kittrell b 11/30/1908 m BEATRICE SHIRLEY

-----FIFTH GENERATION-----

11231 JOHN LINZY KITTRELL

John Linzy Kittrell b 12/26/1893 in Lockhart, Lauderdale Co., Miss. m (1) 12/25/19
RUTH LONG b 5/30/1896 d 9/27/1916 near Lockhart, Miss. aged 20 yrs, 8 days
after birth of 2nd child. He m (2) 3/9/1921 COLLIE BROWN b 9/20/1898 near Daleville
Miss. dau. of Jesse Elbert Brown and Nancy Malisa Reid.

Issue by first wife

112311 John Howard Kittrell b 10/19/1913 near Topton, Lauderdale Co., Miss.
m 9/18/1937 in Vicksburg, Warren Co., Miss. LOUISE VAUGHN
b 7/20/1920 in Queen City, Bowie Co., Tx.

112312 Bessie Lucille Kittrell b 9/19/1916 near Lockhart, Miss. m 11/3/1952
in Quitman, Miss. DONALD STANCEL He was in Navy WWII- no issue

Issue by second wife

112313 Mildred Corena Kittrell b 2/24/1922 near Blackwater, Miss. m 1/16/1955
BURTON DEWITT HOD in Birmingham, Ala. b 11/21/1921- no issue

112314 Jesse Vernon Kittrell b 10/10/1923 in Whynot, Lauderdale Co., Miss.
m LOIS LORENE SKAGGS 4/21/1950 in Ft. Worth, Tx.

11232 LILLIAN E. KITTRELL

Lillian E. Kittrell b 8/6/1896 (living 1974) m JULIUS M. (Major) DANIELS
b 9/27/1889 d 5/27/1951- burial Hickory Grove Cem. m (2) ANDY WHITE
m (3) HERRINGTON

112321 Vera Ida Daniels b 1/27/1923- d 5/30/1935-aged 12 struck by
lightening- burial Hickory Grove Cem.

112322 Ruby Daniels

112323 Julius Daniels

112324 Jewel Daniels m CLYDE WARD in 1938

11233 TIMOTHY FRANKLIN KITRELL

Timothy Franklin Kittrell b 12/19/1898 m (1) MARY LEE BROWN b 2/2/1902 d 9/12/1941 - burial Hickory Grove Cem. (cousin to Ollie Brown Kittrell) m (2) KIZZIE GERTRUDE (RUTLEDGE) RILEY, a widow

Issue by first wife:

112331 Edward Kittrell

112332 Ethel Kittrell m 1937 to EMERY W. CULPEPPER

112333 Clyde Kittrell

112334 Earl Kittrell

112335 Everett Brown "Buddy" Kittrell

Issue by second wife:

112336 Larry Edward Kittrell b 1947 (adopted)

112337 Mary Frances Kittrell b 1953 married a HANEY

11235 HARVEY LENNIS KITRELL

Harvey Lennis Kittrell b 9/3/1903 m 5/21/1923 NELL CAMP b 10/29/1904

112351 Carolyn ~~Ray~~ Kittrell b 10/14/1924 d 7/1/1933

112352 Fay Elizabeth Kittrell b 12/19/1931 m HERMAN DEAN VICK & had issue:

Michael Dean b 3/11/1953; Thomas Randolph b 4/25/1958

112353 Tommie Wayne Kittrell b 9/22/1943 m JERRY LYNN SAULS and had issue: Stacey Lynn Kittrell

11236 ROBERT KITRELL

Robert Kittrell b 11/30/1908 m 5/25/1931 BEATRICE SHIRLEY b 5/30/1910

112361 Audrey Kittrell b 3/11/1922 m LAWRENCE DAVID BURKHALTER 10/31/1950 (a mortician) and had issue: Jefferson Lee Burkhalter

112362 Donald Kittrell b 11/4/1947 m 6/3/1970 CATHY ALCOCK now living in Lewisville, Miss. (1973)

-----SIXTH GENERATION-----

112311 JOHN HOWARD KITRELL

John Howard Kittrell b 10/19/1913 near Topten, Lauderdale Co., Miss. m 9/18/1937 LOUISE VAUGHN in Vicksburg, Warren Co., Miss. She b 7/20/1920 in Queen City, Bowie Co., Tx.

1123111 Wm. Howard Kittrell b 6/22/1938 m 7/12/1957 in St. Paul's Catholic Church, Vicksburg, Miss. FORTHY FAYE LOGUE b 8/17/1939
Had issue: Steven Hugh (4/1/1963-4/3/1963); Wm. Howard Jr. b 3/30/1960 in Jackson, Hinds Co., Miss.; Glen Allen b 11/25/1965 in Vicksburg, Miss.

RE THE KITTRELL CHILDREN'S SCHOOLING

Mrs. Tinsley - Was something like Aristocracy in that area.
She had a private school in her home.
She asked John Robert, Minnie and Lillie to attend the school.
The Kittrell children went from her school to Cooper Normal School.

John Robert Kittrell was a good friend of one of the Tinsley daughters - a spinster - and used to go to visit her.

You could sit on Mrs. Tinsley's front porch and look down the hill at Hickory Grove Cemetery.

The cemetery was owned by the church.

An Air Base was formed during WWII. ?
It took over the church but did not take over the cemetery.

The church was 1st moved and then torn down.

John Robert Kittrell very much wanted a pew from the church - but he did not get one.

Goat Hill's

*The Navy moved out
around cemetery*

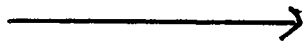

FAIRVIEW MALE AND FEMALE COLLEGE

BINNSVILLE, MISSISSIPPI

Don't bother looking for Binnsville on a Mississippi map. I understand it simply is not there.

I became confused trying to write the directions as my sister gave them over the telephone. She will send them to me in writing. The directions are something like due north of Meridian on highway # something or another - and then turn east on highway # something else - something like, in the direction of Shabuda (?). Continue literally to the Ala. state line. On the state line is a small country store with one gas pump. That's Binnsville. Fairview College has long since gone the way of all good things. However, the elderly gentleman at the little store, whom John Robert Kittrell and daughter Grace interrogated, said that his house was a Fairview College dormitory. He had no further information to give.

500084

I don't even know what country this is in -

The gentleman suggested that John Robert go across the state line into Alabama and talk with someone who could probably give him some definite information.

John Robert and his daughter followed his directions - but were never able to locate the gentleman with whom they were supposed to talk.

It is rather interesting that John Robert should have waited so late to make this sentimental journey.

RE THE "LOG" HOUSE AT DALESVILLE, MISS.
THAT TURNS OUT NOT TO BE LOG.

The "Log" House was NOT a log house at all - but a small FRAME house.

Grace Kittrell (Irby) can not believe she said the house was made of "logs" - but she certainly did.

The house is small - it consisted of 4 rooms.

The house is on "Main Street" -

It is across the street from the site of the old Cooper - which is now the location of the "monument" -

and "down or up" the street less than 1 block - more like $\frac{1}{2}$ block.

It is Grace Kittrell's impression that standing in front of the "monument" and looking across and down the street - you can't miss the house.

According to Grace Kittrell (Irby)'s best recollection, the little house has always been occupied.

RE THE LAND OF NATHANIEL KITTRELL

AND

JOHN WASHINGTON KITTRELL

*They lived AT
Lizely in
Cold Springs*

When John Robert Kittrell and his daughter visited Hickory Grove cemetery, they went "down the road" "about a mile - or maybe just $\frac{1}{2}$ " - to the land that belonged to his grandfather, Nathaniel Kittrell, and his father, John Washington Kittrell.

According to John Robert Kittrell, you could sit on the front porch of both houses and look at the cemetery and the church.

With the cemetery at his back, John Robert first went to the right "side of the road" which was the house his father, John * Washington Kittrell, built.

Then he went "across the road" - and exactly opposite was the "big house" his grandfather, * Nathaniel Kittrell built.

That was the house where John Robert Kittrell was born.

In that area there was a road sign that said something like:

"LIZELY" *LIZELY*

That is probably not correct - but it is as close as 90 yr. old Grace Kittrell (Irby) can remember.

John Robert Kittrell said that all that he remembered as a child was built around the church and the cemetery.

MORE ABOUT LAND

According to John Robert Kittrell, Richard Weatherford - son of Chief Weatherford Red Eagle and his Indian "Princess" wife - and his wife, Lucinda Furlow, lived within a mile - or probably more like $\frac{1}{2}$ mile - of Nathaniel Kittrell.

(In reading the 1840 Lauderdale County Census, I became so excited over Nathaniel Kittrell and his household, that I forgot to look for Richard Weatherford.)

Nothing is known re the household of Richard Weatherford and Lucinda Furlow except that they had a daughter, Martha Ann Weatherford, who later married John Washington Kittrell - and bore John Robert, Minnie and Lillie (twins) Kittrell - as well as 5 others who died in childhood.

Richard Weatherford and Lucinda Furlow also had a son - named, or called, "Dock" who later married John Washington Kittrell's sister, Ann Kittrell. "Dock" Weatherford later became the grandfather of John Weatherford - who with his wife, Colleen, lived on the gulf coast. John Weatherford died in the early '80ies. His wife is still living at Gulfport, Miss.

Nothing more is known re Weatherford offspring.

It is assumed that Richard Weatherford and Lucinda Furlow were buried near their home - in Hickory Grove Cemetery.

Lucinda

1840 Census

But name

*Look for Weatherford
in census*

W. John Stone

FAMILIES AND FRIENDS

As John Robert Kittrell and his daughter, Grace, made their yearly pilgrimage to Lauderdale County - and particularly to Hickory Grove Cemetery, John Robert pointed out spots familiar from his childhood.

According to daughter Grace, her father never talked about his home, his family or his growing up years. Such behavior is not only weird and unnatural - but is certainly unfortunate. He must have known his grandfather Nathaniel well - and could have left the most intimate bits of information re early Lauderdale County.

John Robert Kittrell did say that all that he remembered well from his childhood was located around the cemetery and the church.

Certainly the Kittrells, the Weatherfords and the Moores lived near each other - and near the cemetery and the church. These families that started as friends - later became inter-mixed as the next generation of boys and girls married.

Which was the chicken and which was the egg?
Did the families settle in that locale because the church and cemetery were there - or did the cemetery and church come into being because the families were settled there?

1877
63
14

CHARLES JEROME KITTRELL

Jerome Kittrell reported that his parents died when he was very young and he knew little about his family's history. I felt sure that there was a connection between the two lines and Jerome and I have set out to learn as much as possible re the early Kittrells in Lauderdale.

From a (Kittrell) Aunt, Jerome knows that his great great grandfather came from S.C. to Miss. (date unknown) and that his great grandfather, John Chester Kittrell, was born in Lauderdale County 1837/38. John Chester was buried in Hickory Grove Cemetery. The grave marker gives no date of death.

The above follows so closely the account of John Robert Kittrell re his father, John Washington Kittrell, that it was hard to believe that there was not some connection.

In the 1840 Census, Nathaniel Kittrell was the only Kittrell reported in Lauderdale County. His household contained 2 males under the age of 5 yrs. - and 2 females under the age of 5 yrs.

I have not yet received the 1850 census. However, it seems a good guess that the 4 children - under the age of 5 yrs. - include 1, or even 2, sets of twins.

I am guessing that the 2 little boys were John Washington and John Chester Kittrell.

Kittrell's - Boy's

1. Father (Dad) Nathaniel Kittrell (Children) John, Martha Weatherford
79 (Wife died when Amanda was 6 yrs old)

married:
Elish Aunt Muz
Billy - Matt Lowry
Grudder died 15 yrs. old
Rosa - Killed in War.

Nathaniel Kittrell (married)

2. John Kittrell (Children) Robert, Minnie, Lillie, Wilburn.
Valentine, Pack

John ^{W. Weatherford} Kittrell married Martha Weatherford.

~~3. John Kittrell (Children) Anna, Charlie, Waco
girls: Clara, Lela, + Cora~~

Lillie Kittrell married "Aunt Muz"

4. Billy Kittrell (Children) boys: Eddie, Clarence + Louis
girls: Annie, Ollie, Betty, Katie, Mattie
+ Lula - GIBSON.

Billy Kittrell married Mattie Lowry

- 5. Grudder ^{Kittrell} died 6 or 7 yrs of age -
- 6. Rosa Kittrell died in battle never knew any more -

Kittrell Girls -

1. Margaret Kittrell Children Mattie ^{Hines} married Colby Clay
Willie ^{Hines} " Will Clay

Willie Clay's brother Spurgeon ^{Clay Sr.} & the father of Spurgeon
Clay Jr.

Margaret Kittrell married Joe Hines ^{2nd} - married Judie Hanagan

2. Fannie Kittrell (13 children) Lessie married Griffis

Boys: Ben
Lon
Joe
Ed +
Hugh

Mattie died
Lula married Walker
Ora - Green
Minnie a Fredrickson
Lillian a Miller

Fannie Kittrell married E. Ligea Green

3. Ann Kittrell Children - Charlie Weatherford

Ann Kittrell married Dock Weatherford - died away from home.

4. Elizabeth Kittrell (Children) Calvin?

Elizabeth Kittrell married George ^{or Bill} Payne ^{went to Tex. never came back}

5. Mary - died small.

6. Callie Kittrell (Children) Robert

Girls: Mamie

Killa - ~~from~~

Annie

Eric

June

Ben

Callie Kittrell married Hugh Sharp

born 1846
7. Amanda Kittrell (Children)

no children → James Albert Brown - He was a physician
in Memphis, Tenn. married Mary

Cliff, Ethel, Clyde, Lucille, Homer,
Helen, Edna, Alice, Ola + Bill → Mollie Lee ^{married} - Ewell Parker

Walter, Barney, Glen + Cett → William Lee ^{married} - Nannie Parker ^{2nd marriage} Emma Ross

Mollie Lee, John, Alvin + Robert Earl → Ida Frances ^{married} - Joseph Robert Hedgpeth 4-29-1913

Joseph R. Hedgpeth ^{married} Leora ^{1st time} ^{1st time} → Shelton Elisha ^{married} - Lela Puckett + Mary Sue
Russell
of Nashville
Tenn.

(Amanda Kittrell married David Wesley Brown)

Mollie Lee Hedgpeth Waddell's Grand Mother + Grandfather
David Wesley Brown was in Smith Co. at

~~was in Smith Co. at~~
I did + was buried there in some Cemetery -
Albert Brown (his son) rode horseback
to see about him in Smith Co. He was the
only one went - Had no way of traveling
in those days.

Amanda Kittrell Brown is buried at Hickory
Grove Baptist Church in Lauderdale Co.

Nathaniel Kittrell (I have never heard any name except "Nathaniel")
 was born in Orangeburg District, South Carolina
 c. 1810 (date unknown)

He migrated from South Carolina to Mississippi in the
 early 1830ies when he was in his early 20ies.

If he had been married in South Carolina, John Robert
 clearly knew nothing about it.

Nathaniel Kittrell married Tabitha Coats in Lauderdale
County, Mississippi (date unknown)

based on the 1840 census, it would seem that they must
 have been married around 1835 or before.

I know nothing re Tabitha Coats except the name. Assume
 her family lived in Lauderdale Co. but do not know so.

Tabitha Coats was born in South Carolina (whether Orangeburg
 District is not known) (date of birth unknown)
 born: probably c. 1820+

1840 Lauderdale County Census (There were 9 in the household and
 Household of Nathaniel Kittrell Nathaniel was HEAD)

<i>* this does not look like "Seem" because he would have been 45 in 1840</i>	1 Male	20-30 yrs.	(I guessed it was Nathaniel)
	1 Male	15-20 yrs.	(Is this a younger brother?)
<i>*</i>	1 Male	30-40 yrs.	(Maybe an older brother?)
<i>John Washington married Martha Ann (Amanda) Weatherford -</i>	2 Males	Under 5 yrs.	(I thought these were John Washington and John Chester) <i>b. 1836</i> <i>b. 1837(?)</i>
<i>never 20 yrs. old if she bore children to 1857 (William W.)</i>	1 Female	20-30 yrs.	(I guessed this was Tabitha)
	1 Female	60-70 yrs.	(Nathaniel Kittrell's mother or mother-in-law)
	2 Females	Under 5 yrs.	

(In 1870 these 4 children would have been past 30. There-
 fore there were at least 4 additional children:)

<i>Ann (Amanda) "shell" married "Doc" Weatherford - Martha Ann's brother -</i>	Margaret	b. 1843	<i>Nathaniel - b. S.C. 1810</i>
	Amanda	b. 1850	<i>In 1870 - Tabitha Coats</i>
	Calvin P.	b. 1854	<i>was deceased -</i>
	William W.	b. 1857	

I have not gotten to look at the 1850 Census - so I still do
 not know the names of those 4 children under 5 yrs.

The Elisha Kitrell (32) born Miss., 1838 living next door to Nathaniel Kittrell (in the 1870 Census) does certainly look like the other of those 2 male children under 5 yrs. in the 1840 Census. (The 1850 Census will surely give the names of both.) If the 1st 2 sons of Nathaniel were John Washington and Elisha - where in the h-- is John Chester (born in Lauderdale Co. in 1837?) I found only 1 Kittrell in Lauderdale Co. in 1840 and that was Nathaniel and his household of 9.

It looks like Nathaniel had 4 sons:

John Washington *1836* The 3: Elisha, Calvin R. and
Elisha *1838* William W. might explain the
Calvin R. *1854* sharp increase in Kittrells in
William W. *1857* Lauderdale Co. I wish I knew who

and

4 daughters:

2 names unknown under 5 yrs. in the 1840 Census *1835-40*
Margaret *1842*
Amanda (Ann) *1850*

E.B. was. I don't see any name that looks even vaguely like those initials.

5

I have never heard any suggestion that Nathaniel Kittrell ever married but once. But then obviously I have heard very little about Nathaniel Kittrell except that he came to Miss. as a young man from S.C., that he settled in Lauderdale Co., married in Lauderdale Co., lived and raised a sizeable family in Lauderdale Co. and died and was buried - no one seems to know where.

John Robert Kittrell was certain that Richard Weatherford and his wife Lucinda Furlow (both born and also married in Ala.) lived less than $1\frac{1}{2}$ miles from Nathaniel Kittrell and the two men were friends. (It would seem that Richard Weatherford - son or grandson of Chief Weatherford Red Eagle and his Indian "Princess" wife - had returned to the village lands of his ancestors and lived there the remainder of his life.) There was no connection between the Kittrells and the Weatherfords except friends and "neighbors" until their children married.

I feel equally sure that there was no connection between the Kittrells and the Tinsleys except that they were neighbors. John Robert attended the private school in Mrs. Tinsley's home and he and the Tinsley off-spring were friends. He maintained the friendship with only one - a spinster daughter.

From the description I have been given, it is my understanding that the Weatherfords, the Kittrells and the Tinsleys all lived fairly close to the Hickory Grove Cemetery and Church. I assume that in that day, anyone within a couple of miles would have been called "neighbors".

John Washington Kittrell - son of Nathaniel Kittrell and Tabitha Coats

born 15 May 1836
Lauderdale County - near Meridian
died 28 February 1917
Laurel, Mississippi
buried Hickory Grove Cemetery
Kittrell Plot
Laurel, Mississippi

John Washington was in the army during the Civil War and was a prisoner of war somewhere in the north. He drew a small confederate pension - something "like \$13.00/month."

The Civil War evidently explains the 5 yrs. between the 1st 2 off-spring, Frances Lenore and John Robert. Also the fact that all were born in the

grandfather's home. John Washington evidently did not build his "home" across the road until later

m. Martha Ann (Amanda) Weatherford
born 17 November 1838
Lauderdale County - near Meridian
died 17 March 1915
Laurel, Mississippi
buried Hickory Grove Cemetery
Kittrell Plot
Laurel, Mississippi

John Washington Kittrell and Martha Ann Weatherford had 8 children. Only 3 lived to adulthood:

ALL OF THE CHILDREN WERE BORN IN NATHANIEL KITTRELL'S HOME!

- 1. Frances Lenore Kittrell (1861) died at 3 yrs.
- * 2. John Robert Kittrell (1866)
- 3. Attis Dewitt Kittrell (1869) died at 3 yrs.
- 4. Unnamed Infant Son (1870) died at 13 days
- * 5. Lillie Kittrell > (1874) Jones
- * 6. Minnie Kittrell >
- 7. Ila Martha Kittrell (1877) died at 2½ yrs.
- 8. James Wilburn Kittrell (1881) died at 14 yrs.

#1, 3, 7, and 8 died of diptheria

#4 either birth injury - or premature birth.

The 5 children were buried Hickory Grove - Lauderdale County - near Meridian.

(John Kittrell - Company 5 - Miss. Inf. CSA - no date -) (Later in your notes you said this was "John C." how do you know that?)

August 1860 by Thomas J. Hend, Minister of the Gospel - License issued on 1 August 1860. Bondsmen - J. W. + C. C. Inawick Bk 1 P. 115

Jim Dawson gave this name as "Jones" Wilburn - →

5

Except for the stint in the Confederate Army, there is no indication that John Washington Kittrell ever lived anywhere but in Lauderdale Co. - within sight of Hickory Grove Church and Cemetery, until he and his wife moved to Myrick in 1895.

According to John Robert Kittrell, his father's house was "across the road" from his grandfather's house - and both were in sight of the church and Hickory Grove Cemetery. (It is assumed that John Washington's land was given to him by his father but John Robert Kittrell did not say so.) He did say that he and his brothers and sisters were all born in the grandfather's home - so John Washington's house must have been built later.

In March 1896, John Robert Kittrell completed his (internship) apprenticeship and he and his wife and 6 wk. old son, John Moore (my father) went to Myrick community (I think in Jones county) for John Robert to begin his medical practice. Shortly there after, John Washington Kittrell and his wife, Martha Ann (Amanda) Weatherford moved to Myrick to be near their son. They had their own house near their son and did not live in the home with him. How John Washington Kittrell disposed of his land in Lauderdale County is not known.

In 1908 John Robert Kittrell and his wife, Lilly Moore, and their 4 children moved to Laurel so that the children could have proper schooling. They bought the home at 1038 First Ave. and it is still the Kittrell residence today. The daughter Grace and youngest son Robert occupy the home. When the John Robert Kittrells moved to Laurel, John Washington and his wife moved also. They had their own home near by and did not live in their son's home.

John Washington out lived his wife by 2 yrs. He was then 80 and it is understood that the last 2 yrs. of his life he did live at 1038 First Ave.

In short John Robert Kittrell lived in close contact with his mother and father almost every day of his life - except when he was in medical school - until he was 50 yrs. old. That he "never talked about his parents or his home" - and further seemed to know little personal about them can only be described as weird.

6

The Kittrells were a family who talked constantly and John Robert was famous for his little stories about a wide assortment of interesting people he had met here, there and yonder - but as a grand daughter, I can testify to the fact that I never once ever heard him talk about his parents - or his grandparents.

On the surface they all sound like good, hard working, upstanding people. As a clinical psychologist, I just assumed that - for reasons I will surely never understand - they simply did not like each other very much.

John Robert Kittrell talked at table about himself and he told little stories about his and Lilly's courtship - but his stories were generally about medicine and his medical practice - or about people outside of the family.

The Tinsleys were "neighbors", church friends and school mates. It is interesting that, on his yearly jaunts "home" John Robert regularly visited Old Friends.

Every year he drove back to Hickory Grove Cemetery to check on the large grave marker for the 5 little Kittrell children. When he was much older and did not drive, his daughter Grace drove him. Only one of the children lived to 14 yrs. The others died at 3 or under. Such concern for siblings he certainly did not know - yet all claim to have no idea when Nathaniel and Tabitha Coats died - or where they were buried. If John Robert was correct that his grandparents lived within sight of Hickory Grove Church and Cemetery, it would seem reasonable to assume that they were buried there.

The trips to Dalesville and Binnsville had nothing to do with family - but rather John Robert's and Lilly's experiences separate and apart from family.

I know nothing to be gained by trying to speculate re the causes for such family indifference - but it is a fact that the Kittrells showed as little family feeling as any I have ever encountered. This same disinterest is shown by the siblings.

Whatever the problem was, it clearly had to do with the parents and their relationship with their off-spring, because John Robert had - and showed - great love for his 2 living twin sisters and for their children. After Lilly's death, the remaining twin came to live in the home with her brother and was cared for by the daughter Grace and her husband.

8

John Robert Kittrell - 2nd son of John Washington Kittrell
and Martha Ann (Amanda) Weatherford
and the only son who lived to adult-
hood.

born: 12 December 1866

In his grandfather, Nathaniel Kittrell's home
Lauderdale County, Miss.

In sight of Hickory Grove Church and Cemetery

died: 22 September 1966

Laurel, Mississippi

Buried: Hickory Grove Cemetery

Kittrell Plot

Laurel, Mississippi

John Robert spent his childhood in his grandfather's home and in his father's home just "across the road" from the Grandfather. Yet almost nothing is known re John Robert's growing up years.

It is known that John Robert attended school in the private school in Mrs. Tinsley's home - near his own home. But it is not known how long he attended that school - or whether he also attended other schools.

It is known that John Robert and his twin sisters, Lillie and Minnie attended Cooper Institute/Normal College - but it is not known for how long or precisely for what years.

It is a fact that while attending Cooper, John Robert and his sisters lived in a small frame house across the street from the school and down a half block or so - a house that John Washington Kittrell built for his children. (Jim Dawson referred, in his notes, to John Robert's living at Dalesville while he was teaching school. That would seem to indicate that John Robert did not return to his father's home after he finished school - but continued to occupy the small house that had been built for him.)

9

It is a fact that John Robert and his sisters are listed in the Roster Of Students at Cooper in 1886. (This seems a contradiction to the fact that "J.R. Kittrell was paid \$114.00 for teaching school - 1886-87 - name of school not given.) This can be explained only if one assumes that John Robert taught while finishing the teacher's course at Cooper.

From the notes sent by Jim Dawson it is definite that John Robert was actively teaching from 1887 until he entered Medical School at the University of Tenn.

Whether John Robert had any contact with his parents and home during these years is simply not known since there was never any reference to them.

Clearly John Robert was not the J.R. who married Alice Weston in 1877. At that time he was only 11 yrs. old. I think it is safe to say that John Robert Kittrell married only once - Lilly Moore - and they had been married some 67 yrs. at the time of Lilly's death.

John Robert attended the U.T. Medical School, completed the apprenticeship (internship) and around the 1st of March 1896, he and his wife and 6 wk. old son (John Moore) moved to Myrick Community for John Robert to begin his medical practice. They were at Myrick until 1908 when they moved to Laurel and bought their one and only home at Laurel at 1038 First Ave. Three Kittrell children: Grace, Hantz and Robert were born while the family were at Myrick.

John Washington Kittrell and his wife Martha Ann Weatherford moved to Myrick to be near their son - and in 1908 also moved to Laurel. They died at Laurel and were buried there.

According to John Robert and Lilly Moore Kittrell, their 1st son, John Moore, was born in Kemper Co. near DeKalb.

Lilly Moore

born: 6 June 1867

In Lauderdale County - near Meridian
grew up in Kemper County near DeKalb.

She was the daughter of John Alexander Moore
and Melissa O'dell Arrington.

Nothing is known about Lilly Moore's home and family
and/or her growing up years except that she had
6 brothers and sisters. Lilly Moore talked no
more about her parents and grandparents than did
John Robert - and Lilly's off-spring insist
that they know nothing at all about their grand-
parents in spite of the fact that they lived in
the home at 1038 First Ave. for many years until
their death. Grace Kittrell must have been 20+
when her Moore grandmother died and yet she claims
to know nothing at all about her.

Nothing is known about Lilly Moore's growing up years
except that she was educated at Fairview Male
and Female College - Binnsville, Mississippi.
She must have taught school for some 6 or 8 years.

She and John Robert were married May 1894 at DeKalb.

Lilly taught school as Mrs. Lilly Moore Kittrell
and then in March 1896 Lilly and John Robert and
their 6 wk. old son moved to Myrick.

The baby, John Moore, was born 13 January 1896
in Kemper County near DeKalb. It is assumed that
Lilly's parents were in Kemper County near DeKalb -
and perhaps this is where Lilly spent her pregnancy.

Lilly Moore died: 21 April 1962

At Laurel, Mississippi

She was buried: Hickory Grove Cemetery

Kittrell Plot

Laurel, Mississippi

At the time of her death, Lilly Moore and John Robert Kittrell
had been married app. 67 yrs. Lilly Moore was 95 yrs.

//

As I type this I think of questions I would especially like to know the answers to:

1. When and how did Nathaniel Kittrell obtain his land?
2. Is there a recorded deed?
3. Did Nathaniel Kittrell leave a will?
4. When and how did John Washington Kittrell obtain his land?
5. Is there a recorded deed?
6. Did John Washington Kittrell leave a will?
7. How did John Washington Kittrell dispose of his land when he followed his son to Myrick in 1895?
8. When did Nathaniel Kittrell and Tabitha Coats die and where were they buried?
9. Is there any indication of what Nathaniel Kittrell and John Washington Kittrell did to earn a living?

Where deeds and wills and marriages are recorded, I would very much like to have a photostat copy if that is possible.

118
Walter D. Brown, Jr.
Capt. Co. 6 71 Regt. Quar.

MEDICAL CARD NUMBERS.

168764
27720

Foot Note:

123
Walter D. Brown, Jr.
Capt. Co. 6 71 Regt. Quar.

W 412 U.S.A. Gen'l Hosp.,
Chattanooga, Tenn.

123
Walter D. Brown, Jr.
Capt. Co. 6 71 Regt. Quar.

Months

W 412, 1864

Transferred to duty, 18

Transferred to I.C., 18

Transferred to, 18

Discharged, 18

Discharged from service, 18

Died, 18

Re-advanced from furlo' or des'n, 18

Remarks:

Form Reg. No. 19, Hon. No. 831, Page

123

123
Walter D. Brown, Jr.
Capt. Co. 6 71 Regt. Quar.

Completed

123
Walter D. Brown, Jr.
Capt. Co. 6 71 Regt. Quar.

W 412, 1864

Transferred to duty, 18

Transferred to I.C., 18

Transferred to, 18

Discharged, 18

Discharged from service, 18

Died, 18

Re-advanced from furlo' or des'n, 18

Remarks:

Form Reg. No. 19, Hon. No. 1094, Page 32

123
Walter D. Brown, Jr.
Capt. Co. 6 71 Regt. Quar.

Do you have death date of Rose.

If I have any of the above inventory please advise me.

By the way on the 1860 census

759-738 Nancy Coats 64 Farmer 800 400 + Va
Joel Foster 25 h al
TC Foster 22 h ms

Next door

H H Foster 30

Abeline 25 and their children

We will have to rule out Henry Weatherford
There was no female Weatherford in Richard's
household at the time so J W could not
have had an affair with MA sister?

For Richard to sell land to J W - a Weatherford I feel
had to be involved.

We may never know many but we are closer
than we have been. J R had J W son so he put him
down with perhaps others consent as Nat son & then it is
possible that the family only knew that Nat estate owed money
to J R - the son of their deceased sister.

Will continue - Will examine 1880 census and
search for J W, MA & J R in 1870

Have put 20 hrs recently. 20 x 3 = \$60.00

I missed Decca today. Failed to hear last night. Checked to see if they
were OK after the storm. Had to be out some this AM & I
probably missed their call. We had planned to get together for coffee
before they left. Will be anxious to hear what they found out

Sincerely
D.

your wife I was caught of what I
saw around and then

Dear Mary

Am going through Confederate papers:

R B enlisted 2/8/1862 at Marion Station

for 3 years or (period) of War

Probably
came home
1w or
few days

He was paid on June 30 1863 - Present + paid 10/31/64

He was on leave for 20 days on order of General Johnson

Re enlisted 1/29/1864 for (period) of War

Wounded + Captured on 7/28/1864

Admitted to U.S.A. Gen Hospital Chattanooga Tenn
from the front on 11/1/1864. His age was 27 (b 1837)

(This the last entry. He could have died here.)

He had been admitted on 10/13/1864 to hospital at
Atlanta Tenn for gun shot wound in left hip - was
transferred to Northern Hospital on 10/30/1864

E B enlisted same date as R B - same or company
at Marion Station (The then County seat). Later in 1862
he was home on sick leave

Sent to hospital by Chy Surgeon on 9/20/1863
after being wounded at Chichamanset

Re-enlisted 1/29/1864 (The same day R B re-enlisted)

Apparently they became separated after R B Capture -
E B served out the rest of War and returned home

R B probably buried somewhere around Chattanooga -
Usually the form gives the death date

J W enlisted 8/1/1861 at Enterprise, which is in
Clade Co MS - south of Meridian. Sometime between
May 1 - Aug 31 1864 he was (it appears) he joined. This
unit by transfer since last muster. He was wounded
in battle near Atlanta on 7/22/1864 + sent to
hospital by the Chy Surgeon. R B wounded and Captured
7/28/1864

All 3 apparently in some outfit. J W left
hospital + came home as he was here in Dec 1864.
The war over officially in 1865. J W was not in

Laurel Church Is Honoring Dr. John Kittrell Today

By LAUREN SCOTT
Star Correspondent

LAUREL, Miss. — The First Methodist Church of Laurel is today observing "Dr. John R. Kittrell Day," honoring Dr. Kittrell, who yesterday celebrated his 93rd birthday.

Dr. Kittrell still a regular attendant at morning services of the church is its oldest member. He has served on the official board of the church since coming to Laurel in the early 1890s and along with his wife, who until her death in 1962, have reared their family in the church. He is presently an honorary member of the Board of Stewards.

Dr. and Mrs. Kittrell were the parents of four children: Dr. John Kittrell, deceased; W. H. Kittrell, Montgomery, Ala.; Robert Kittrell, Yuma, Ariz.; and Mrs. Grace Kittrell, R. 1, Edge, Mrs. Abby Wilson with her husband make their home with Dr. Kittrell on First Avenue was a first grade teacher in the Laurel City Schools for a number of years until she retired. She also served as organist for the First Methodist Church for a number of years.

WWI Veteran

During World War I, both Dr. Kittrell and his son, the late Dr. John Kittrell served in the U.S. Army. He was stationed in San Antonio, Tex., where he held the rank of Captain in the Medical Corps and was on route to New York for embarkation when the Lusitania was sunk by a German submarine.

of his elder sons are veterans of World War II. He is a member of the Meridian



DR. JOHN R. KITTRILL

Indian area. With his wife and young son, John, came to Alvirka, some six miles east of Laurel in 1901, where he hung out his first shingle. Arriving on the newly constructed New Orleans and Northwestern Railroad, now the Southern Railway, they disembarked at Sandersville, and continued their trip by horse and buggy to Alvirka.

Alvirka was then a bustling settlement composed of churches, stores, saloons and a general store. In the late 1890s, however, measles or measles fever, mumps and other diseases and epidemics and mumps in the spring. "Then the hood", were prevalent.

The doctor says he was never a member of the Meridian

he was the son of John Washington, studies at Cooper's Institute, becoming a boarding school for a few years. While teaching school, his early education was from attending at Iron Springs School, in Lawrence, Miss. Willie Finley, Nashville County, he met his wife, who was teaching the children of her father, a native of the locality in the home of a lander in Lawrence County, but who was neighbor.

Wanted To School

Later he wanted at Cooper's Institute, a boarding school, he entered at Danville. He himself was a day pupil, working several miles each day to the school. He recalls that one night, when he should have been studying for an examination, he and a group of young people "went away for hours", playing cards. When he returned to the school and received the news that he was unprepared for the exam, he was disappointed. He recalled that one night, when he should have been studying for an examination, he and a group of young people "went away for hours", playing cards. When he returned to the school and received the news that he was unprepared for the exam, he was disappointed.

His feelings for intoxicating liquors are abated, the same time. Dr. Kittrell says "I am not a radical on whiskey, but since becoming a grown man, I have never had a drop of liquor in my mouth and there has never been a drop in our home."

A Teacher Too

After completing his course of

Miss Moore was employed to act as his assistant teacher at the school. In fact he and the principal, assistant teacher were married May 17, 1894, and she recalls that one night, when he should have been studying for an examination, he and a group of young people "went away for hours", playing cards. When he returned to the school and received the news that he was unprepared for the exam, he was disappointed.

It was after marriage — Mrs. Moore was an ardent Methodist. Dr. Kittrell was the sister of a Methodist minister, the Rev. H. J. Moore, pastor of the First Methodist Church of Blount.

Dr. Kittrell received his medical training at the University of Tennessee Medical School, then located at Nashville. He is one of the few possessors of a transcribed Golden "T" — awarded by the university on his fifth anniversary of practice.

A Frightened Doctor

The doctor tells a number of

practicing stories about his early practice — days of walking when the couldn't ride to the patients. He tells of going through the swampy one night that he should have been studying for an examination, he and a group of young people "went away for hours", playing cards. When he returned to the school and received the news that he was unprepared for the exam, he was disappointed.

In addition to his wide practice among Typhoid fever patients and the general practice as a family doctor, he had a wide medical practice. He has frequently says he was warned before coming to the county that he couldn't expect much obstetrical business as it was largely a "do-it-yourself" with perhaps the help of a midwife business, but that he has delivered countless Jones County babies.

Asked if he kept a record of the number of babies he had delivered, he said, "No, I didn't realize then I was making history, but it was lots of them". The observance of "Dr. Kittrell Day" will be quiet and restrained, due to his advanced age. Friends here said.

"Just" they added, "we hope to be able to wish him many more birthday anniversaries."

Isham KITTRELL, age 39 to 40, farmer. (age 39) C.77

- 1 male under five years.
- 1 male over five and under ten.
- 1 male over thirty and under forty.
- 2 females under five years.
- 1 female over twenty and under thirty.

Slaves owned:

- 1 male under ten years.
- 1 male over ten and under twenty four years.
- XXXXXXXXXXXXXXXXXXXX XXXX XXX XXXXX XXXXXX XXX.
- 3 males under twenty four and under thirty six.
- 2 males over thirty six and under 55.
- 1 female over ten and under twenty four.
- 1 female over twenty four and under thirty six.
- 1 female over fifty five and under one hundred.
- Total ten slaves.

The above from the 1840 census of Lauderdale County, Miss., 26th. district, South Mississippi.

Lauderdale County, Mississippi, 1850 census.

Isham KITTRELL,	age 45,	farmer,	born South Carolina,	1805.
Jane,	" 35,	"	" " "	1815.
James SAUNDERS	" 18,	farmer,	" " "	1832.
Elizabeth Kittrell,	age 14,	"	" " "	1836.
John Kittrell,	" 12,	"	Mississippi,	1838.*
Eliza "	" 10,	"	" "	1840.
Thomas "	" 8,	"	" "	1842.
Columbus Kittrell,	" 6,	"	" "	1844.
Polley "	" 4,	"	" "	1846.
Martha L. "	" 2,	"	" "	1848.

Daloville, Lauderdale County, Miss. 1860 census.

1860	Isham KITTRELL,	age 56,	farmer,	value of real estate \$900.00.
1860	Born South Carolina.			
1856	Jane Kittrell,	age 46,	born South Carolina.	
1855	* JOHN C. KITTRELL,	age 24,	farm laborer,	born Mississippi.
1855	Elizabeth Kittrell,	" 25,	born Mississippi.	
1855	Eliza Kittrell,	" 20,	" "	
1855	Thomas Kittrell,	" 17,	" "	
1855	Columbus Kittrell,	" 15,	" "	
1855	Mary Kittrell,	" 13,	" "	
1855	Daniel W. Kittrell,	" 5,	" "	
1855	David A. Kittrell,	" 6 months,	born Mississippi.	
1855	Louisa	" 6 months	" "	

1860 census, Lauderdale County, Mississippi, Daleville--Beat #3
 Nathaniel Kittrell, age 53, farmer, real-estate \$600.00, personal
 estate \$600.00, born So. Carolina, (1807).
 Tilisha Kittrell, age 44, " " " "

1816 Their children:

- 1836 1. John W. Kittrell, age 24, farm laborer, born Miss.
- 1837 2. Elisha B. Kittrell, age 23, ~~married Mary Raspberry~~ " "
- 1839 3. Margaret Kittrell, " 19, " "
- 1843 4. Rose P. Kittrell, " 17, " "
- 1846 5. Elizabeth Kittrell, " 14, " "
- 1847 6. Robert B. Kittrell, " 16, " "
- 1847 7. Amanda Kittrell, " 13, ~~married W. Brown~~ " "
- 1848 8. Caladonia Kittrell, " 11, " "
- 1851 9. Frances Kittrell, " 9, " "
- 1852 10. Mary M. Kittrell, " 8, " "
- 1853 11. Calvin R. Kittrell, " 7, " "
- 1856 12. William W. Kittrell, " 4, " "
- 1859 13. Moses Kittrell, " 1, " "

Comment: By 1870, Nathaniel's wife Tilisha had died (date not known) and Nathaniel was living with children Margaret, Amanda, Calvin R., and William W. still at home. Living "neighbor" to Nathaniel was Elisha B. who had married ~~possibly~~ ~~around 1868 or 1869~~, his wife Margaret J. RASBERRY, and infant son, (1 year old) William N.

1. John Washington Kittrell, born 1836, son of Nathaniel and Tilisha, married Martha Ann Weatherford, 1860 ~~1860~~
 Known children of John Washington and Martha Ann Weatherford Kittrell:

a. John R. Kittrell, born Dec. 12, 1866 (still living in 1964) Living in Laurel, Mississippi. He was a doctor. He married Lily Moore May 17, 1894. She was of Lauderdale County, but reared in Kemper County. Died 1962.

Children of John R. and Lily Moore Kittrell:

- Dr. John R. Kittrell, Jr. Deceased, (no date). (Served W. H. Kittrell, of Montgomery, Alabama. WW #1)
- Robert Kittrell, of Yuma, Arizona.
- Grace Kittrell, who is Mrs. R. B. Irby. (was School Teacher)

In Hickory Grove cemetery ^{NEAR} at Lizelia, Mississippi is this marker:
 "In memory of children of John W. and Martha W. Kittrell"

b. Frances Lenora Kittrell, born July 15, 1861, died Sept. 9, 1864.

c. Attis DeWitt Kittrell, born Aug. 30, 1869, died July 25, 1872.

d. Infant son, born Oct. 8, 1870, died Oct. 21, 1870.

e. Ila Martha Kittrell, born Feb. 11, 1877, died Nov. 5, 1879.

f. Jones Wilburn Kittrell, born Jan 9, 1881, died Dec. 30, 1895.
 (They were brothers and sisters of the above (a) John R. Kittrell).

Form 41 Copyright 1955 by The National Archives and Records Administration
 Use of this form is authorized for the purpose of recording information
 and the full name of the person or organization.

Page 41 Copyright 1981 by The General Land Office, P.O. Box 136, Little Rock, Arkansas 72203. All rights reserved. Printed and bound in the United States of America. Price \$1.00 per copy. Postage and handling charges extra.

2. Elisha B. Kittrell, (son of Nathaniel and Talisha Kittrell).
born Aug 10, 1837 in Mississippi, married Margaret J. OSBORN in 1868
born in Mississippi, 1846 (?).

Elisha was a Mason (Masonic Lodge Marker). Died July 20, 1905.
Inscription on marker:

"A Loving Husband
A Father Dear
A Faithful Friend
Is Buried Here"

He is buried at Hickory Grove Cemetery, Lizelia, Mississippi.

Known children of Elisha B. and Margaret J. Kittrell:

- a. William N. Kittrell, born Mississippi, 1868-69.
M. MAMIE GREEN 1892
- b. Amanda Kittrell, born 1873, in Mississippi.
- c. Amous Kittrell, born 1878, Mississippi.

- 3. Margaret Kittrell, born *DATE AND DAY NOT KNOWN* 1841, Miss.
- 4. Rose P. Kittrell, born " " " 1843, Miss.
- 5. Elizabeth Kittrell, born " " " 1846, Miss.
- 6. Robert B. Kittrell, born " " " 1844, Miss.
- 7. Amanda A. Kittrell, born " " " 1847, " *MARRIED OW GREEN - 1871*
- 8. Caledonia Kittrell, born " " " 1849, "
- 9. Frances Kittrell, born " " " 1851, "
- 10. Mary M. Kittrell, born " " " 1852, "
- 11. Calvin R. Kittrell, born " " " 1853, "
- 12. William W. Kittrell, born " " " 1855, "
- 13. Moses Kittrell, born " " " 1859, "

Died Nov. 3, 1915, Lockhart, Miss.

Inscription

"At Rest"

Married Flim Alenza RAWSON, 1899. He was born Jan. 27, 1876, died Dec. 1, 1959.

Inscription

"Gone But Not Forgotten"

Known children of Flim and Mary Lillian:

George W. Rawson

Born Oct. 13, 1899, died June 4, 1901.

Lelia E. Rawson

Born Oct. 26, 1902; died March 26, 1904.

(Inscription on both markers reads "Gone To Be An Angel")

All are buried at Hickory Grove cemetery.

- x. Gas Maxwell Kittrell, born July 4, 1881, Lockhart, Miss. Died March 29, 1955, Meridian, Miss. (Buried at foot of sister Levie (Olivia) Kittrell Trent.) Never married.

Inscription

"Sleep My Brother. Sleep
While Over Thee We Weep"

- xi. Ralph R. Kittrell, born March 20, 1884-1885, Lockhart, Miss. Died March 22, 1968, Fort Worth, Texas. Married (1) Anna T. Kukor, in Texas in 1919. (She was born Dec. 29, 1890). Married (2) Theresa M. Kukor (sister of Anna) May 10, 1965. No children of either marriage. Catholic faith.

- xii. Nannie Lee Kittrell, born Sept. 16, 1887, Lockhart, Miss. Died Aug. 7, 1956, Meridian, Miss. Married Charles Edward WILFE, 1908, Marion, Miss.

JOHN CHESTER KITTRELL, died Lauderdale County, Miss., buried Hickory Grove cemetery, near Daleville, Miss. Marker has Co. C. 5 Miss. Inf., U. S. A. (no dates).

wife Nancy Adeline (Wedgeworth) Kittrell, born Jan. 10, 1849, Choctaw County, Alabama, died Sept. 27, 1919, Lauderdale, County. They are buried side by side. (Marker reads: She Is At Rest in Heaven).

Hickory Grove cemetery is located two miles north east of Lizelia, Lauderdale County, Mississippi.

Page 11, Cemetery 1911 by the ...

FAMILY HISTORY

Lauderdale County, Miss. 1870 census (June 21 1870)
Marion Station, Township 8.

Isham Kittrell, age 65, farmer, value of real estate, \$125.00.
Jane Kittrell, " 56, " " " \$300.00.
Mary Kittrell, " 24, born Mississippi.
Daniel Kittrell, " 16, " "
David Kittrell, " 15, " "
Elizabeth McMillan, age 34, born South Carolina.

(Believe that Elizabeth Kittrell married a McMillan sometime between 1860 and 1870. Either divorced or husband died.)

John C. Kittrell, born Mississippi, 1837.

* JOHN C. (CHESTER) KITTRELL was a private in the Civil War, Company C, fifth Mississippi Infantry. He joined Capt. B. B. Smith's Company (Lauderdale Springs Grey's) 5th. Regiment, Miss. Volunteers at Lauderdale Springs, Miss. on Aug 6, 1861. He was signed up by Thos. Tolson.

He was officially mustered-in into Capt Smith's Company at Enterprise, Miss. on Oct. 18, 1861 by Lt. J. S. Lanier to serve for the remainder of the year, at a pay of \$11.00 per month.

This Company subsequently became Co. C, 5th. Regiment, Mississippi Infantry for the remainder of the war.

He was discharged on Dec. 3, 1861 at Warrington, Florida, and re-inlisted on Feb. 14, 1862 at Bridgeport, Ga. by Maj. Herring for a year. He re-inlisted again on Feb. 14, 1863 at Knoxville, Tenn. by Col. Dickins for another year, or the duration of the war.

He was admitted to Oliver Hospital at La Grange, Ga. on Nov. 25, 1863 as a patient. (Probably wounded.) Records also show him admitted to the Ocmulgee Hospital at Macon, Ga. on Dec. 16, 1864 with leg injury. Returned to duty Feb. 5, 1865.

He was decorated for bravery and courage in battle on Aug. 10, 1864 after the battle of Chickamauga, Ga. by Brigidere General John K. Jackson. He was in Jackson's Brigade at the time commanded by Lt. Col. W. L. Sykes and Maj. John B. Herring.

He was in battles in the Ringold, Graysville, Tunnel Hill and Dalton, Georgia area, as well as the Chattanooga, Tenn. Area.

After the war John Chester married Nancy Adaline WEDGEMORTH, on December 26, 1865. They were the parents of at least twelve children:

1. Jennie Kittrell, born in Mississippi, 1869.
Married Frank STEEDLEY.

FAMILY HISTORY

ii. John Langford Kittrell, born July 6, 1871, Lockhart, Miss. (Lauderdale County).

Died March 31, 1934, buried Hickory Grove cemetery.

Inscription

"He has gone to the mansions of rest"

Married Minnie L. CUMMINGS, Daleville, Miss. 1904.

Date of birth not known, died June 20, 1973 at age 87 years, 4 months and 20 days.

Known child, infant daughter, Minnie I. (?) Kittrell, Aug. 3, 1907---Dec. 27, 1907. The three are buried in Hickory Grove cemetery, in the same plot with brother Cas Maxwell and sister Levie (Olivia) Kittrell Trent.

iii. FRANKLIN THOMAS KITTRILL,* born April 12, 1872, Lockhart, Mississippi, died April 11, 1953, Meridian, Miss. Married Molly WARD, (daughter of Linzy Ward) in 1892. 12/12/1892. She was born Dec. 4, 1876, died Dec. 14, 1944. both are buried in Hickory Grove cemetery, near Daleville, Miss. Franklin Thomas married (2) Nancy Evelyn RUTLEDGE. (See page on Franklin Thomas and Molly (Ward) Kittrell's children.)

iv. Olivia (Levie) Kittrell, born Jan. 10, 1873, Lockhart, Miss. Died Oct. 24, 1950, Meridian, Miss., buried Hickory Grove cen.

Inscription

"At Rest"

Married W. M. TRENT, 1921.

v. Andy Kittrell, born 1874, Lockhart, Miss (?) Died Lockhart, Miss. Never married.

MEMORIAL LODGE MARKER

vi. James Charles Kittrell, (born Sept. 8, 1875, Lockhart, Miss. Died Feb. 27, 1945, Meridian, Miss, buried Hickory Grove cen. Married (1) Mary WILSON, 1906.

Married (2) Ada Esther WHITE, in Clark County, Miss., 1914.

She was born Dec. 7, 1893, died Jan. 16, 1964.

Known children of James Charles and Ada:

Andy Audis Kittrell

Born Nov. 20, 1915, died Feb. 10, 1934.

Also:
Charles Quintin Kittrell

James Shelton Kittrell

Born May 25, 1922, died Aug 10, 1972.

Ruby (Mrs. McAfee) Kittrell Limerick

All are buried at Hickory Grove cemetery.

vii Ellen Kittrell, born 1877, Lockhart, Miss.

Died somewhere in Oklahoma.

Married Jessie C. WHITE, 1908, Meriden, Miss. (Brother of Ada Esther and Charles Edward White.)

viii Caroline (Carrie Lesner) Lena (?) Kittrell, born Dec. 31, 1879, Lockhart, Miss., Died July 29, 1961, Meridian, Miss. Married William Edgar RAWSON.

*Denotes direct lineage

Genealogy.com
All Copyright 1993 by The Internet Genealogical Society, Inc. All Rights Reserved.
This Website is the PROPERTY of the INTERNET GENEALOGICAL SOCIETY, INC. and is not to be reproduced without the written permission of the Society.

FAMILY HISTORY

Lauderdale County, Miss. 1870 census (June 21 1870)
Marion Station, Township 8.

Isham Kittrell, age 65, farmer, value of real estate, \$125.00.
Jane Kittrell, " 56, " " " \$300.00.
Mary Kittrell, " 24, born Mississippi.
Daniel Kittrell, " 16, " "
David Kittrell, " 15, " "
Elizabeth McMillan, age 34, born South Carolina.

(Believe that Elizabeth Kittrell married a McMillan sometime between 1850 and 1870. Either divorced or husband died.)

John C. Kittrell, born Mississippi, 1837.

* JOHN C. (CHESTER) KITTRELL was a private in the Civil War, Company C, fifth Mississippi Infantry. He joined Capt. B. B. Smith's Company (Lauderdale Springs Greys) 5th. Regiment, Miss. Volunteers at Lauderdale Springs, Miss. on Aug 6, 1861. He was signed up by Thos. Tolson.

He was officially mustered-in into Capt Smith's Company at Enterprise, Miss. on Oct. 18, 1861 by Lt. J. S. Lahier to serve for the remainder of the year, at a pay of \$11.00 per month.

This Company subsequently became Co. C, 5th. Regiment, Mississippi Infantry for the remainder of the war.

He was discharged on Dec. 3, 1861 at Warrington, Florida, and re-inlisted on Feb. 14, 1862 at Bridgeport, Ga. by Maj. Herring for a year. He re-inlisted again on Feb. 14, 1863 at Knoxville, Tenn. by Col. Dickins for another year, or the duration of the war.

He was admitted to Oliver Hospital at La Grange, Ga. on Nov. 25, 1863 as a patient. (Probably wounded.) Records also show him admitted to the Ocmulgee Hospital at Macon, Ga. on Dec. 16, 1864 with leg injury. Returned to duty Feb. 5, 1865.

He was decorated for bravery and courage in battle on Aug. 10, 1864 after the battle of Chickamauga, Ga. by Brigadier General John K. Jackson. He was in Jackson's Brigade at the time commanded by Lt. Col. W. L. Sykes and Maj. John B. Herring.

He was in battles in the Ringold, Graysville, Tunnel Hill and Dalton, Georgia area, as well as the Chattanooga, Tenn. Area.

After the war John Chester married Nancy Adaline WEDGEWORTH, on December 26, 1865. They were the parents of at least twelve children:

- i. Jennie Kittrell, born in Mississippi, 1869.
Married Frank STEEDLEY.

- ix. Mary Lillian Kittrell, born March, 10, 1880, Lockhart, Miss.
Died Nov. 3, 1915, Lockhart, Miss.

Inscription

"At Rest"

Married Elim Alonza RAWSON, 1899. He was born Jan. 27, 1876, died Dec. 1, 1959.

Inscription

"Gone But Not Forgotten"

Known children of Elim and Mary Lillian:

George W. Rawson

Born Oct. 13, 1899, died June 4, 1901.

Lelia E. Rawson

Born Oct. 26, 1902, died March 26, 1904.

(Inscription on both markers reads "Gone To Be An Angel")

All are buried at Hickory Grove cemetery.

- x. Cas Maxwell Kittrell, born July 4, 1881, Lockhart, Miss.
Died March 29, 1955, Meridian, Miss. (Buried at foot of
sister Levie (Olivia) Kittrell Trent.) Never married.

Inscription

"Sleep My Brother. Sleep
While Over Thee We Weep"

- xi. Ralph R. Kittrell, born March 20, 1884-1885, Lockhart, Miss.
Died March 22, 1968, Fort Worth, Texas.
Married (1) Anna T. Kukor, in Texas in 1919. (She was born
Dec. 29, 1890). Married (2) Theresa M. Kukor (sister of Anna)
May 10, 1965. No children of either marriage. Catholic faith.

- xii. Nannie Lee Kittrell, born Sept. 16, 1887, Lockhart, Miss.
Died Aug. 7, 1956, Meridian, Miss.
Married Charles Edward WHITE, 1908, Marion, Miss.

JOHN CHESTER KITTRELL, died Lauderdale County, Miss., buried
Hickory Grove cemetery, near Daleville, Miss. Marker has Co. C.
5 Miss. Inf., U. S. A. (no dates).

wife Nancy Aveline (Wedgeworth) Kittrell, born Jan. 10, 1849,
Choctaw County, Alabama, died Sept. 27, 1919, Lauderdale County.
They are buried side by side. (Marker reads: She Is At Rest in
Heaven).

Hickory Grove cemetery is located two miles north east of Lizelia,
Lauderdale County, Mississippi.

* i. JOHN LINZY KITTRELL, born Dec. 26, 1893, Lockhart, Lauderdale County, Mississippi.

ii. Lillian E. Kittrell, born Aug. 6, 1896, (probably Lockhart, Miss still living in 1974.

Married Julius W. (Major) Daniels, born Sept. 27, 1889, died May 27, 1951. Buried Hickory Grove Cemetery.

Children:

1. Vera Ida Daniels, born Jan 27, 1923, Died May 30, 1935, age 12, struck by lightning, buried Hickory Grove cemetery.

2. Ruby Daniels

3. Julius Daniels

4. JEWEL DANIELS M. CLYDE WARD 1938

Lillian married (2) Andy White. married (3) WILL Herrington.

iii. Timothy Franklin Kittrell, born Dec. 19, 1898.

Married (1) Mary Lee Brown, born Feb. 2, 1902, Died Sept. 12, 1941, buried Hickory Grove Cemetery. (She was a cousin of Ollie Brown Kittrell).

Children:

1. Edward Kittrell

2. Ethel Kittrell,

Married Emory ^{W.} Culpeper. 1937

3. Clyde Kittrell

4. Earl Kittrell

5. Everett Brown (Buddy) Kittrell

SIMMY KITTRELL, JR.

Timothy married (2) Kizzie Gertrude (Kutledge) Riley, widow.

Children:

1. Larry Edward Kittrell, born 1947. (adopted).

2. Mary Frances Kittrell, born 1953.

Married ROBERT Haney.

AL CADE.

iv. Luther Berry Kittrell, born April 6, 1901, died Feb. 1936. Buried Hickory Grove Cemetery. Never married.

v. Harvey Lennis Kittrell, born Sept. 3, 1903.

Wife: Nell Camp, born Oct. 29, 1904.

Married May 21, 1923.

Children:

1. Carolyn ~~Ray~~ Kittrell, born Oct. 14, 1924, died July 1, 1933.

2. ~~Ray~~ Elizabeth Kittrell, (Betsy), born Dec. 19, 1931.

Genealogy Copyright 1987 by The Evening Post, Inc., P.O. Box 100, Longwood, Florida 32709. This is a reproduction of the original manuscript. All rights reserved. No part of this publication may be reproduced without the written permission of the publisher.

Married Norman Dean Vick

Children:

Michael Dean Vick, born March 11, 1953.

Thomas Randolph Vick, born April 25, 1958.

3. Tommie Wayne Kittrell, born Sept. 22, 1943.

Married Jerry Lynn Sauls.

Children:

Stacey Lynn Kittrell.

vi. Robert Kittrell, born Nov. 30, 1908.

Wife: Beatrice Shirley, born May 30, 1910.

Married May 25, 1931.

Children:

1. Audrey Kittrell, born March 11, 1932.

Married Lawrence David Burkhalter, Oct. 21, 1950. (nortician).

Child:

Jefferson (Jeff) Lee Burkhalter.

married - Sue

*May 23, 1981
Memphis, Tenn.*

2. Donald Kittrell, born Nov. 4, 1947.

Married Cathy Alcock June 3, 1970.

Living in ~~Louisville~~, Miss. 1973.

Meridian

1. Haley Michelle, July 13, 1978 - Meridian

Wife: ~~Bonnie~~ Lorene Skipper Irby,
Near Lockhart, Miss. Sept. 22, 1913

Married: Dec 30, 1981 - Meridian

Form AL-6 (rev. 10-65) by The Bureau of Census, Inc. P.O. Box 104, Silver Spring, Md. 20901. This publication is available for sale to the general public. See the instructions on the back of this form for ordering and distribution information. Price \$0.50.

* JOHN LINZY KITTRELL, (son of Franklin Thomas Kittrell), born Dec. 26., 1893, Lockhart, Lauderdale County, Miss. At age nineteen John married first wife, Ruth LONG, Dec. 26, 1912. She was born May 30, 1896. Died Sept. 27, 1916, near Lockhart, Miss. at age twenty, eight days after the birth of their second child, Bessie Lucille.

Two children born of this union:

1. John Howard Kittrell, born Oct. 19, 1913, near Toston, Lauderdale county, Miss. Married Louise VAUGHN Sept. 18, 1937 in Vicksburg, Warren County, Miss. She was born July 20, 1920, in Queen City, Bowie County, Texas

Child:

- i. William Howard Kittrell, born June 22, 1938. Married Dorothy Faye LOGUE July 12, 1957. She was born Aug. 17, 1939. They were married at St. Paul's Catholic Church, Vicksburg, Miss.
Children:
 - i. Steven Hugh (infant) April 1, 1963----April 3, 1963.
 - ii. William Howard Kittrell, Jr., born March 30, 1960, Jackson, Hinds County, Miss.
 - iii. Glen Allen Kittrell, born Nov. 25, 1965, Vicksburg, Miss.

2. Bessie Lucille Kittrell, born Sept. 19, 1916 near Lockhart, Miss. Occupation: Registered nurse. Diploma, Meridian Senior High School. Married Donald SPANGLER Nov. 3, 1952, Quitman, Miss. He was in the Navy in World War 2. Railroad employee, living near Lauderdale, Miss. (1973). No children.

After being widowed for almost five years John Linzy married (2) Ollie BROWN, daughter of Jesse Elbert and Nancy Malissa (REID) Brown, at Lockhart, Lauderdale County, Miss., March 9, 1921. Ollie, a school teacher, born Sept. 20, 1898 near Daleville, Miss.
Children: (Two)

1. Mildred Corena Kittrell, born 2-24-'22, near Black Water, Miss. Grad. Meridian Sr. High. Worked for Southern R.R., Meridian. Mgr. Mayflower Van Lines, Valdosta, Georgia. Married Burton Dewitt HOOD, Jan. 16, 1954 in Birmingham, Alabama. Burton Dewitt, know as "Map", born Nov. 21, 1921. No children born of this union. Currently (1973) living in Valdosta, Lounds County, Georgia.

2. Jesse Vernon Kittrell, born Oct. 10, 1923, Whynot, Lauderdale County, Miss. Diploma Meridian Senior High School, Meridian, Miss., May 27, 1941. Entered service in World War II, Army Air Force, Feb. 5, 1943. Served over seas in Hawaii, Guam, the Phillipines, Iwo Jima, Okinawa and the Marshall Islands, with the 355th. Bomb Squadron.

133. After discharge from service, entered the 2584th Air Force Reserve training center at Memphis, Tenn. Discharged with the rank of S/Sgt. March 1, 1949. Employed by Southeastern Air Service, Atlanta, Ga., 1946---1947. Received pilots license; leased Fairburn Airport (operated air service) 1948. Employed by United Air Lines, San Francisco, Calif., 1949. Dec. of 1949 came to Texas, (Fort Worth), and was employed by Convair AIR CRAFT. Married Lois Lorene (Skaggs) Chapin, Fort Worth, Texas, April 21, 1950. Married by Isaac Nixon, minister of the Gospel. Recorded in book 103, page 9, of marriage records. Melvin (Mel) Faulk, clerk, County Court, ~~XXXXXXXXXXXXXXXXXXXX~~ Employee of LTV in Grandd Prairie, Texas in 1972. No children.

* John Linzy Kittrell, was a farmer and lumberman in Lauderdale, Kemper and Wayne counties. (Mississippi) He owned sawmill in Valdosta Georgia, Lowndes County, from 1952 until his death there Nov. 12, 1957. He is buried at Meridian Memorial Park cemetery, Meridian, Ala.

(Nathaniel, brother of Nathan)
 (Died 1799 - 1800)
 1860 census, Lauderdale County, Mississippi, Daleville--Beat #3
 Nathaniel Kittrell, age 53, farmer, real-estate \$600.00, personal
 1861 estate \$600.00, born So. Carolina, (1807).
 Tilisha Kittrell, age 44, " " "

- 1816 Their children:
- 1836 1. John W. Kittrell, age 24, farm laborer, born Miss.
 - 1837 2. Elisha B. Kittrell, age 23, ~~married M. J. Raspberry~~ " "
 - 1839 3. Margaret Kittrell, " 19, " "
 - 1842 4. Rose P. Kittrell, " 17, " "
 - 1846 5. Elizabeth Kittrell, " 14, " "
 - 1847 6. Robert B. Kittrell, " 16, " "
 - 1847 7. Amanda Kittrell, " 13, ~~married W. Brown~~ " 18-75
 - 1848 8. Caladonia Kittrell, " 11, " "
 - 1851 9. Frances Kittrell, " 9, " "
 - 1852 10. Mary M. Kittrell, " 8, " "
 - 1853 11. Calvin R. Kittrell, " 7, " "
 - 1854 12. William W. Kittrell, " 4, " "
 - 1859 13. Moses Kittrell, " 1, " "

Comment: By 1870, Nathaniel's wife Tilisha had died (date not known) and Nathaniel was living with children Margaret, Amanda, Calvin R., and William W. still at home. Living "neighbor" to Nathaniel was Elisha B. who had married ~~possibly~~ ¹⁸³⁷ around 1868 or 1869, his wife Margaret J. RASBERRY, and infant son, (1 year old) William N.

1. John Washington Kittrell, born 1836, son of Nathaniel and Tilisha, married Martha Ann Weatherford, 1860 ~~Martha Ann~~
 Known children of John Washington and Martha Ann Weatherford Kittrell:

- a. John R. Kittrell, born Dec. 12, 1866 (still living in 1964) Living in Laurel, Mississippi. He was a doctor. He married Lily Moore May 17, 1894. She was of Lauderdale County, but reared in Kemper County. Died 1962.
 Children of John R. and Lily Moore Kittrell:
 Dr. John R. Kittrell, Jr. Deceased, (no date). (Served WW #1)
 W. H. Kittrell, of Montgomery, Alabama.
 Robert Kittrell, of Yuma, Arizona.
 Grace Kittrell, who is Mrs. R. B. Irby. (was School Teacher)

In Hickory Grove cemetery ^{NEAR} at Lizelia, Mississippi is this marker:
 "In memory of children of John W. and Martha W. Kittrell"

- b. Frances Lenora Kittrell, born July 15, 1861, died Sept. 9, 1864.
- c. Attis DeWitt Kittrell, born Aug. 30, 1869, died July 25, 1872.
- d. Infant son, born Oct. 8, 1870, died Oct. 21, 1870.
- e. Ila Martha Kittrell, born Feb. 11, 1877, died Nov. 5, 1879.
- f. Jones Wilburn Kittrell, born Jan 9, 1881, died Dec. 30, 1895.
 (They were brothers and sisters of the above (a) John R. Kittrell).

Form 101, Copyright 1955 by The American Genealogical Society, Inc., P.O. Box 346, Logan, Utah. Reprints of this form are available from the American Genealogical Society, Inc.

Page 11 Copyright 1991 The Computer Museum, Inc. P.O. Box 1240, Lowell, MA 01852
 This software is provided as a free service to the public. It is not to be redistributed or used for profit.
 Write to the author for more information.

2. Elisha B. Kittrell, (son of Nathaniel and Talisha Kittrell).
 born Aug 10, 1837 in Mississippi, married Margaret J. BASSBY in 1860
 born in Mississippi, 1846 (?).

Elisha was a Mason (Masonic Lodge Marker). Died July 20, 1905.

Inscription on marker:

"A Loving Husband
 A Father Dear
 A Faithful Friend
 Is Buried here"

He is buried at Hickory Grove Cemetery, Lizelia, Mississippi.

Known children of Elisha B. and Margaret J. Kittrell:

- a. William N. Kittrell, born Mississippi, 1868-69.
M. MAMIE EDOM 1896
- b. Amanda Kittrell, born 1873, in Mississippi.
- c. Amous Kittrell, born 1878, Mississippi.

3. Margaret Kittrell, born *DATE AND DAY NOT KNOWN* 1841, Miss.

4. Rose P. Kittrell, born " " " " 1843, Miss.

5. Elizabeth Kittrell, born " " " " 1846, Miss.

6. Robert B. Kittrell, born " " " " 1844, Miss.

7. Amanda A. Kittrell, born " " " " 1847, " *MARRIED D.W. BROWN - 1875*

8. Caledonia Kittrell, born " " " " 1849, "

9. Frances Kittrell, born " " " " 1851, "

10. Mary M. Kittrell, born " " " " 1852, "

11. Calvin R. Kittrell, born " " " " 1853, "

12. William W. Kittrell, born " " " " 1856, "

13. Moses Kittrell, born " " " " 1859, "

Kittrell Family of North Carolina
and some descendants

* * * * *

Armorial Bearings

Asure: A Lion pasant or between 3 mascles of the second.
Crest: On a chapean asure, turned up ermine, a wilde cat
stantant proper.

The Kittrell family in America decends from a very ancient and notable family who originally spelled the name Caterall. We have not traced the family back of Edward I. There is no doubt, much history of the early branches and derivation of the family, but references are rare.

The American Kittrell family descends from the old Lancashire family of Catherals (also speilled Catternal and Caterals).

The early Catheralls were established in Lancashire at a very early date; just how long is not certain, but it was previous to the reign of Edward I. They bore for arms Asure: three mascles' or.

One cadet branch became established about the time of Edward III in Yorkshire, at Rothmel, and from this again a Collateral branch. The Cadet branch from which the American Kittrells are descended, stems out from John Caterall or Cateral, he apparently spelled his name both ways.

In the reign of Edward I, he became established on the Welsh border as one of the retainers of the Lords of Chester. The Welsh border in Heraldic service. The Welsh connections explain the frequent spelling with the "Mac" prefix. Although there is some Welsh blood in the later Catherals, their name is purely English.

To this John Catheral a difference of arms in the form of a pasant lion was awarded for gallantry against the Welsh. The Arms of the Catherals.

John Catheral (or Cathral) had a son: Willaim Catheral, alias de Horton, who married an heiress and was a personal friend of Edward II. He had issue: 1. William Catheral 2. A daughter 3. A son. William Catheral had issue:

1. David (Time of Edward III) who had issue:
 - A. John (Time of Henry IV) who had issue:
 - (aa) Ralph (Time of Henry VI)
 - (bb) Another son

Ralph Catheral had issue:

1. Hugh (Time of Edward IV) who had issue:
 - (a) John (Time of Henry VIII)
 - (b) a son (c) a son (d) a daughter
 - (e) a daughter

John Catheral, was also called Jenkyn Catheral or Kittrell, and John Catherod and is illustrated of this confusion of the spelling of names in that period. He had issue: John Catheral (time of Henry VIII) was called Jenkyn.

John Catheral of the time of Henry VIII or Jenkyn Catheral had issue: 1. John of whom this sketch is traced. 2. A son 3. A daughter.

John Catheral the third of that name died in 1658. This is the first definite date in regard to the family. He upheld the Cavalier Cause in the wars of Charles I and Parliament, and as a result, he was mulated of a large portion of his property. However, he continued to live at Horton after the Cessation of hostilities. He had issue: 1. John of whom we are interested. 2. A son 3. A daughter 4. A daughter.

John Catheral was living in 1663, as is proven from the "Visitations" but little more is known about him. He had issue: 1. Dutton of whom we are interested and of whom it seems begins the American family history.

Dutton Catheral was born in 1662. As the eldest, he inherited the family estate and name and also the family tradition of loyalty to the Stuart Cause. When the Revolution of 1688 broke out (which unseated James II and placed William of Orange on the throne) Dutton was consequently on the wrong side; unable and unwilling to follow James on his hurried flight from the Kingdom, he sold off the family estate and joined James in Ireland. He lived there for some time and finally joined the famous "Flight of the Wild Geese" to France, however France was not to his taste and on the conclusion of peace, he left that country and came to Maryland, where he is found in parish register of the Eastern Shore of Maryland as Dutton Kittrell.

Dutton Kittrell appears to drop almost out of sight, so far as any record is concerned, except that he settled in Maryland. It is likely that he died in Maryland. We do not know the name of this Dutton Kittrell's wife as nothing has been found to give this information.

From the records and references gathered, he had at least one son, although not completely proven by record. We find Jonathan Kittrell was from Maryland and this leads to the idea that he was descended from Dutton Kittrell. Other records from Maryland and North Carolina tend to give this opinion or conjecture that Jonathan Kittrell was son of Dutton Kittrell of Maryland about 1695.

Note: Catheral (Horton Co. Chester, there settled temp. Edward I in consequence of the marriage of Catherall of Catherall Co., Lancaster, with an heiress of Horton. Randeall Catherall, the Heraldic Collector, was a younger son the Horton family). Burk's Landed Gentry, Burk's Peerage, Burk's Encyclopedia and Burk's History of Commoners, found in Congressional Library of English Pedigrees and Heraldic.

Jonathan Kittrell of North Carolina, first generation of definite proof appears in the records of Chowan and Bertie Counties. Little is known of him until 1718. In 1723, in Chowan County, N.C., Jonas or Jonathan Kittrell was living in that precinct. Vol. 25, page 186 N. C. State and Colonial Records. Jonathan Kittrell received a grant of land from the royal government of North Carolina. This was Tuesday, the 31st day of October 1727. (Vol. 2 page 712 North Carolina State and Colonial Records.) Bertie County, North Carolina, Jonathan Kittrell is found in many transactions from 1718 - 1739. His will is recorded in Chowan County, N. C. in 1748. Just who his wife was we do not know. It is most likely that his marriage took place in Bertie County or Chowan County. His issue: 1. Jonathan II whom we will have much later on in this history. 2. John of Bertie County, N. C. carried out in this History. 3. George, who settled

in Granville County, N. C. about 1760 or 1761 as in 1761 he was granted land in Granville County, N. C. 4. Isaac 5. Samuel, who settled in Granville County, N. C. about 1760 or 1762. There were perhaps other children, but no record to the effect.

Jonathan Kittrell of the second generation and second by the name Jonathan was born about 1720 (exact date undetermined). From Revolutionary and Colonial Services, he must have been at least 30 years of age at the beginning of the Revolution.

There is so much history concerning Jonathan's career, it is difficult to know where to begin. He was no doubt a resident of Bertie or Chowan County until 1760. In this year he bought land in Granville County, N. C. at a place now called Kittrell, N. C. in Vance County. (Vance County was formed from Granville). In 1761 he was granted land in Granville County by Lord Granville. Nothing appears regarding him in Bertie or Chowan Counties after this date.

Vol. 22, page 394 N. C. State and Colonial Records "Newhern Dist. N. C., Beaufort County, 1763 - We the undersigned subscribers do hereby acknowledge to have received of Robert Harris, Colonel of Granville Co. Regiment of Militia the sum opposite our respective name in full for our services in protecting the public peace at Hillsborough in September last -- March 24, 1763". Among the names or list appears Jonathan Kitral, Captain, Dec. 24, 1763 and John Kittrall, Ensign. This proves that Jonathan Kittrell was in the service of his country prior to the Revolution.

Vol. 22, Pages 489-490 N. C. State and Colonial Records - "Capt. Kitral, paid soldiers for service thru Robert Harris, Colonel and Again Vol. 22, page 165, same reference. Company commanded by Captain Jonathan Kittrell 1771 -- gives Samuel Kittrell as Lieutenant and Jonathan Kittrell II as clerk." This proves that in 1771 Jonathan Kittrell II had a son Jonathan who was at least 18 years of age as he was serving his country.

From records in office of Secretary of State of N. C. Granville County taken from N. C. State and Colonial Records Vol. 8, page 196, we have, "Know all men by these present that we Isaac Edwards, Jno. Williams and Wm. Bullock all of Granville Co., are held and firmly bound unto Robert Harris, Jonathan Kittrell and Thornton Yancey -- Justices of the Co. of Granville in the sum of one thousand pounds proclamation money. To the which payment well and truly to be made, we bind ourselves, our heirs, Executors and administrators jointly and severally firmly by these present. Sealed with our seals and dated this 17th day of April A. D. 1770 ect."

Jonathan Kittrell II, made his will which is dated 1811 March 18th in Granville County, N. C. Probated 1812. He mentions the following in his will -

My son, Isaac; son-in-law, John Harris; daughter of Nancy Hunt; grandchildren Tabby, Talley, James, Sally, Nancy, Polly, Daughters, Sarah Higgs and Mary Morse, Grandchildren: Jonathan, Sally, Patsy, Eaton, Sol. Alston Kittrell; Eaton Hunter Kittrell; Ann Alston wife of my son Isham, Pathenia-Elizabeth-Isham-Williamson Kittrell; Bryant, Wilburn, Frederick, Mary Blakemore, children of son Jonathan.

This will does not call for Joshua neither does it call for all of his brothers, but it does call for Isham and the heirs of Solomon Kittrell so to prove Joshua a son Jonathan we prove Joshua a brother of Isaac and Isham.

In North Carolina Census of 1790 Granville Co. there appears Jonathan Sr. and Jonathan Jr., Samuel, Joshua.

The proven issue of Jonathan II, and his wife from the records:

1. Jonathan III, married Tabby Bruant (Bryan, later)
2. Nancy or Mancy married William Hunt January 24, 1780 Granville Co. N. C. and it is likely that this family settled very early in Sumner County, Tennessee
3. Sarah married a Mr. Higgs
4. Mary married a Mr. Morse
5. Solomon married Miss _____ Norman. I think he is of the line which left Granville Co. about 1800 and went to Alabama, Mississippi and Texas, probably the father of Bryant Kittrell. One Bryant Kittrell son of Jonathan III. There were 2 Bryant Kittrells, sons of brothers - Solomon and Jonathan. One of these settled in Mississippi and Alabama and descendants are scattered through Texas, many of whom are quite prominent in the history of Texas and who have been outstanding in that state for a number of years.
6. George Rowland Kittrell, settled in Wilson County, Tennessee.
7. Isaac Kittrell married Mary _____. They settled very early in Montgomery County, Tennessee where Isaac died in about 1811 - 1818. (See copy of inventory and admn'x this sketch)
8. Isham, born 1759 - 60 in Granville Co. N. C. Married Ann Alston Hunter in Granville Co. N. C. She was a daughter of Martha Alston and Isaac Hunter of Carolina (Alston family history as reference - Later)

Jonathan Kittrell, of North Carolina, the third generation.

Jonathan Kittrell III, lived in Granville Co. N. C. from all records. He was a revolutionary soldier (see sketch of Jonathan IIO also Vol. 16 page 1099, N. C. State and Colonial Records -- North Carolina Reg. 10, Capt. Mills Co., Enlisted March 8, 1782 Jona. Kittrell, private, served twelve months." From the descent of Mrs. Van Milder Shields of N. C. and Mrs. Robert W. La Lassiter of Oxford N. C. one is let to believe that Jonathan III married a second time - Miss Elizabeth Howse, but we have no record of this marriage except the authority given in their D. A. R. Application. Jonathan III married Tabby Bryant in N. C. His issue:

1. Bryant, probably had a son Pleasant
2. Wilburn
3. Frederick
4. Mary, married in Blakemore
5. Parthenia Elizabeth Williamson - not known whether or not she married.
6. Isaac, born 1779 - married several times - Betty Read in N. C. Isaac settled in White County, Tennessee

Isaac Kittrell of N. C. and Tenn.
4th Generation

Isaac Kittrell, son of Jonathan III, born in Granville Co. N.C., December 1779 and married his first wife Betty Read, daughter of Christian Read. They were married in Bertie Co. N.C. December 5, 1805. She died and he married Frankie Snipes of Wilson Co., Tennessee. She died and he married (3rd) Miss Mildred Maxey. I think his last wife was from Smith County, Tenn. Mr. D. B. Kittrell of Pleasant Shade, Tennessee submits the following record: Issue of first marriage:

1. Mary Read, married Lorenzo Dow Balleu (later)
2. Isham, married Carey Proctor (later)
3. Margaret, married Green Proctor
4. Martha born about 1812, married Mr. McMurry and moved to Maury Co. Tennessee. She had a son Dave and another, name unknown.

Second marriage

5. Edwin, married Miss Robinson (later)
6. Lucinda, married Spear Robinson (later)
7. Thomas, married Miss Tarver (later)

Last marriage - there were several issue but do not know to which marriage, some may have been to 2nd marriage.

8. Thelan married Miss Allen, later a lady in Smith Co.
9. William married Miss Cornwall
10. Thenie married Josiah Reace

In 1826 Isaac Kittrell was living in Wilson Co, Tennessee - later in Smith Co., Tennessee. Most of these marriages occurred in these two counties.

Mary Read Kittrell daughter of Isaac Kittrell of N.C. and Tennessee, married Lorenzo Dow Balleu and they settled in Smith Co., Tennessee. Records at Carthage give much on this branch of the family such as marriages, wills, inventories, deeds, etc. (no marriages in Smith Co. prior to 1830). Issue:

1. William A., September 22, 1830
2. James E., November 1, 1831
3. Leonidas W., February 1, 1833
4. Diogenes, September 28, 1834
5. Julia A., July 4, 1836
6. Anthony S., December 4, 1837
7. Margaret E., August 18, 1840
8. B., November 5, 1842
9. Rufus C., August 24, 1847

Isham Kittrell, son of Isaac of N.C. and Tennessee married Carey Proctor of Smith Co., Tenn. and they settled in Smith Co., Tennessee. Issue:

1. Isabel, married Daniel Mabry
2. Lizzio, married Hose Davis
3. George, married Callie Stewart and lived at Woodbury, Canon Co., Tennessee. She was a twin. Her sister, Angie married John Rucker while their brother John Stewart married a sister of John Rucker, Amanda Rucker. They all resided in Cannon and Bedford Counties, Tennessee. This Rucker line is a distant connection of the Rucker line of the authoress of this sketch.

4. John Bell married his cousin, Julia Balleu (see Mary Read and her daughter Mary Read Kittrell, daughter of Isaac Kittrell) (later)
5. Tant married Mary Batts
6. Isham married Sallie Ramsey

John Bell Kittrell, son of Isham, of Smith Co., Tennessee married his first cousin, Julia Ballow of Mary Read and Isaac her fathers line. John Bell is better known as Jack Kittrell. Issue:

1. D. B. Kittrell who lived at Pleasant Shade, Tennessee and from whom many of the records of this line have received.
2. Ligon, whose descendants are living in both Smith and Davidson Counties, Tennessee.
3. Edwina, married Mr. Gibbs and had issue. She is living in Nashville, Tennessee and has issue:

Thomas Kittrell, son of Isaac of Smith Co., Tennessee married Miss Tarver. They lived in Smith County, Tennessee. Issue;

1. Billie, married first Birdwell, second a Draper and third a Holland.
2. Martha married Dick Cornwell.
3. Bettie married a Mr. Rankins

Edwin Kittrell, son of Isaac Kittrell of Smith County, Tennessee, married Miss. Robinson. Issue:

1. Dave
2. Isham
3. Fannie might be the Fannie who married into the Rowland or George Rowland Kittrell line, however this is not proven.
4. Mollie

Lucinda Kittrell, daughter of Isaac Kittrell of Smith County, Tenn. married Spear Robinson and they lived in Smith County, Tenn. Issue:

1. John
2. Joe
3. Eddie

Pellam Kittrell, son of Isaac, of Smith County, Tenn., married first a lady named Allen, second he married _____. Issue by first marriage:

1. Edward Kittrell, now living at Difficult, Tennessee, Smith County, age about 86 years. He is the father of a large family, 2 sons died about 1929. Pate and Jack Kittrell. There are a number of sons and daughters now living.

Issue by second marriage:

1. Marion Kittrell
2. Jane, married Mr. Swann
3. Mary, married Mr. Reece

Thenie Kittrell, son of Isaac, married Josiah Reese and they lived in Smith County and adjoining counties of Tennessee. Their issue:

1. Isabella
2. Eddie
3. Jane
4. Lucy
5. Isaac
6. Charity

Joshua Kittrell, son Jonathan II married Ruth Kittrell, his cousin in Granville County, N.C. Ruth died about 1848, was buried in Maury County, Tennessee. Joshua died before 1826 in Granville County, N.C. It is said that Ruth's parents died before she was very old and that as a mere child her uncle Jonathan, Joshua's father, took her to his home where she was to be reared and Joshua fell in love with her from the very first time he saw her, finally marrying her. They were married about 1785. Ruth was born in Bertie County, N.C. Their issue:

1. George, married Elizabeth Boswell. George was born about 1798 in Granville County, N.C. He had a son, George William Frederick, born in Granville County, N.C. 1830. G.W.F. Kittrell left a son J. C. Kittrell, an attorney in Henderson, N.C. and another son, Robert G., who is associated with him.

2. Micheal John, born about 1796 in Granville County, N.C. married Annie Hunter. They moved to Tennessee: (later)

3. Seth Reddick, born December 31, 1800 in Granville County, N.C. the youngest of 4 sons and 2 daughters. He married Eliza J. Hinton Hunter June 1, 1826 and they settled in Tennessee.

4. Benjamine, born in Granville Co., N.C., married first Miss Long and second a Miss House.

5. Leah, married Norford Holden, a close relative of Governor Holden of N.C. They moved to Tennessee. She was left a widow before coming to Tennessee with her brothers. She had 2 children by Holden. She remarried in Tennessee.

6. Nancy, married Gideon Wright in Granville County, N.C., and moved to Tennessee in 1826 with other members of her family. They settled first in Maury County, Tennessee. Little or nothing more is known of this family.

Micheal John Kittrell, son of Joshua and Ruth Kittrell moved to Tennessee in about 1826; settled in Maury County. He married Anna A. Hunter in 1826. They settled in what is now Mr. Pleasant, Maury County, Tennessee. He died in 1874. She died in 1854 or '55. Issue:

1. George M., born December 20, 1829, married Ann Fleming
2. Reddick
3. Loretta
4. Martha
5. Jacob
6. America
7. Eudora

George M., son of Micheal John Kittrell, married Ann W. Fleming, daughter of Thomas F. Fleming. George and Ann married in Maury Co., Tennessee in 1855. Issue:

1. Whitney F., living in Maury County, near Columbia
2. Laura R.
3. William H., living in Mt. Pleasant, Maury County, Tennessee. Married Miss Pearl Wall. He is a doctor and a very prominent man of Maury County, Tennessee. To him is given thanks for some of this family line.

4. Thomas
5. Anna A.

Seth Reddick Kittrell, son of Joshua and Ruth, born December 13, 1800 in Granville County, N.C. was youngest of 4 sons and 2 daughters. He moved to Maury County, Tennessee about 1826 and settled there. He married a sister of his brother's wife, Miss Eliza J. Hinton Hunter on June 1, 1826. Ruth Kittrell, widow of Joshua and mother of Seth, came with him to Tennessee and settled and died in Maury County, Tenn. She is buried in the Kittrell burying ground in Maury County, near Mt. Pleasant, Tennessee. There was no stronger supporter of the Democratic party and the old whig party than our subject. He was a Methodist Episcopal and resided on his farm near Mt. Pleasant. Issue:

1. Jacob
2. William A.
3. Hinton G.
4. Zulika R.
5. Larissa K.

George Rowland Kittrell, son of Jonathan II, (the record of Isaac Kittrell son of Jonathan III, stated that he was a son of Jonathan II and uncle of Isaac (G.K. was). He may have married before coming to Tennessee about 1790, but we have no record of such. We do, however, know that about 1800 or probably as early as 1795, he married Miss Rosa Bryant whose parents settled in Marshall County, Tennessee about the time George R. and Rosa came to Tennessee and settled in Wilson County, Tennessee. In 1826 he was living in Wilson County. Issue:

1. Samuel, born in Wilson County, Tennessee, married Miss Frye and second Miss Shoe (later)
2. John born 1819 in Wilson County, married Addie Beasley and second Mary Kittrell, a cousin. This Mary may have been a daughter of Solomon A.
3. Major Marion Bryant, a very prominent man of Cannon County, Tennessee, born in Wilson County. He married first Fannie Kittrell of Smith County, Tennessee. (See line of Isaac Kittrell later)
4. Other children, but no record.

Samuel, son of George Rowland Kittrell born in Wilson County, Tennessee, married Miss Frye and then a Miss Shoe. There is a number of children but we have no record. Issue:

1. Sam Bryant
2. Andrew B.
3. John R.
4. Bryant
5. Another
6. Another

Major Marion Bryant Kittrell, son of George Rowland Kittrell, born in Wilson County, Tennessee, married three times, first Fannie Kittrell of Smith County, Tennessee. (See Smith County, Tenn. Kittrell line). He then married Matilda Haynie, and third married Ellen Johnson. He settled in Rutherford County at what is now known as Kittrell, a little country place a few miles from Murfreesboro, Tenn. The authoress' father knew Major Kittrell years ago and I get my records here from the graveyard. The old home, and from my father's recollections as well as other information collected. Major Kittrell is buried in the cemetery in Murfreesboro. Only a few weeks ago I was there and saw the stone of Marion Kittrell.

Issue:

1. Fannie, married Spencer Talley. She had Bettie who married Mr. Walker and Carrie who married Fanning Glaor or Olga.
2. Laura, married W. C. Houston and died leaving 3 sons: W.C. Houston was Congressman from Cannon County, Tenn. for years. He is now deceased. Judge Houston married a second time and lived at Woodbury, Tennessee. Judge Houston and Laura Kittrell, his first wife had: 1. W. C. Jr. 2. Frank 3. S.F. of Nashville, a banker
4. Richard H., born near Lebanon, Tennessee (not certain that he is a brother to W.C. and Frank)

One Richard H. Kittrell, son of Marion Kittrell born in Wilson County, October 23, 1850. His mother was Matilda Haynie. He married Mollie Shuh June 19, 1889. He was a Democrat and prominent resident farmer of Cannon County and Rutherford County, Tennessee. He is buried in the city Cemetary in Murfreesboro, Tennessee.

Isham Kittrell, son of Jonathan II, was born 1759 in N.C., Granville Co. He married Ann Alston Hunter, daughter of Martha Alston and Isaac Hunter of Carolina. One authority gives this as Ann Alston while others considered more authentic, give it Ann Alston Hunter. Isham and Ann Kittrell left N.C. and settled in Montgomer Co. Tenn. where we find much in the records of their descendants. The facts are that in 1794, Isham and his family came to Sumner Co., Tenn. from Granville Co., N.C. In the records of Sumner Co., Tenn. book of deeds #2, page 357 is given a deed of purchase of land of Isham Kittrell which shows he was from Granville Co., N.C. and that the deed was registered in both Duplin Co., N.C. and Sumner Co., Tenn. (Sumner Co., Montgomery Co., and Davidson Co., were the first three counties of Middle Tennessee. All 3 join and it is often that persons settling had their transactions recorded in the county seat nearest their location and it was not always the seat of the county in which they lived. This fact is accredited to the facts that both Sumner and Montgomery Counties have records).

Isham Kittrell married about 1779, Granville or Warren Co., N.C. Family records prove that Isham only lived a very short time after the arrival of the family to Tennessee. Then in 1809 Ann is found to purchase land in her name in Montgomery Co., Tennessee from Mr. Minor of Huntsville, Alabama. It is supposed that Ann had gone to Montgomery Co., or nearer to her husband's brother Isaac's family who had settled in Montgomery Co. Sometime after 1800, Ann, widow of Isham, married a Mr. McGowan of Montgomery Co., Tennessee. The exact date of her death is not determined between it was between 1812 and 1820, and evidently in Montgomery Co. as that was her home during her last marriage. Isham and Ann had six children of whom we have record, all born in N.C. except the youngest who was born either just before they left N.C. or soon after their arrival in Tennessee. From the deed of the land purchased by Isham it is supposed this child was born in N. C. Isham died in Sumner Co., Tennessee in 1799. Ann Alston Hunter was born in Warren Co., N.C. 1762. Their issue:

1. Jonathan
2. Sally
3. Patsy
4. Eaton Hunter

5. Solomon Alston, who was born 1788 in N.C., Granville Co., married Mary Ann Brodie or Browdie daughter of Dr. John Browdie of N.C. The Browdie family had migrated to Montgomery Co., Tennessee along about the time of the Kittrells and they had come from Granville Co., N.C. in Hillsborough District sometime after 1790 and before 1800. It is very likely that Dr. Browdie took Solomon A. Kittrell, the son of his friend of their former home in N.C., to educate him in the medical profession. You will see from the records following this sketch, that Solomon Alston Kittrell was a doctor, as was his father-in-law, Dr. John Browdie of Montgomery Co., Tenn. (later)

6. George Hunter Kittrell, who was born in 1792-3. He was a soldier in the War of 1812. (Later)

Solomon Alston Kittrell, son of Isham, was as has been said, a doctor in Montgomery Co., Tennessee. In Montgomery Co. records the first transaction found wherein his name appears, was in 1809 where he purchased from William Tubb land which is recorded in Book of Deeds I, page 635. Solomon married a daughter of Dr. Browdie in about 1805. (Marriage bonds 1805-6-7-8 and some other few scattered dates are missing on account of fire in this county some years back, such records as were preserved from this fire are filed in the Court-house at Clarksville at this time, but a few of the years and packages of bonds of certain years were not saved. The records of 1800-2-3-10 and many others are now filed in the Clerk's.) Issue of Solomon A. Kittrell and his wife, Mary Ann Browdie Kittrell:

1. Ann T., married Mr. Harrison and lived in Montgomery Co, Tenn.
2. Mary Ann born about 1807 in Montgomery Co., Tenn. It is not known who she married but she may have married John Kittrell. (This however is supposition)
3. Martha Elizabeth, born in Montgomery Co., Tenn., 1809, married Rev. Finch Philip Scruggs of Williamson Co., Tennessee.

Martha Elizabeth Kittrell, daughter of Solomon A. Kittrell was married in Montgomery Co., Tennessee to Rev. Finch Philip Scruggs, in 1826 and it was in Montgomery Co. that they resided for a considerable time until they removed to Northern Alabama and later on West of the Miss. Martha died in 1836 and Rev. Scruggs married again. Among the issue of Martha E. Kittrell and Rev. Philip Scruggs was: 1. Solomon Kittrell Scruggs born September 20, 1830 in Montgomery Co., Tenn; died September 28, 1908 in Texas. He married Martha King Pendergrast (Pendergast, Pendergrass) who was born June 12, 1837 in Madison Co., Tennessee. They married in Texas June 30, 1853 and she died November 24, 1917. Rhoda King Pendergrast descends from a notable N.C. and Tenn. family and from the Love family of Augusta Co., Virginia and Davidson Co., Tenn. Solomon Kittrell Scruggs and his wife Martha King Pendergrast Scruggs were borne issue among which Martha or Mollie Scruggs, born September 20, 1857 and who married September 4, 1884, died February 17, 1907. She married a Mr. Noel Jackson Clancey and they have a daughter, Leslie May Clancey, living in Ft. Worth, Texas.

George Hunter Kittrell, son of Isham Kittrell was born 1792-3 in N.C., Granville Co., came to Tennessee and settled in Sumner Co. until he was a young man. George served in the War of 1812, enlisted September 20, 1814 under Col. Lowry and Capt. Looney in West Tenn. Infantry. He received a grant in Maury Co., Tenn. for the services rendered. He first settled in Sumner Co. where his parents had settled. In the Sumner Co. records there is recorded in Deed Book II page 276, Aug. 18, 1820 transactions between Fielding Grimsby and George Kittrell

both of Sumner Co. And in 1818 in book of deeds 12, page 134 George Kittrell purchased from James Douglas land in Sumner Co. George Kittrell left Sumner Co. and moved to Williamson Co. in the edge of Maury. He married Bettie Rutherford in 1818 in Sumner Co., Tennessee. He died in 1867 and she in 1865. Bettie Rutherford was descended from the notable Rutherfords of Sumner Co. Col. James Rutherford was her father. Issue of George and Bettie Rutherford Kittrell:

1. George W., born in Sumner Co., Tennessee, January 26, 1825, Married Mary J. Walker 1850. She was from Davidson Co. (later)
2. Robert H. Born November 30, 1839, living in Williamson Co. in the edge of Maury at Thompson Station, one of the eldest living men of Middle Tennessee. He was a Civil War veteran. (later)
3. Elizabeth 4. James 5. William 6. John 7. Addaline
8. Rufus 9. Tom 10. Benjamine 11. Another 12. Another 13. Another

George W. Kittrell, son of George Hunter was born January 26, 1825, in Sumner Co. He became a merchant at Loco, in Maury Co., Tennessee; was a soldier in the Mexican War serving under Capt. A.G. Cooper, Co. of J. E. Thomas Regiment and served as a Sargeant in same. He returned to Maury Co., after the war and engaged in farming. In 1850 he married Mary Walker of Davidson Co., Tennessee. In 1855 he moved to Perry Co., Tenn. and engaged in merchandising and farming and was postmaster of that place. Moved back to Maury Co, Tenn. and was postmaster at Loco until his death. Issue: 1. James B. 2. Pheliz H. 3. Cicely A., married Kenneth Wade and they lived in Maury Co, Tenn. at the old home of her father. She died in January 1929 on the day the authoress of this sketch wrote her for records of her family. Her daughter answered but knew nothing of the family. I have visited her home since I talked with Mr. Wade. They reside near Carter's Creek, Maury Co., Tenn. Mr. Wade showed me the graves of George Kittrell and family. There were 2 daughters. 1. Georgia 2. Lorena, both single and living at home with their father. 3. Another 4. Another

Benjamine C. Kittrell, son of George Hunter Kittrell was born February 24, 1832; married Martha Jane Dowdy who was born November 24, 1845. Benjamine served in the Civil War under the command of General Bragg. After the war he settled in Perry Co., Tenn. and engaged in farming at a place called Farmer's Valley until his death October 4, 1890. Martha Jane Kittrell died March 29, 1913. They are buried at the Kittrell Cemetary in Perry Co. at Farmer's Valley, Issue:

1. Izora Braxton, born March 16, 1862
2. M. Breece, born Ocrober 12, 1865
3. M. M. born December 27, 1867
4. M. C. born March 7, 1870
5. Benjamin Roscoe, born February 9, 1873
6. George Hunter born May 5, 1875
7. Lula Gregg, born September 16, 1877
8. Mattie B. born November 29, 1879
9. James R. born January 19, 1882
10. William Lamar, born October 1, 1884
11. Dorothea Whitney, born January 24, 1887
12. Simon Trigg born March 8, 1889

William L. Kittrell married Margaret Ellen Craig who was born February 19, 1900; married September 28, 1919. They resided for 2 years in Perry Co. on a farm after which time they moved to Hohenwald, Tennessee, Lewis County where he and his brother Hunter bought a garage. They still reside there. Margaret Ellen is the daughter of Wiley Craig and Louise Thornton, both deceased. Issue:

1. Martha Louise Kittrell born August 1, 1920
2. William Benjamin Kittrell, born September 26, 1921
3. Frederick Jones Kittrell, born December 30, 1928

Martha Louise married Jean M. Saulnier August 20, 1941. He being employed by U.S. Government as a civil engineer. Issue:

1. Stephen Craig, March 15, 1943
2. Margaret Louise, June 3, 1946

John Kittrell, son of Jonathan I, of Whowan Co., N.C. seems to have been a Revolutionary soldier. Vol. 22, page 327 N.C. State and Colonial Records "A list of men commanded by Captain James Alston taken 25th November 1754 shows among them John Kittrell, Jr. and Samuel Kittrell and John Kittrell." Issue: (will dated November 22, 1792. Proved Bertie Co., N.C. 1893)

1. Dempsey, married Martha Spivey, June 19, 1777 Bertie Co., N.C.
2. John married Mary Lassiter, April 19, 1794, Bertie Co., N.C. and Stanley Kittrell went security. He made his will in Bertie Co., N. C. in 1801 and named his wife Mary and Stanley Kittrell executors Test: Henry Speller, Jr. Nancy West (Bertie Co. records) He had a son, Frederick Kittrell.
3. Willis
4. Stanley married Prudence Jordan, January 13, 1799, Bertie Co., N. C. with Benjamine Folk, security.
5. Sarah died unmarried. Her will: Bertie Co., N.C. February 1797 and mentions brother-in-law-, John Kittrell, Willis Kittrell, and John Kittrell, executors of Jno. Kittrell 1st deceased, John Kittrell, sister Jemimia Kittrell, Bro. Stanley Kittrell, Bro. Dempsey Kittrell, Bro. John Kittrell and his son Frederick Kittrell, John Kittrell and Aron Spivey Exec. Test. James Ross, Sela Walton.
6. Louisa married John Kittrell of Granville Co. I think this John to be son of Jonathan II. They married April 10, Bertie Co., N.C.
7. Jemimia

Dempsey Kittrell's will January 27, 1797 proven February 1797. Wife Martha and all my children, executors Aron and Jonathan Spivey Test - Jeremiah Leggett.

Mary Kittrell of Bertie Co., married Alexander Leggett February 2, 1788. Ruth Kittrell of Bertie Co., married Joshua Kittrell of Granville County.

Belson Kittrell married Nancy West August 19, 1803. Elisha Pender, surety. Bertie Co., N.C. I do not know whose son Belson Kittrell was.

Another branch of the Kittrell family of which I have record, although unable to make proven connections with the earlier family in N.C. is that of White County known as the "Preacher Kittrell" line; so called because of the large number of preachers descended from it.

William Kittrell and his sister, Nancy Ann Kittrell were in White Co., Tennessee as early as 1826. Nancy Ann married Dabney Baker of White Co., Tenn. If they had issue I have no record. William married first a Miss Sullivan of White Co., Tennessee and later a Miss Bartlett of that county. By the 2 wives he had issue:

1. Lucy, married Mr. Sparks
2. Ann, married Mr. Cope
3. Rev. John Kittrell who was a Presbyterian minister of Smith Co., and White Co., married Lucinda Nelson and had 2 daughters.
 1. Mrs. Walter James of Gordonsville, Tennessee. She was May Kittrell. Rev. John's widow was living with her last I heard of Mrs. James.
 4. Rev. Thomas Kittrell, brother of John and also a minister of the same faith. He is father of Prof. Tom Kittrell of Cookeville, Tennessee. Tom Kittrell was in the State Senate only a few years back and is a prominent citizen of Cookeville, Tennessee.
5. Jacob
6. Billie
7. Mary
8. Becky
9. Simon

Another line which is not known with all its early connections with the early family is that of Pleasant Kittrell. His eldest sister was Sarah Williams, one brother William and another Jonathan, another Thomas and a sister Mary. They lived in Granville Co., N.C. and moved to Alabama about Selma, Marion Co., and Greensboro. Sarah Williams married Dr. Goree and Pleasant and the Goree family moved to Texas in 1850 and both died in that state. William and Jonathan died in Alabama. William had three sons, Prof. William Kittrell, Dr. Benjamin and another who was a doctor also. They lived in the vicinity of Black Hawk, Mississippi.

John's son, John R. moved to California in 1851 and then to Nevada where he became attorney general then returned to California and died at Fresno, Calif., some twenty years ago. One daughter, Molly Kittrell Welch died in Fresno, Calif. There were two Welch boys both became lawyers in California.

Norman George Kittrell of Texas was Judge (district) Supreme bench for 20 years. He was a son of Pleasant Kittrell. Pleasant Kittrell was in Legislature from Orange Co., N.C. in 1830 at 25 years of age and member of Alabama Legislature 1847 from Greene Co. He moved to Texas 1850 and Texas Legislature in 1854 and 1858. Norman George Kittrell, Sr., was in Legislature from Texas in 1909. His son Norman, Jr. was in Legislature from his district in 1924. He is living.

It is probable that this line came from Solomon Kittrell but we have nothing to prove this. Pleasant was a son of Bryant Kittrell of Granville Co., N. C.

There are many by the name Kittrell and persons descended from the Kittrell family now living in Tennessee, especially in White, DeKald, Warren, Putnam, Smith, Williamson, Maury, and Davidson Counties Tennessee and in Warren, Vance and Granville Counties, N. C.

All the Kittrell's I have come in contact with descend from the N. C. Kittrell family of this lineage.

Notes of Interest on the Kittrell Family

Montgomery Co., Tennessee. Will of Solomon A. Kittrell. Recorded Book B., of wills 1811-1818 page 389 speaks of him as of Clarksville, state of Tennessee. Speaks of Clarksville and of having property in Clarksville. Mentions his father-in-law Dr. John Brodie and brother-in-law, Thomas Brodie. Mentions wife and children but does not name them.

Sumner Co., Tennessee. Records. Deed Book 2 page 357 James Briston of Cumberland Co., state of N.C. of one part and Isham Kittrell of Granville Co., N.C. Kittrell purchases from Briston land in Sumner Co. May 20, 1793. His deed has the county seal of Duplin, N.C.

Montgomery Co., Tennessee. Book of Wills 1818-1821 page 113. Inventory of Solomon A. Kittrell (this requires 4 pages showing he was a man of wealth). Filed October 22, 1818. Recorded January 1819.

Montgomery Co., Tennessee. Will Book c, page 419. Bond where John Brodie signed for Mary Ann Kitterall and Martha E. Kitterall, January 1821. Guardian Bond.

Martha Alston married Isac Hunter who died in 1815, in Warren Co., N.C. The following children are mentioned:

1. Solomon Hunter, mentioned in Will of Solomon Alston, Sr.
2. James Alston Hunter
3. Jacob Hunter married Patience Williamson
4. Ann Alston Hunter married Kittrell
5. Patsy H. married Williamson
6. Sackey married Nicholson
7. Sally married Estie

Isaac Hunter was a son of Isaac Hunter who died in Chowan Co., N.C. whose will dated April 17, 1752 and proved April Court 1753 and whose children are:

1. Elisha
2. Jessie
3. David
4. Hannah Reddick
5. Rachel Walton
6. Jane Philips
7. Alec Perry
8. Isaac married Martha Alston
9. Jacob
10. Elizabeth Perry
11. Sarah Hunter

This History of the Kittrell family was compiled by Edythe R. Whitley, 2710 Belmont Blvd., Nashville, Tennessee, in 1936.

Estate of Nathaniel Mitchell

Died - 13 September 1880

Appraisal of Total Estate ————— \$146.30

Public Auction of Total Estate

For Cash ————— \$157.35

Disbursements

————— \$73.10

- * 9.75) Court Costs
- * 6.35)
- * 1.25 Justice of the Peace
- * 6.00 Meridian Mercury
- * 6.00 3 Appraisers
(1 days work each)

Administrator's
Commission
7% of \$157.35 — \$11.01

J. R.'s share
of remaining
Cash — \$68.24

→ * 4.00 2 Clerks at Public Sale

————— \$152.35

* 13.75 feeding livestock
* 6.00 2 days hauling with wagon and team

J. W. evidently
pocketed
\$5.00

————— \$20.00

————— \$73.10

————— \$157.35

Cost of holding public sale

Dear Mary:
 Let's walk thru my recent work.
 Coats (Coates - Cotan)

1840 Sumner Co al. Census

Washington Coats 1 male under 5 1 male 30-40

There was also a John Coats

1850 Sumner Co al. Census

714-729	James H Coats	31	Farmer	t al (1819)
	Laura A	26		t al
	William W	9		t al
	Josiah	7		t al
	Margaret A	4		t al
	John P	2		t al
	Benjamin C Watson	21		t al

604-815	William W Coats	40	Farmer	\$3,000 t Jan (1810)
	Malinda B	30		t al
	Sarah T	17		t al
	John	12		t al
	Mattha	10		t al
	Harriett K	8		t al
	Louisa H	3		t al
	Julia E	1		t al

1850 Randolph Co MS Census

2-2

In the household of Nathaniel there was a Robert R age 8 t MS in 1842. Could this be the Row? Robert Row, in 1857 he would have been 15 years old when J Row was born - NO - but he could be

at the Row killed in the Civil War - that is Robert R

5-5	we have: William Coats	50	\$200 t SC (1800)
	Jane	36 (second wife?)	t SC (1814)
	Thomas A	13	t MS
	Elyza P (7)	7	t MS

This is the William Coats who had many sons
 Kittrell
 as Jane
 part with t

Close by was CC Frasier 26 t al (1824)
 Close by also was Malford Kittrell (in Parker household)

Simon shot for Simon?

1850 Lauderdale Co Census

141-147	Simon COATS	80	Farmer	\$400.00	t SC 1770
	Levina	30			t SC (1820)
	Elizabeth	25			t SC (1825)
	George	6		\$1,000.00	t MS (1844)

Who was Nancy the wife & who was George?

Levina m'd Daniels - Elizabeth m'd Busby. George has to

be a grandson - The way it is listed he appears to be

son of Elizabeth? Simon did near early 1854 - Nancy

the wife alive in 1855. No last name given for George above

We have Nancy Coats on 1870 Census living alone

76 t Va 1894 - So Nancy for some reason got left

off the 1850 Census record

We have a George on 1870 24 t MS (1846) in Book

three. The George last name indicated as Coats so he has

to be one of Simon's child. Nancy could have been sick

and listed on the 1850 mortality schedule

716-741	John Coats	46		\$140	t SC (1804)
	Lydia	46			t Ga
	William P	34			t Ga
	Caroline	22			t Ga
	Jane	17			t Ga
	Alameda	14			t Ga
	Wilson? P	12			t Ga
	Susan E	11			t Ga
	Lucy A Falls?	7			t Ga
	Lezelia	2			t MS

fn 100 - passing out of existence -

<u>1840</u>	<u>1850</u>	<u>1860</u>	<u>1870</u>	<u>Names Used</u>
Nat. 30 (M)	Nat 40 (M)	Nat 53 (M)	Nat. 60 (M)	"Nathaniel"
Jabitha (20-30) F	Jabitha 30 (F)	Jabitha 44 (F)	(deceased)	"Jabitha"
John W. (Under 5) M	John W 14 (M)	John W. 24 (M)	md. (1860)	"John Washington"
Elisha B. (Under 5) M	Elisha B. 13 (M)	Elisha P. 23 (M)	md. (1867)	"Elisha" "E. B." or "Lick"
Margaret Ann (Under 5) F	Margaret Ann 11 (F)	Margaret 19 (F)	Margaret 28 (F)	"Margaret"
Ann (Under 5) F	Rosey Ann 10 (F)	Rose P 17 (F)	md. (1868)	"Ann"
	Robert B. 8 (M)	Robert B. 16 (M)		
	Mary E. 6 (F)	Elizabeth 14 (F)	md. (1864)	"Elizabeth"
	Amanda 4 (F)	Amanda A 13 (F)	Amanda 20 (F)	"Amanda" or "Mandy"
	Caladonia 2 (F)	Caladonia 11 (F)	md. (1868)	"Callie"
	Francis J. 6 1/2 (F)	(omitted from 1860 census -)	md. (1867)	"Fannie"
		Mary M. 8 (F)	(deceased)	"Mary"
Nat's mother (60-70) F		William W. (M)	William W. 13 (M)	"Billy"
Josiah (30-40) M		Moses 1 (M)	(deceased)	"Quadder"
Henry Milford (15-20) M			Calvin R. 16 (M)	
			Township 7 Beat 1 P.O. Manion Station	"Mary died when she was small"
Nathaniel mother died before 1850 -	Farmer Real Estate \$200. ⁰⁰ Parents h. S. C. Children h. mo.	Beat 3 Waleville Farmer Real Estate \$600 John W. + Elisha - farm laborers	Nat. - h. S. C. 1810 Marg. h. mo. 1840 Amanda h. mo. 1850 Wm. W. h. mo. 1857 Calvin h. mo. 1854	"Quadder died at 6 or 7 yrs"
No sign of his father	Kept door to <u>Isam</u>	gross error in <u>ages</u>	Jabitha d. before 1870. Ages do not jee with 1860 census	"Rose killed in the war"
			Elisha next door	

Notes made 28 November 1963

Thanks giving

Pa! Nathaniel Kittrell - father (Came from South Carolina
Ma! md. _____ wife died when Amanda was 6 yrs. (1833/1835)
old -

1. Amanda Viing Kittrell - Brown (1875)

(Washington)

2. John Kittrell md Martha Weatherford (1860)

1. Robert

2. Lillie Navis

3. Minnie

4. Wilbur

Robert

Lillie (Pack) I assume this is meant to be "Pearson" Waddell

Minnie (Valentine)

Wilbur

3. Elisha (Lick) ^(Elish) Kittrell md. ⁽¹⁸⁶⁷⁾ Mug ("Aunt Mug")
Evidently "Margaret Jane Redbury"

1. Allie Kittrell md Lon Spears

2. Lelia

3. Charlie Navis

4. Dora

5. Will

6. Stevie

1. Allie

2. Lela

3. Charlie Waddell

4. Dora

5. Will

6. Onnie

4. Ross Kittrell - could this be Robert B. ?

Killed in war or lost in war - Navis

(Died In Battle - Never knew any more) Waddell

5. William (Belly) Kittrell md. Mattie Lowery (moll) ^{(Lowery) Waddell}

1. Eddie
 2. Clarence
 3. Bonney
 4. Lewis (Louis)

5. Annie
 6. Ollie
 7. Betty ^{probably the grand-daughter "Betty"}
 8. Mary Mc Graw

Katie
 Mattie Gibson
 Waddell - no # 3 or 8.

6. Margaret Kittrell md. Joe Hines (1878)

1. Willie Hines md. "Willie" Clay (Will Clay)
 2. Mattie Hines md. "Caba" Clay (Colby Clay)

7. Callie Kittrell md. Hugh Sharpe (Shark) ⁽¹⁸⁶⁸⁾ _{← (Waddell)}

1. Ben Sharpe (son)
 Lived at Meudier Davis

1. Robert
 2. June Waddell
 3. Ben _← Marnie
 4. Rilla
 5. Annie
 6. Evie

8. Fannie Kittrell md. Elijah Green (13 children) ⁽¹⁸⁶⁷⁾

1 Ben
 2 Lor
 3 Joe
 4 Ed (Edd)
 5 Hugh
 6. Mally (Mollie) died

7 Lula md. Walker
 8 Minnie md. Fredrickson
 9. Ora md. Green
 10 Bessie md. Griffin
 11. Lillian md. Miller

9. Elizabeth Kittell md Bill (George or Bill) Payne (1864)
1. Calvin? Elizabeth md. 1864, this could
not be Calvin b. 1854.

10. Ann Kittell md Doc (Dock) Weatherford (1868)
1. Charlie There were 5 sons -
"died away from here" - (Does this mean she died
not die in Lauderdale Co. ? I certainly
tho it she did.)

11. Gudder Kittell - died 6 or 7 yrs. of age -
Evidently the baby Moses -
(Gudder died 15 yrs. old) (Waddell)
(At the bottom of this list, Mrs. Waddell says Gudder
died 6 or 7 yrs.)

12. Mary Kittell - died small - (Mary m.)

Amanda Kittell (b. 1846) md. David Wesley Brown

1. James Albert Brown md. Mary ?

2. Mittie Lee Brown md. Ewell Parker

3. William Gus Brown md (1st) Fannie Parker
md (2nd) Emma Ross

4. Ada Frances Brown Mrs. Joseph Peter's Wedgworth

5. Stella Eliza Brown Mrs (1st) Elz Buckler
Mrs (2nd) Mary Sue Russell

Mrs. Mittie Lee Waddell
Route 3 Box 50 ~~50~~
S. Hall, Mississippi 39328

November 28, 1963

Therapsyging

Amanda Mary Kittrell
grandmother Brown's brothers and sisters
grandmother Blain

Nathaniel Kittrell, grandmother Brown's

father -

John Kittrell -
married Martha Weatherford

Robert, Willie, Mennie
Wilburn

Elisha Kittrell -
married Meg

married for 3 years
Callie Kittrell, Felix, Charlie,
Dora, Will - some

Ross Kittrell

Killed in war as lost in war -

William (Billy) Kittrell
married Mattie Lowery

Geddie, Clarence, Bonny,
Fleming, Annie, Albie,
Betty - Mary m. - Chas

Margaret Kittrell
married Joe Hines

Ullie (Clay)
married Ullie (Clay)
Mattie - married
Cuba Clay

Callie Kittrell -
married Hugh Sharpe

(Ben Sharpe) son
lived in Meridian

Jennie Kittrell
married Elijah Green

(Ben, Joe, Joe Ed, Hugh,
Mae, Julia, Mennie, Chas, Besse,
and Fella)

Elizabeth Kittrell
married Bill Payne

Ann Kittrell
married ^{Doc} Weatherford

Charlie's

~~Parents~~
Shelton James Brown } Married
married ~~Phyllis~~ Hendrix } in
Ayrhaha } 1853
} in
} Lauderdale
} County

(^W Dan Brown married Amanda (Miss)
Kittred

Delia Brown married Boone Partin

Alfred Brown married Dan Dayton
(Henry)

W.T. (Belle) Brown married Blanche
1871 - Evan Brown

^{Brown}
Martha Hall - Phyllis Parents
married Jim Hall

Arvidy Brown married Henry Hall
(Virginia Hall)

Shelton Brown married Mennie Akins
Annie Brown married John Keeter
(Florence's mother) (died)

John Brown - 1891 - 21 yrs old
Aunt Brady Brown married Robert Peromote
Mattie 2

Mary Lee Brown married James Green
Ada - Brodie

Found some good info. for you

1/29/85-

Bethel Cemetery - Nellenburg

Mother

Julia ANN Coates

2/28/1878 9/8/1910

Oak Grove Methodist 1847 - 1949 Clarksville

Madison Coats - no date

(Age 455)

MT Carmel PRESBYTERIAN Cemetery

Mardy S Coats

8/1/1831 1/16/1909

Graban Cemetery - Valley Road - Mendon

Anne E Coats

8/10/1860 - 9/14/1946

Daisy Coats - L - S 5/22/1918

Mother

Mae Coats Moore

2/9/1878 - 11/18/1968

Graban C Coats

8/23/1884 10/30/1968

Christine Coats

10/1/1911 6/20/1915

William David Coats

3/22/1851 - 4/27/1924

1870 Clarksville Co Census

493-493 - Page 120.

Amanda Coats 22 Lms with son William P 2 Lm
in household of James M. Bustin 49 Lms

Age 153
270-270

Township 8 Beat 3 (Lockhart was P.O.) near Figgins

Coats George	24	h m (1846)
Amanda	25	h ms
Annie	3	h ms
Jane M	2	h ms

Page 2
23-23

T S. P.O. Meredith

Coats, James E	50	h al (1820)
Harriet A	35	h al
James	19	h ms → (appear to be 20- 3 15 W.??)
William	9	h ms
Sarah E	6	h ms
Charles	4	h ms
Hannah? A	2	h ms
Eleck	6/12	h ms

Page 142
118-118

Township 8 Beat 3 no P.O. Listed
Coats, Nancy 76 h Va. 1894

Page 22
18-18

Boatner, Jacob	74	h al (1896)
→ Moore, John	33	h g
Decie	24	h ms
Merritt, N (c?) A	9/12	h ms
VAN Buren, Hannah	19	h ms
Ann	5	h ms
COATS, William	42	h Ga (1828)
TABITHA	39	h al (1831)
John	16	h ms
Buck	13	h ms
George	8	h ms
James	8	h ms
Thomas	6	h ms
Verey J	5 7	h ms
Joseph P	2/12	h ms
America A	2 7	h ms
Lewis, Laura	15 7	h al

Quinta
Rouse
full.

Jack Pot:

ms

Wall Feb 11. 107 Cherey Clerk office - Lauderdale Co

SION S. COATS ESTATE - Benjamin Meador Admin
A Citation notice issued on ~~2/12/1855~~ 10/4/1855

Citation issued to:

- Nathaniel Kittrell and wife
- Ezekiel Daniels and wife
- William M. Busby and wife
- Allen Wilkerson and wife
- Nancy Coats

They were to appear on the 2nd Monday in October 1855

recorded

The first date was 2/12/1855 - This was Benjamin Meador submitting bills against the estate. So died in late 1854 or early 1855. Got to get to the 1850 Census records - Great!! for final settlement of the estate

William J. Daniels was the Probate Judge.

On another document - undated - gene location of persons and I take it these are his children + possible some husbands are named

- | | | | | |
|--------------|------|-------------------|--------------------------------|--|
| This is 1855 | 1 - | Mary Laurent | Lauderdale Co. | This name on one of your no documents - re school 1870 |
| | 2 | Martha Dykes | Jones Co | |
| | | Cynthia | | |
| | 3 - | William Coats | Jones Co | |
| | 4 | Cynthia Sellers | Jones - John Sellers (SELLERS) | |
| | 5 -> | Daniel Coats | Jones | |
| | 6 | Levina Daniels | Lauderdale | no record was filed |
| | 7 -> | TABITHA Kittrell | Lauderdale | |
| | 8 | Elizabeth Busby | Lauderdale | |
| | 9. | Sarah Wilkerson | Texas | |
| | | (Allen Wilkerson) | Texas - Husband | |

at the top of the list was

Widow - Lauderdale. ok how I wish it had given her given name

On this last list the name Nancy Coats left off so I figure the Widow name was Nancy Coats
Got to be.

0

Was glad to find this file. Will soon start with file no 1 + gather info - then on to 2 + so forth

Then Navy Coats alive in 1870 at age 76
to Va 1894 - so J W would have remembered his
grandmother. ~~This is not the document~~

Apparently she was living alone

Sioux I signed with ⓧ

There appears to have been only two sons, brothers
of Jabitka + both were in Jones Co in 1855-

Now we know or could guess why J R + J W went
to Jones Co - Samuel etc. They had Coats her then
William + Daniel were brothers to Jabitka and uncle
to J R. Jabitka mother remained + died in Lauderdale
Co

Since Sioux alive in 1855 - the 1850 census should
reveal more info plus the 1860 census

Plan to leave early in the morning + be in DeSoto
about 8:30. Got a full days work there

I am really disturbed about the Wall files. Have found
many of the files Empty. Part of Sioux file was missing.
The document - where Ben made a copy of the adms was
missing. If I had not been for that one small piece of
paper - the citation we would never have known that was
his daughter

After trip to DeSoto + visit with Mrs Davis +
Mrs Weddell I plan to work the census records
Saturday - so we should have a fairly good picture.
Also went to check original land entry book to pinpoint
Sioux land. Strange no mention of land when estate
settled. Somebody removed documents - have found them
in a number of cases lately. Have talked to officials
re: this. People can take things out ever today

Must close - wanted to get them to you for it
fills in blanks re the Coats. Have not reviewed - plan to
do this after Saturday.

Time now to go. Agree goes in with me on
Wednesday. It has beauty shop day. I'll be doing my
best tomorrow to get J Rose in somewhere

More later
Jim

1/31/84

Dear Mary

It was quite a day yesterday. Worked in Court house until 11 AM - found little - went to Schray + found it closed for the day. So no Cemetery records could be checked. Called + talked to Mr. Rex Semmick a few minutes.

I thought he might visit me by + give me the material he has. Told me he'd mail it. He appeared to be doing nicely.

Went back to Daleville. Talked to Mrs. Davis receiving directions to Bill Wright house.

Bill Wright is a retired disabled Navy Chief Petty Officer. He was anxious to talk when I called. We had coffee + talked for 45-

He ~~owns~~ owns the land where the house with the dog stands.

I took one look around + got really excited. It is not a house that enclosed some of the old girls quarters.

It is the old dorm!! Got to be. The Chimneys are the same as in the picture. The Window - The Cedar trees in the yard are now HUGH. The one picture where you have

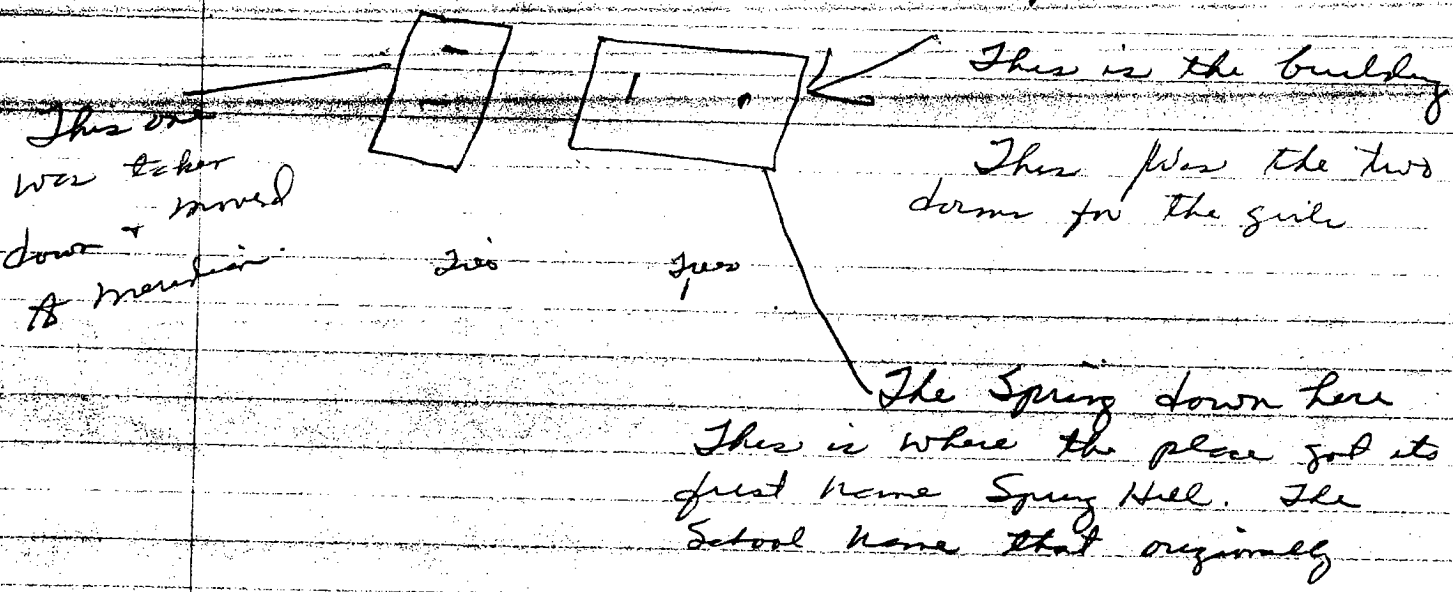

Kittrell - COATS

Wall file 13-126

Coats Simon estate of R B H admr

unable to locate so far. Could be Simon?

Probably one + the same. No Simon elsewhere -
not on original Land Entry Book but
SIMON is.

1870 Lauderdale Co Census

Box 3 P.O. Marion

Page 151

238-238 Daniel Lavina 51 + SC (1819) ^{daughter?}
Simon

Julius C 15 + MS

Lavina was 36 yrs old in 1855.

Marriages:

1844 Susan Coats md Absalon A Thompson

1852 Nancy N Coats md Edward Stafford

1853 Sarah J Coats md Augustus D Logue?

1854 Mary M Coats md Franklin Chiles

1859 ~~Amanda~~ ^{Amanda} Coats md Jefferson Trulove

Susan E md James Trulove

1867 Mrs M M T md James W Cochran

1868 J E Coats md Paul Alexander

mds

1853 John W Coats md Elizabeth M Messergale
(This person on the record a good bit)

1860 W P Coats md Margaret F A Blanks

1867 W W Coats Jr md A E Bustin

You have notes that I sent. If need be I'll get
more info on those above as we go along

Kittrell

Book of Original Land Entries, Lauderdale Co MS
In checking the land John W Kittrell got on 1/23/1872
under Certificate 5979 in S 27 T 8 R 16 E - This
S 1/2 of SE 1/4 - 80 acres was cancelled. Apparently this
land belonged to the RR and reverted back to some
on 1/6/1881. There all in a very small writing over to
the right hand side of the page

Nearby was H M land - He had two (2) 40 acre
plots - One of the 40 acres had been reserved for an
Indian that apparently never claimed it

C. C. Francis also owned some land that was taken
back.

1/9/1836 Allen Francis received 160 acres - Certificate 24029
& 159 acres under Certificate 15815 - He must have been
Rev. Soldier or Veteran of War of 1812 - Will check more on this in
2/1/1836

1/1/1838 Daniel Coats received 40 acres Lot 109 in S 2 T 8 - R 16 E
under Certificate 31053. This Certificate was a
Certificate on Purchase from one of the various Land
offices operated by the government

This land just east of present Daleville

12/9/1836 Wilbur Coats issued by Certificate 29763
E 1/2 SW 1/4 Lots 14 + 19 80 acres in S 2 T 8 R 16 E

All this in then or near where Nathaniel lived

Wilbur also on 12/27/1836 received another 40 acres
in S 9 T 8 R 16 E - just south of present Daleville

11/2/1835 Swan Coats (COATS) under Certificate 19372 received 40 acres
NE SE 1/4 in S 11 T 8 R 16 E. This in front of the Heckerly
Home Cemetery. And on 6/13/1836 under Certificate 27990
he received 40 acres NW 1/2 SW 1/4 in S 12 T 8 R 16 E (just east of land
in S 11.

Nathaniel Kittrell was in S 13 T 8 - R 16 E - 80 acres - part
section 5 of S 12.

All near the lands of Sam Dale

other.

1/12/1848 Parkin y Tarrant in 515 T8 R16E

12/9/1836 Aller Wilkerson in 512 T8 R16E 40 acres

1/16/1835 James R Coats in 512 T8 R16E

This Coats has to be a brother of Sions - We don't know.

10/18/1890 Amanda Coats in Lot 17 40 acres S3 T8 R16E

Later marked through Dalville

This is all very interesting. It would have been nice to have located Nathaniel father

We have Elizabeth Parents. Can't see how Walker or Daniel and a Nancy J. Kittell? Need to research before any comment.

Willed to his wife Nancy on the West side of the County

I enjoyed making the will. The iron cooking pot + oven were treasured items in this days. The oven no doubt set over coals & fire to bake bread

139-145	Allen Welberson	48	farmer #50	T SC
	Sarah (Sue Langdon)	38		T SC
→	William W	16	Farmer	T SC
	Sentha (Cynthia) E	15		T SC
	Mattha L	14		T MS (1836)
	Mary	12		T MS
	Eliza	10 (twins)		T MS
	Richard A	7		T MS
	Francis	5		T MS
	George W.	1 1/2		T MS
	John B Brown	27		T Tenn

47-962 John W Coats T NC + white burial

Your Coats lived in general area of the Kittrells. You are correct I am fairly sure in your thinking that Nathaniel and others were in SC before they arrived here in Lauderdale Co.

There were no Kittrells on the Kemper Co Census records. I think there are Kittrells buried there and they may be late Kittrells. Hope to check cemetery lists soon.

The J Ross business is not cleared up yet in my mind.

Miss Waddell was sure there was a son of Nathaniel named Ross. Let's speculate Ross could have been older than J W. He could have had a son J Ross in 1857 - We know he was killed in the Civil War - so J Ross probably with his mother the Widow Kittrell in 1880 at age 68 to 1812 could have been Josiah's wife. We know Josiah alive in 1875. J Ross m'd Weston in 1877 - she died. He lived with his g. aunt. She needed help - It was close to Nathaniel. The J Ross needed help. Mary, daughter + the Widow helped with her son Robert. This

The 1 female 60-70 in Nathaniel household has to be Nathaniel's mother - since we know Simon Coak's wife + Isabella mother also in 1850

We have Isabella widow etc in household, her children - so I just leave the one line of recording the unnamed widow on 1880 census has to be the widow of Josiah.

The Jane Kettle t 1825 (35) in 1860 fits with HM t 1898 (I think reported her as t 1815)

I found no new Westhampstead in the checking of Census records.

If HM t 1898 he would have been 56 year old when he m'd Jane t 1825 would have been 29

HM probably m'd twice. Calvin 16 in 1870 t 1854 This does not fit with HM + Jane marriage in 1854

Let's recheck

Robert R 8 in 1850 - t 1842 - by 1860 he would have been 18. He could not have been father of Calvin R.

We have J Ross 23 on 1880 Census t 1857

Robert R would have been 15

Am going in circles May but I have to do this - (Some of these ages may be off) & reason it out.

I'm sure I was Robert Ross who died in Civil War. The Calvin R t 1857 has to be son of HM so we will leave that as is.

1860
1850 age

William W. t 1856

Mary M t 1852 (8) 6 (1846) (Mary E)

Callie t 1849 (11) 2 t 1848

Annanda t 1847 (13) 4 t 1846

Robert R t 1844

Wait a minute. Remember the marriage record of the J.R. in 1877 - m'd the Westons. On the record

in one place it is J.R.R.

J. Robert Ross

Alright Robert R. 8 in 1850 - 16 in 1860 - but
would be 18 in 1860 if the 8 is correct. Both ages
may be incorrect

What I am saying that Robert R. could be
the J.R. labeled as a son in the settlement and we
don't know how the J. Ross fits in but this doesn't
fit with Ross dying in Civil War

Oh yes this is a tough one. We have to assume
that the J.R. in the estate settlement WAS Nathaniel son. It
is a legal document.

The Robert R. (Ross) is the one that died in the
Civil War. We have no other record.

Now there is room for a J.R.R. to have been
born to Nathaniel & Fabeltha in 1857. This could be
the J. Ross we have at 23 in 1880

Amelia passed it down to her brother Ross
who left for and never returned from the Civil War. He
was near her eyes.

Nathaniel & Fabeltha were having children at a
steady pace. They experienced some deaths. Like the Mary
M. who must have died. Later they named daughter Mary E.
Somehow J.R. or J.R.R. got left off the 1860 census for
Nathaniel household

Have gone around the world but that is my
best shot at this. Elsie was the only one who more or
less stayed in the area until her death.

I think you can fairly well assume that
Nathaniel is buried at Hickory Grove

I hope you can see Nathaniel picture. Do you
know Mrs. Davis had never seen that picture. Nat
could pay for a stateroom. Very striking picture
Am pretty sure there were two sets of

THE DESCENDANTS OF RICHARD WEATHERFORD

Richard Weatherford was born October 23, 1801, in the State of Georgia (the family Bible establishes the date and the census reports the state in which he was born). He married Lucinda A. Furlow, who was born in Georgia in July of 1815, on March 3, 1831 (family Bible). The state in which they were married is uncertain but census reports indicate that of their five children, the two older children were born in the State of Alabama and the three youngest ones in Mississippi. They apparently moved from Alabama to Lauderdale County, Mississippi, around 1838. According to the census report of 1880, both of Richard's parents were born in England and both of Lucinda's parents were born in Georgia. This finding rules out a blood relationship of the Richard Weatherford descendants with the Indian Chief William Weatherford (Red Eagle) of Alabama.

Richard Weatherford was listed in the various census reports as either a farmer, a Baptist minister, or both. For the later years of life, he and his wife lived with their youngest son, Willam Gustavus Weatherford in Lauderdale County, Mississippi, during which time Richard suffered from a partial paralysis (census report of 1880). Apparently, both Richard and Lucinda were buried in Lauderdale County near the community of Daleville.

Henry
1866
1835
31
When GR h.

Known Children of Richard Weatherford and
Lucinda A. Furlow

1869
1835
34 and

Henry Richard -- Was born May 6, 1835, in Alabama.
Died in 1909. Married Emily L. Bishop.

Francis L. -- Was born January 14, 1837, in Alabama.
Died in 1883. Married Columbus C. Trawick.

Martha Ann -- Was born November 17, 1838, in Mississippi.
Date of death is unknown. Married John Washington
Kittrell. 1866
1838
28

When GR h.

Elizabeth Pamela -- Was born February 22, 1841, in
Mississippi. Died in 1924. Married William Madison
Hooks.

1870
1846
27

William Gustavus -- Was born December 3, 1846, in Lauder-
dale County, Mississippi. Died February 7, 1926,
at Harvey (near Hattiesburg), Forrest County,
Mississippi, and was buried in the cemetery at the
Sunrise Baptist Church east of Hattiesburg,
Mississippi. Married Ann Kittrell on May 28, 1868.
Ann died December 6, 1878, and William G. married
Mary Jane Hynes on September 12, 1886.

H.R.

Known Children of Henry Richard Weatherford
and Emily L. Bishop

Travis J. -- Was born March 7, 1858. Died as a young
child.

Mary Amanda -- Was born January 30, 1860.

William Henry -- Was born April 19, 1862. Died
August 20, 1955. Married Julia E. Moore.

Richard L. -- Was born August 5, 1864. Was killed in
accident at age of 16.

Perry M. -- Was born June 22, 1866. Apparently died as
an infant. The only record is an entry in the family
Bible.

Cornelius -- Was born May 2, 1868. Was twin brother of
Cornelia.

Cornelia -- Was born May 2, 1868. Was a twin sister of
Cornelius. Married a Mr. DeWesse.

Francis -- Was born in 1871. Married Lee Herrington.

Andrew -- Was born in 1874. Married Gertrude Kirby.

Allen -- Was born in 1876. Was a twin brother of Anna.

Anna -- Was born in 1876. Was a twin sister of Allen.
Married Abraham Kilgore.

Mattie -- Was born in 1879. Married Frank Casels.

Albert Sidney -- Was born in 1883. Married Ella Sistrunk.

Known Children of Francis L. Weatherford
and Columbus C. Trawick

Warren -- Was born in 1857. Was married to a lady whose first name was Sophronia.

Frances E. -- Was born in 1861.

Sarah L. -- Was born in 1864.

Mandy -- Was born in 1865. Married a Mr. Buddingfield.

Known Children of Martha Ann Weatherford
and John Washington Kittrell

Francis Lenora -- Was born in 1861 and died in 1864 as a child.

John R. -- Was born in 1864. Married Lillie More.

Attis Dewitt -- Was born in 1869 and died in 1872 as a child.

Lillie -- Was born in 1874. Married George Person.
Could have been twin of Minnie.

Minnie -- Was born in 1874. Married Darrell Valentine.
Could have been twin of Lillie.

Ida Martha -- Was born in 1877 and died in 1877 as a child.

Jones Wilburn -- Was born in 1881 and died in 1895.

Son (name unknown) -- Was born in 1870 and died in 1870.

Known Children of Elizabeth P. Weatherford
and William Madison Hooks

Frances A. -- Was born in 1860.

William Alexander -- Was born in 1861. Married
Ella Revel.

Alameda Annie -- Was born in 1862. Married William J.
White.

Mattie -- Was born in 1868. Married Joe Jolly.

Richard Ive -- Was born in 1870. Married Mary E. Wilson.

Betty -- Was born in 1872. Married H. D. Hassell.

Henry Edward -- Was born in 1874. Married Ida Vincent.

Ida Pearl -- Was born in 1878.

William Madison, Jr. -- Was born in 1881. Married Jewel
Kinard.

Known Children of William Gustavus Weatherford
and Ann Kittrell

George Washington -- Was born August 7, 1869. Married
Nettie Hambrie (the marriage license records spell
it Hambrie while the family Bible spells it Hamrick)
in January 1892. After her death, he married her
sister Maggie Hambrie in 1903.

John Madison -- Was born August 11, 1871, at Daleville,
Lauderdale County, Mississippi. Died August 7, 1939,
at Picayune, Mississippi, and was buried at Palestine
Cemetery near Picayune. Was married three times:

(1) Elena Isadora Reese who was born in Western Port,
Louisiana, and died on August 7, 1901, in Nox,
Texas, and gave birth to five children;

(2) Lou Kelley, who gave birth to ~~one~~ ^{two} children
Wayne Hill

(3) Susan Prine Daughrill.

Marriage records of Lauderdale County, Mississippi,
show that a license was issued to J. M. Weatherford
and Ella Currie in 1903 but no information has been
found to indicate that the license was the same as
John Madison. *died very old buried in Palestine, Tex.*

Francis -- Was born in 1871. Married Lee Herrington.

Andrew -- Was born in 1874. Married Gertrude Kirby.

Allen -- Was born in 1876. Was a twin brother of Anna

Anna -- Was born in 1876. Was a twin sister of Allen.
Married Abraham Kilgore.

Mattie -- Was born in 1879. Married Frank Cassels.

Albert Sidney -- Was born in 1883. Married Ella Siskink.

Known Children of Francis L. Weatherford
and Columbus C. Trawick

Warren -- Was born in 1857. Was married to a lady whose
first name was Sophronia.

Frances E. -- Was born in 1861.

Sarah L. -- Was born in 1864.

Mandy -- Was born in 1865. Married a Mr. Buddingsfield

Known Children of Martha Ann Weatherford
and John Washington Kittrell

Francis Lenora -- Was born in 1861 and died in 1864
as a child.

John R. -- Was born in 1864. Married Lillie Moore.

Attis Dewitt -- Was born in 1859 and died in 1872 as a
child.

Lillie -- Was born in 1874. Married George Pearson.
Could have been twin of Minnie.

Minnie -- Was born in 1874. Married Darrell Valentine.
Could have been twin of Lillie.

Ida Martha -- Was born in 1877 and died in 1879 as a
child.

Jones Wilburn -- Was born in 1881 and died in 1895.

Son (name unknown) -- Was born in 1870 and died in 1871

Charley M. -- Was born November 30, 1873. Was issued marriage license to marry E. E. Richardson in 1898 and a license to marry Vona Hudson in 1908.

Columbus G. -- Was born September 2, 1875.

*married Mally
Armstrong*

Elbert R. -- Was born November 29, 1878.

Known Children of William Gustavus Weatherford
and Mary Janes Hynes

Sidney Edward Lee -- Born June 19, 1889, at Pine Springs, Lauderdale County, Mississippi. Died November 12, 1975, at Hattiesburg, Mississippi, and was buried at Roseland Park Cemetery in Hattiesburg. Married Lela Estelle Cagle of Sumrall, Lamar County, Mississippi, on August 23, 1927. Four children were born to this union.

Oliver Gladstone -- Born in 1891 at Pine Springs, Mississippi, and died in 1942 in Hattiesburg, Mississippi. Buried in Cemetery of Sunrise Baptist Church near Hattiesburg.

Richard Jones -- Born January 20, 1893, at Pine Springs, Mississippi, and died January 11, 1937, in Birmingham, Alabama. Buried in Cemetery of Sunrise Baptist Church near Hattiesburg, Mississippi. Married Letha _____



John Washington Kittell and
Martha Ann Weatherford Kittell
Parents of John Robert Kittell



OTTO B. GIRRS.

NASHVILLE, TENN.

*John Robert Kittell
in Medical School.*



Lillie Kirtrell - Pearson
two daughters of J W + MA Kirtrell



CENTRAL ART GALLERY,

Brookshire, Matthews & Co.,

Meridian, Miss.

Minnie Kittuel - Valentine
two daughters - J W + M A Kittuel

J W served as bondsman for both Callie who
 md H C Sturge on 5/28/1868 and Ann who md
 W H on 5/20/1868

Took another look at 1860 Census for a possible lead
 Census dated 6/22/1860.

The L D Clanton in whose household Jane Kettrell was
 appears to have been well to do \$5,000 per year. He lived
 around Landville Station which is not far from Lockhart
 and Hedberg Grove

746-725	R Weatherford	58	\$3,000	L Ga.
No daughters in the household in 1860	Lucinda A	45	" "	
	Martha A	21		L MS - md J W
	William H	13	(19 in 1866)	

Well if it was a Weatherford who was father of J R then it
 most likely was W. H.

In 1860 H. R. 25 L al \$320⁰⁰ - 375⁰⁰ was in Boat 5
 P.O. Whymet at

1435-1411	Emily L	23	L MS
Twins	Travis J	2	" "
	May A	2	" "

Let's see in 1865

Margaret was	24	W H 18 = 6 yrs older
Rose (y alive)	22	" "
Elyzeth (Ann)	19	
Amenda	18	
Callie	17	

The point is that Ann + W H would have been about the
 same age if I have it correct. One could say Amenda the
 same age

Let's figure for a minute, there are two possibilities

Enter on. Chart

Richard Weatherford
was ordained to Holy
orders -

Sabbath Day

October 11th 1857

Bethlehem Association

Nathaniel Kitell was a
delegate to the meeting
from the Hickory
grove Church -

A Bt more

12/6/85-

Kitrell

In recleaning 1850 Census for Lauderdale Co MS on another case I noticed the following - of which I had not seen before:

38-39

MILFORD KITROLL 32 Farmer + SC (1818) in the household; John W Parker 40 Farmer. This was close to Nathaniel and John -
Believe this to be Milford

Lawrence Co MS Census (South MS)

162-162

Weatherford	71	50	Farmer	\$400	750
Nancy	40				+ MS
William	21				" "
Arney	18				" "
John	16				" "
James	14				" "
Zilphee	12		Female		" "
MALICEAN	7		Male		" "
Jonathan	5				" "
Mahoon	1				" "

1860 Census Lauderdale Co MS

776-755

Kitrell C 17 Farm Laborer + MS in household
of W F Redford

Sincerely
J